

langgir
Rotary switch

Langir a professional design, manufacturer of Anti vandal switch, Piezo switch, Capacitive switch and Circuit Protection.
www.langir.com

CONTENTS

01 LW26 Series Rotary Switch 	42 KDHc Series Electric Welding Machinery Switch 	49 LW2D Series Rotary Switch 	59 LWX1 LWX1B Series Rotary Switch 
24 LW26GS Series Pad-lock Type Switch 	43 KDHs Series Electric Welding Machinery Switch 	50 LW5D Series Rotary Switch 	60 HZ5D Series Combination Switch 
26 LW26S Series Key-lock Type Switch 	44 KDH Series Electric Welding Machinery Switch 	51 LW6D Series Rotary Switch 	62 HZ5B Series Combination Switch 
29 LW30 Series Rotary Switch 	45 HZ10D-□/E119 Series Electric Welding Machinery Switch 	52 LW8D Series Rotary Switch 	63 HZ10D Series Combination Switch 
38 LW31 Series Rotary Switch 	46 HJ-75/100 Series Adapter 	53 LW12 Series Rotary Switch 	64 HZ12 Series Combination Switch 
39 LW31B Series Rotary Switch 	47 Input Joint Box Series 	57 LW15 Series Rotary Switch 	67 HZ25D Series Combination Switch 
41 LW40 Series Rotary Switch 	48 Output Terminal Block 	58 LW26D Series Rotary Switch 	69 Flame-Proof Switch 

LW26 Series Rotary Switch

Product Introduction

The LW26 series rotary switch mainly applies to 440V and below, AC 50Hz or 240V and below DC circuits. For breaking and closing, change-over of circuits under unfrequently manual operation. And the typical application are: control switch of 3 phase motors, control switch of switch gear, control switch of instruments, and change-over switch of machinery and welding machine.

The series comply with the GB 14048.3, GB 14048.5 and IEC 60947-3, IEC 60947-5-1.

The Lw26 series have 8 current ratings: 10A, 20A, 25A, 32A, 63A, 125A, 160A and 315A. They were designed for multiple functions, wide variety of applications.

The LW26-10, LW26-20, LW26-25 and LW26-32F have finger protection terminals.

LW26 series rotary switch are an excellent substitute for LW2, LW5, LW6, LW8, LW12, LW15, HZ5, HZ10 and HZ12.

The Lw26 series rotary switch has two derivatives, LW26GS Pad-lock type and LW26S Key-lock type.

Both of them are applicable in circuits when an physical control is required.

We can equip protective box(IP65) for 20A to 160A.

LW26-10



LW26-20



LW26-20X



LW26-25



LW26-32



LW26-63

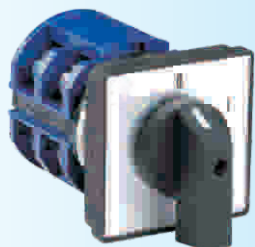

Working conditions

- (1) Ambient temperature DO NOT exceed 40°C, and the average temperature, measured over a period of 24 hours, DO NOT exceed 35°C.
- (2) Ambient temperature should not be below -25°C
- (3) Should not be installed above 2000m above sea level.
- (4) The humidity should not exceed 50% when the ambient temperature is 40°C and higher humidity is allowed for lower temperature.

Installation conditions

- (1) A clean environment is required
- (2) Please follow our manual

LW26 Series Rotary Switch

Type and meaning of products

LW26-10X



LW26-32F



LW26-20c



LW26-125



LW26-160



LW26-315

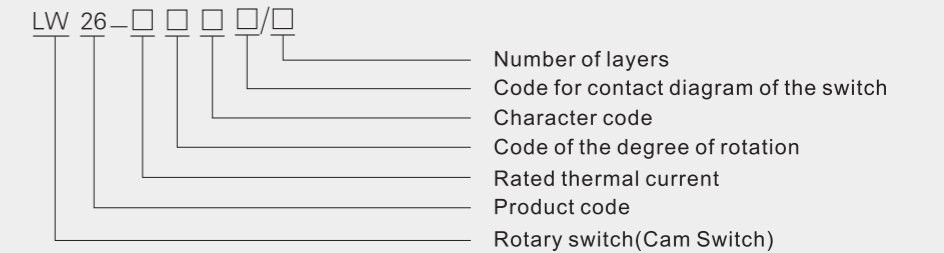
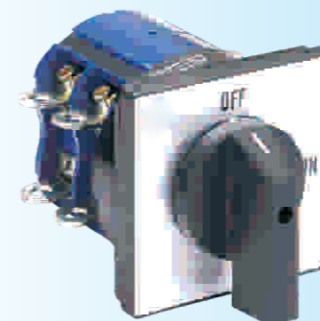

Re: Code of the degree of rotation, 30° (3) ; 45° (4) ; 60° (6) ; 90° (9) ; 30° spring return 60° limited (36) ; 30° spring return 90° limited (39)

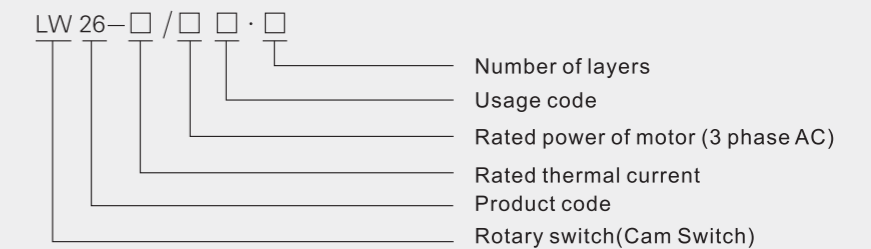

Re1: Usage code: (1) Q1 for start and run (2) N for start and reversing (3) S start and run for 2 speed (4) SN for start and reversing of 2 speed motor (5) M16 for start and reversing of 3 speed motor

Re2: Usage code: switches in this category normally rotated at 60° . And the SN normally rotated at 45° .

Use as control switches for a main circuit

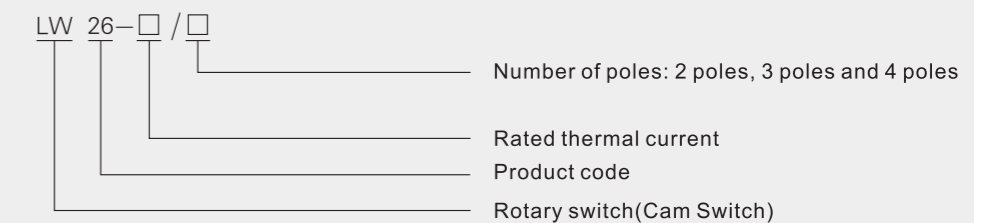

Re: Switches in this category normally rotated at 60° or 90° .

Classification

1. By Utilization	2. By operation	3. By contact system
(1) Change-over switch (2) Motor switch (3) Control switch	(1) Limited movement (2) Spring return (3) Limited movement with spring return	(1) Switches with limited movement could have 12 layers in max(for 32A and below), and for 63A and above could have 8 layers in max. (2) Switches with spring return could have 3 layers in max. (3) Motor switches could have 6 layers in max.

4 Diagram for the operation and position of handle

Operating Mode	Code	Position of handle			
		M0	M1	M2	M4
Spring return	A	0°-30°	0°-45°	0°-60°	0°-90°
	B	30°-0°-30°	45°-0°-45°	60°-0°-60°	90°-0°-90°
	X	60°-30°-0°-30°-60°	90°-45°-0°-45°-90°		
	Y	90°-60°-30°-0°-30°-60°-90°			
Limited movement	C	0° 30°	0° 45°	0° 60°	
	D	30° 0° 30°	45° 0° 45°	60° 0° 60°	
	E	30° 0° 30° 60°	45° 0° 45° 90°	60° 0° 60° 120°	
	F	60° 30° 0° 30° 60°	90° 45° 0° 45° 90°	60° 0° 60° 120° 180°	
	G	60° 30° 0° 30° 60° 90°	90° 45° 0° 45° 90° 135°	120° 60° 0° 60° 120° 180°	
	H	90° 60° 30° 0° 30° 60° 90°	135° 90° 45° 0° 45° 90° 135°		
	I	90° 60° 30° 0° 30° 60° 90° 120°	135° 90° 45° 0° 45° 90° 135° 180°		
	J	120° 90° 60° 30° 0° 30° 60° 90° 120°			
	K	120° 90° 60° 30° 0° 30° 60° 90° 120° 150°			
	L	150° 120° 90° 60° 30° 0° 30° 60° 90° 120° 150°			
	M	150° 120° 90° 60° 30° 0° 30° 60° 90° 120° 150° 180°			
	N		45° 45°	30° 30°	
	P				90° 0° 90°
	T				0° 90°
	V				90° 0°
	R				270° 0° 90° 180°
Limited movement with spring return	Q	30° 0°-30°	45° 0°-45°		
	S	30°-0° 60°	90° 0°-45°		
	W		90°-45° 0° 45°-90°		
	Z	120°-90° 0°-30°	135°-90° 0°-45°		

Specification of Plate

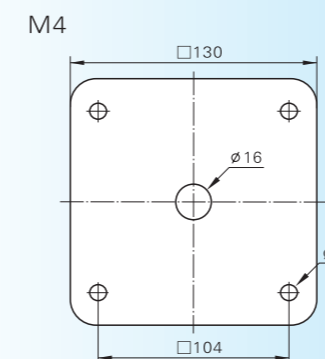
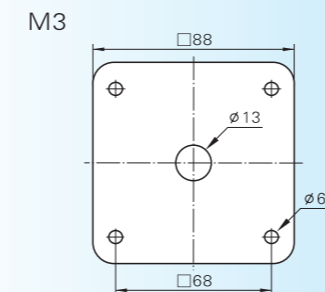
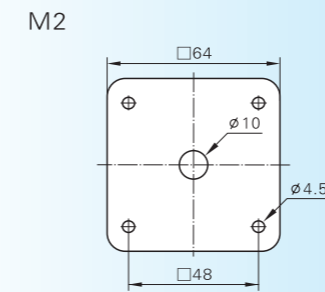
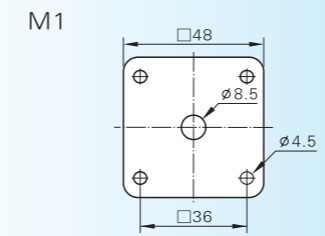
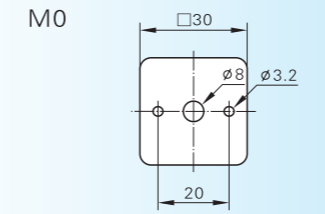

Type of Handle

Type	Color	Specification of Plate					Type	Color	Specification of Plate				
		M0	M1	M2	M3	M4			M0	M1	M2	M3	M4
R type	Black	●	●	●			I type	Black	●	●	●	●	●
	Red		●	●				Red	●	●			
	White							White					
	Grey							Grey					
R2 type	Black	●	●				B type	Black	●	●			
	Red							Red	●				
	White							White		●			
F type	Black	●	●	●			L type	Black			●		
	Red							Red					
	White							White					
H type	Black			●			O type	Black			●		
	Red							Red					
	White							White					
P type	Black			●	●	●	K type	Black			●	●	
	Red							Red					
	White							White					
	Black							Black					
	Red							Red					
	Grey							Grey					

Re: ● Standard ● Optional

Description	Specification of Plate				Type of Handle								Rotating Angle				Max Layer										
	M0	M1	M1B	M2	M2B	M3	M4	R	R2	F	I	B	H	L	O	P	K	30°	45°	60°	90°	12	10	8	6		
LW26-10	●								●	●								●	●	●	●					●	
LW26-10X	●								●	●								●	●	●	●					●	
LW26-20	●	●	●	●	●	●	●	●	●	●	●	●	●	●	●	●	●	●	●	●	●	●	●	●	●	●	●
LW26-20X	●	●	●	●	●	●	●	●	●	●	●	●	●	●	●	●	●	●	●	●	●	●	●	●	●	●	●
LW26-20c				●	●	●	●	●	●	●	●	●	●	●	●	●	●	●	●	●	●	●	●	●	●	●	●
LW26-25	●	●	●	●	●	●	●	●	●	●	●	●	●	●	●	●	●	●	●	●	●	●	●	●	●	●	●
LW26-32				●	●	●	●	●	●	●	●	●	●	●	●	●	●	●	●	●	●	●	●	●	●	●	●
LW26-32F				●	●	●	●	●	●	●	●	●	●	●	●	●	●	●	●	●	●	●	●	●	●	●	●
LW26-63				●	●	●	●	●	●	●	●	●	●	●	●	●	●	●	●	●	●	●	●	●	●	●	●
LW26-125						●										●	●	●	●	●	●	●	●	●	●	●	●
LW26-160							●									●	●	●	●	●	●	●	●	●	●	●	●
LW26-315								●								●	●	●	●	●	●	●	●	●	●	●	●

Re: M1B, M2B plates should be installed by self tapping screw.

Technical parameters

Description	LW26-10 LW26-10X	LW26-20 LW26-20X	LW26-25	LW26-32 LW26-32F	LW26-63	LW26-125	LW26-160	LW26-315
Rated insulation voltage U_i V	660	660	660	660	660	660	660	660
Rated thermal current I_{th} A	10	20	25	32	63	125	160	315
Rated working voltage U_e V	240 440	24 110 240 440	24 110 240 440	240 440	240 440	240 440	240 440	240 440
Rated working current I_e A								
AC-21A AC-22A A	10 10	20 20	25 25	32 32	63 63	100 100	150 150	315 315
AC-23A A	7.5 7.5	15 15	22 22	30 30	57 57	90 90	135 135	265 265
AC-2 A	7.5 7.5	15 15	22 22	30 30	57 57	90 90	135 135	265 265
AC-3 A	5.5 5.5	11 11	15 15	22 22	36 36	75 75	95 95	110 110
AC-4 A	1.75 1.75	3.5 3.5	6.5 6.5	11 11	15 15	30 30	55 55	95 95
AC-15 A	2.5 1.5	5 4	8 5	14 6				
DC-13 A		12 0.4 0.4	20 0.5 0.5					
Power P								
AC-23A KW	1.8 3	3.7/2.5 7.5/3.7	5.5/3 11/5.5	7.5/4 15/7.5	15/10 30/18.5	30/15 45/22	37/22 75/37	75/37 132/55
AC-2 KW	2.5 3.7	4 7.5	5.5 11	7.5 15	18.5 30	30 45	37 55	55 95
AC-3 KW	1.5 2.2	3/2.2 5.5/3	4/3 7.5/3.7	5.5/4 11/5.5	11/6 18.5/11	15/7.5 30/13	22/11 37/18.5	37/22 55/30
AC-4 KW	0.37 0.55	0.55/0.75 1.5/1.5	1.5/1.1 3/2.2	2.7/1.5 5.5/3	5.5/2.4 7.5/4	6/3 12/5.5	10/4 15/7.5	15/7.5 25/11

Re1: Neutral

Re2: The power under: AC-23A, AC-3, AC-4 are in three phase three poles, and the denominator represents the power under single phase two poles.

Mechanical life

Mechanical life without load: 0.1×10^6 times, operation frequency is 120 times/h

Mechanical life with load: 0.03×10^6 times operation frequency is 120 times/h

Order procedure

When placing an order please specify the contact diagram of the product you require. The Lw26 Series rotary switch have the similar contact diagram as the other rotary switches like LW2D, LW5D, LW6D, LW8D, LW12, LW15, HZ5D and HZ25D. Our factory have published <The General Contact Diagram for Cansen Rotary Switches> Which will help you to specify the contact diagram.

In addition, please specify the current rating, mounting plate, handle type, color and quantity as well.

For instance:

When ordering 20A, rotary angle 60° , character code C, contact diagram code 5391, M1 plate, black R handle 20 unites. The order can be: LW26-20 • 6C5391/2 A11R (M1 R) 20units.

Due to the update of the technologies, we reserve the righting of updating the catalogue without further notices.

Dimensions and installation

Square escutcheon plate and rectangular escutcheon plate

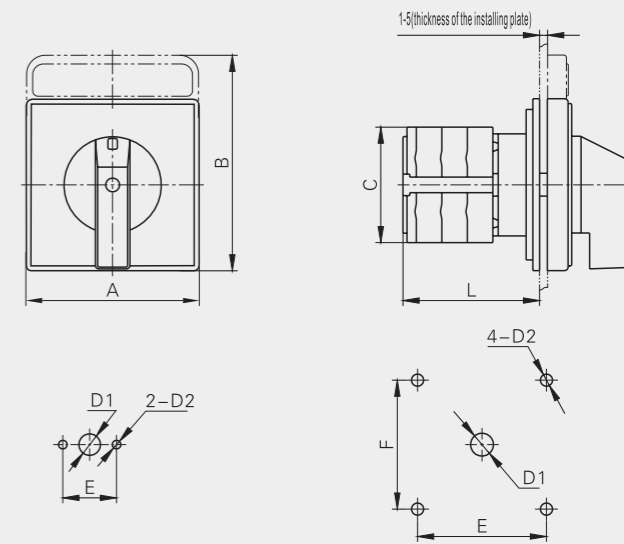

LW26-10 Installation

LW26-20~315 Installation

Description	Escutcheon plate	Dimensions (mm)				Installation (mm)			
		A	B	C	L	E	F	D1	D2
LW26-10	M0 square	30	30	28	22+8n	20		∅ 8	∅ 3.2
LW26-10X	M0 square	30	30	28	26.5+12n	20		∅ 8	∅ 3.2
LW26-20	M1 square	48	48	43	22+9.6n	36	36	∅ 8.5	∅ 4.5
	M1 rectangular	48	60	43	22+9.6n	36	36	∅ 8.5	∅ 4.5
	M2 square	64	64	43	25+9.6n	48	48	∅ 10	∅ 4.5
LW26-20c	M2 rectangular	64	80	43	25+9.6n	48	48	∅ 10	∅ 4.5
	M2 square	64	64	60	42.5+12.6n	48	48	∅ 10	∅ 4.5
	M3 square	88	88	60	42.5+12.6n	68	68	∅ 13	∅ 6
LW26-20X	M1 square	48	48	42	29+14n	36	36	∅ 8.5	∅ 4.5
	M1 rectangular	48	60	42	30+14n	36	36	∅ 8.5	∅ 4.5
	M2 square	64	64	42	30+14n	48	48	∅ 10	∅ 4.5
LW26-25	M1 square	48	48	45.2	23+12.8n	36	36	∅ 8.5	∅ 4.5
	M1 rectangular	48	60	45.2	23+12.8n	36	36	∅ 8.5	∅ 4.5
	M2 square	64	64	45.2	26.5+12.8n	48	48	∅ 10	∅ 4.5
LW26-32	M2 rectangular	64	80	45.2	26.5+12.8n	48	48	∅ 10	∅ 4.5
	M2 square	64	64	58	29.2+12.8n	48	48	∅ 10	∅ 4.5
	M3 square	88	88	58	29.2+12.8n	68	68	∅ 13	∅ 6
LW26-32F	M2 rectangular	64	80	58	29.2+12.8n	48	48	∅ 10	∅ 4.5
	M2 square	64	64	48	24.5+14n	48	48	∅ 10	∅ 4.5
	M2 rectangular	64	80	48	24.5+14n	48	48	∅ 10	∅ 4.5
LW26-63	M2 square	64	64	66	29.2+21.5n	48	48	∅ 10	∅ 4.5
	M2 rectangular	64	80	66	29.2+21.5n	48	48	∅ 10	∅ 4.5
	M3 square	88	88	66	29.2+21.5n	68	68	∅ 13	∅ 6
LW26-125	M3 square	88	88	84	35+26.5n	68	68	∅ 13	∅ 6
LW26-160	M3 square	88	88	88	35+32.5n	68	68	∅ 13	∅ 6
LW26-315	M4 square	130	130	126	39.5+38.5n	104	104	∅ 16	∅ 7

Re: n for number of layers

LW26 Series Rotary Switch

Special type and optional extras

Single hole installation(C55)

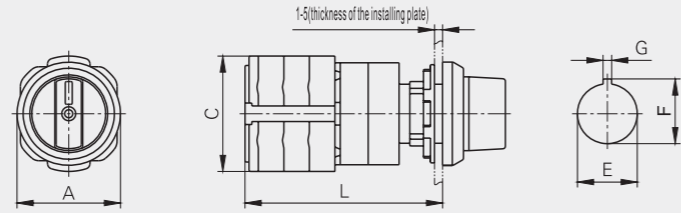

Description	Dimensions (mm)			Installation (mm)			Type of handle		
	A	C	L	E	F	G	I	B	F
LW26-10	∅ 29	28	35+8n	∅ 16.2	18	1.9	●		●
LW26-10X	∅ 29	28	39+12n	∅ 16.2	18	1.9	●		●
LW26-20	∅ 39	43	42+9.6n	∅ 22.3	24.1	3.2	●	●	●
LW26-20	∅ 39	43	42+9.6n	∅ 30.5	33	4.8	●	●	●
LW26-20X	∅ 39	42	50+14n	∅ 22.3	24.1	3.2	●	●	●
LW26-20X	∅ 39	42	50+14n	∅ 30.5	33	4.8	●	●	●
LW26-25	∅ 39	45.2	42+12.8n	∅ 22.3	24.1	3.2	●	●	●
LW26-25	∅ 39	45.2	42+12.8n	∅ 30.5	33	4.8	●	●	●
LW26-32F	∅ 39	48	42+14n	∅ 22.3	24.1	3.2	●	●	●
LW26-32F	∅ 39	48	42+14n	∅ 30.5	33	4.8	●	●	●

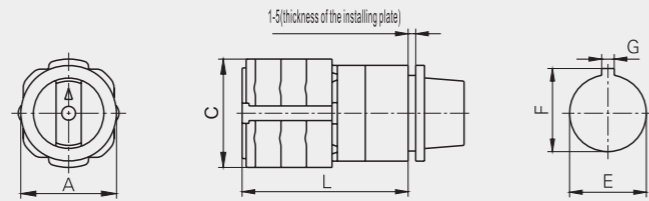

Description	Dimensions (mm)			Installation (mm)		
	A	C	L	E	F	G
LW26-20	∅ 39	43	35+9.6n	∅ 30.5	33	4.8
LW26-20X	∅ 39	42	42+14n	∅ 30.5	33	4.8
LW26-25	∅ 39	45.2	35+12.8n	∅ 30.5	33	4.8
LW26-32F	∅ 39	48	35+14n	∅ 30.5	33	4.8
LW26-32F	∅ 39	48	43+14n	∅ 30.5	33	4.8

Single hole installation with plate(C51)

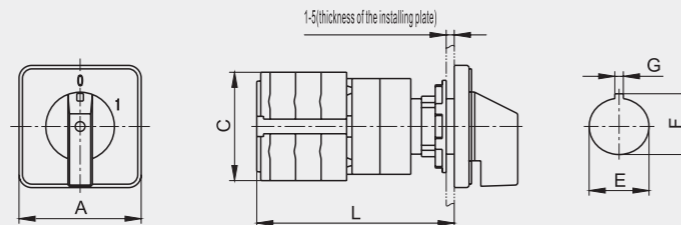

Description	Escutcheon plate	Dimensions (mm)			Installation (mm)			Type of handle		
		A	C	L	E	F	G	I	B	F
LW26-10	M0 square	□30	28	35+8n	∅ 16.2	18	1.9	●		●
LW26-10X	M0 square	□30	28	39+12n	∅ 16.2	18	1.9	●		●
LW26-20	M1 square	□48	43	42+9.6n	∅ 22.3	24.1	3.2	●	●	●
LW26-20	M1 square	□48	43	42+9.6n	∅ 30.5	33	4.8	●	●	●
LW26-20X	M1 square	□48	48	50+14n	∅ 22.3	24.1	3.2	●	●	●
LW26-20X	M1 square	□48	48	50+14n	∅ 30.5	33	4.8	●	●	●
LW26-25	M1 square	□48	45.2	42+12.8n	∅ 22.3	24.1	3.2	●	●	●
LW26-25	M1 square	□48	45.2	42+12.8n	∅ 30.5	33	4.8	●	●	●
LW26-32F	M1 square	□48	48	42+14n	∅ 22.3	24.1	3.2	●	●	●
LW26-32F	M1 square	□48	48	42+14n	∅ 30.5	33	4.8	●	●	●

LW26 Series Rotary Switch

Special type and optional extras

Double hole installation(G85)

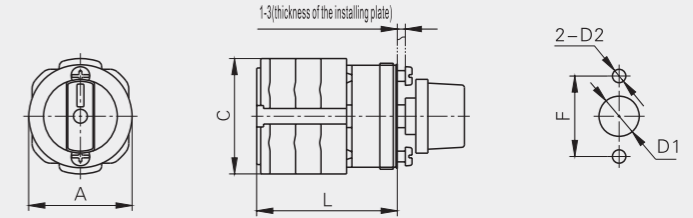

Description	Dimensions (mm)			Installation (mm)		
	A	C	L	F	D1	D2
LW26-20	39	43	24+9.6n	30	∅ 15	∅ 5
LW26-20X	39	42	32+14n	30	∅ 15	∅ 5
LW26-25	39	45.2	25+12.8n	30	∅ 15	∅ 5
LW26-32F	39	48	25+14n	30	∅ 15	∅ 5

Embedded nut installation

Re: Buyer should mention the installation needed

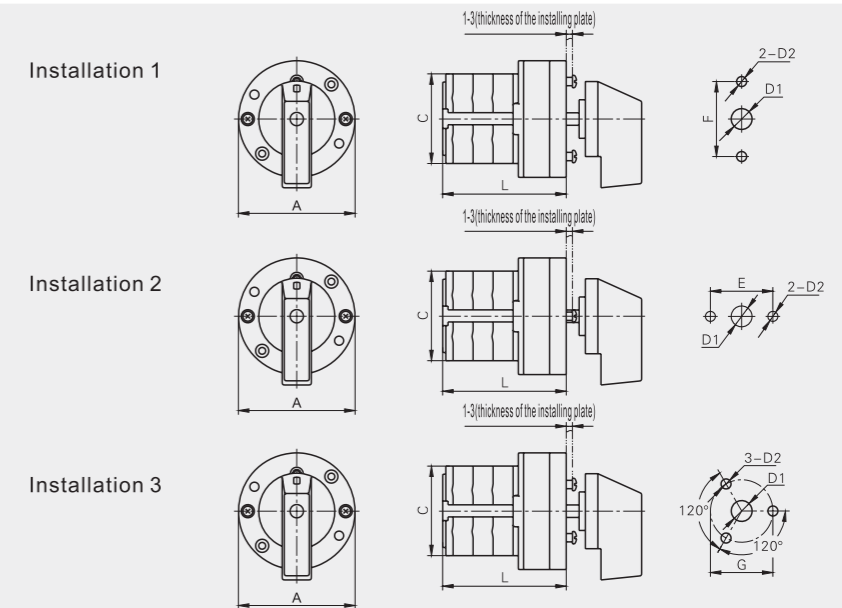

Description	Dimensions (mm)			Installation (mm)				
	A	C	L	E	F	G	D1	D2
LW26-20	∅56	43	31+9.6n	30	36	∅ 30	∅ 10	∅ 4.5
LW26-20c	∅60	60	30+12.6n	30	36	∅ 30	∅ 10	∅ 4.5
LW26-20X	∅56	66	39+14n	30	36	∅ 30	∅ 10	∅ 4.5
LW26-25	∅56	45.2	32+12.8n	30	36	∅ 30	∅ 10	∅ 4.5
LW26-32	∅56	58	30+12.8n	30	36	∅ 30	∅ 10	∅ 4.5
LW26-32F	∅56	48	32+14n	30	36	∅ 30	∅ 10	∅ 4.5
LW26-63	∅56	66	30+21.5n	30	36	∅ 30	∅ 10	∅ 4.5

63A binding screw



Cross-section of conductor 6mm² ~16mm²

Type 1: Screw for hard wire



Specification of screw: M6

Type 2: Screw for terminal block



Cross-section of conductor 6mm² ~16mm²

Type 3: Screw for soft wire

LW26 Series Rotary Switch

Special type and optional extras

Double hole installation with distance can be fine-adjustment(L82)

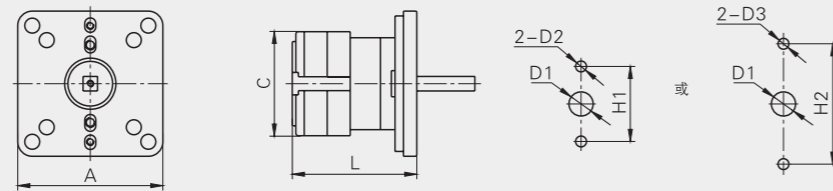

Description	Dimensions (mm)			Installation (mm)				
	A	C	L	H1	H2	D1	D2	D3
LW26-20	□60	43	26+9.6n	30~36	47~50	∅10	∅3.5	∅4.5
LW26-20c	□60	60	31+12.6n	30~36	47~50	∅10	∅3.5	∅4.5
LW26-20X	□60	66	34+14n	30~36	47~50	∅10	∅3.5	∅4.5
LW26-25	□60	45.2	27+12.8n	30~36	47~50	∅10	∅3.5	∅4.5
LW26-32F	□60	48	27+14n	30~36	47~50	∅10	∅3.5	∅4.5
LW26-32	□60	58	31+12.8n	30~36	47~50	∅10	∅3.5	∅4.5
LW26-63	□60	66	31+21.5n	30~36	47~50	∅10	∅3.5	∅4.5

DIN-rail installation(D11)

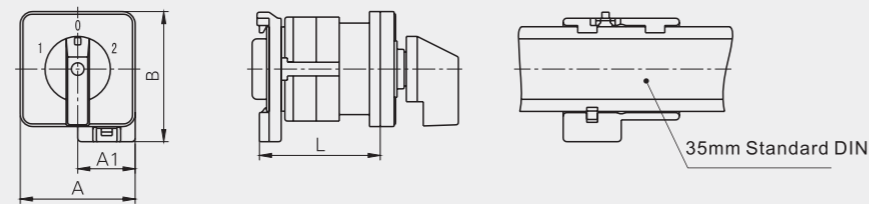

Description	Dimensions (mm)				Installation (mm)
	A	A1	B	L	
LW26-20	□48	24	54	31+9.6n	35mm
LW26-20X	□48	24	54	31+14n	35mm
LW26-25	□48	24	54	32+12.8n	35mm
LW26-32F	□48	24	54	32+14n	35mm
LW26-32	□64	35	60	40+12.8n	35mm
LW26-63	□64	35	60	40+21.5n	35mm
LW26-125	□88	35	60	51+26.5n	35mm
LW26-160	□88	35	60	51+32.5n	35mm

Base installation(B11)

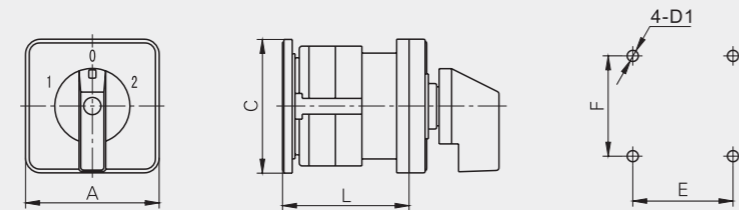

Description	Dimensions (mm)			Installation (mm)		
	A	C	L	E	F	D1
LW26-20	□48	48	26.5+9.6n	36	36	∅4.5
LW26-20c	□64	64	35+12.6n	48	48	∅4.5
LW26-20X	□48	48	34.5+14n	36	36	∅4.5
LW26-25	□48	48	27.5+12.8n	36	36	∅4.5
LW26-32	□64	64	33+12.8n	48	48	∅4.5
LW26-32F	□48	64	27.5+14n	48	48	∅4.5
LW26-63	□64	64	33+21.5n	48	48	∅4.5
LW26-125	□88	88	42+26.5n	64	64	∅6
LW26-160	□88	88	42+32n	64	64	∅6

LW26 Series Rotary Switch

Special type and optional extras

Q type(A11)

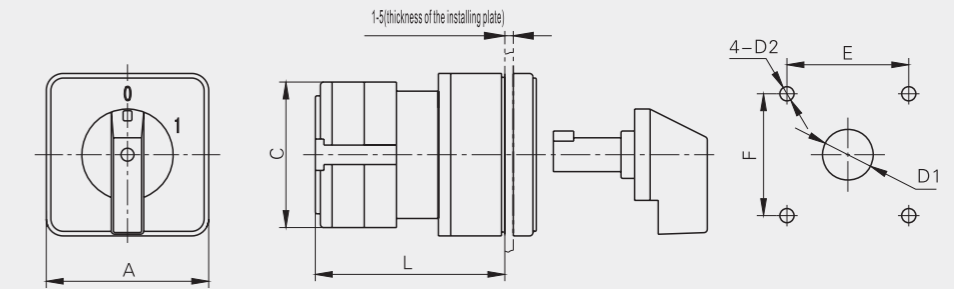
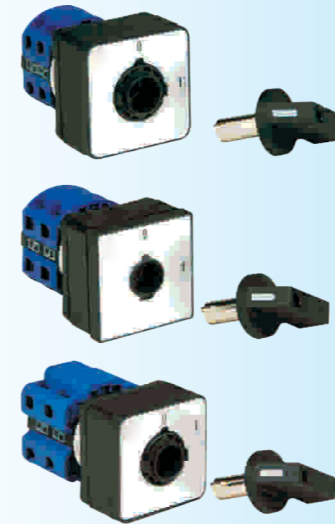

Description	Escutcheon plate	Dimensions (mm)			Installation (mm)			
		A	C	L	E	F	D1	D2
LW26-20	M1 square	48	43	38+9.6n	36	36	∅15	∅4.2
LW26-20X	M1 square	48	42	46+14n	36	36	∅15	∅4.2
LW26-25	M1 square	48	45.2	39+12.8n	36	36	∅15	∅4.2
LW26-32F	M1 square	48	48	39+14n	36	36	∅15	∅4.2

Indicating light(A66)

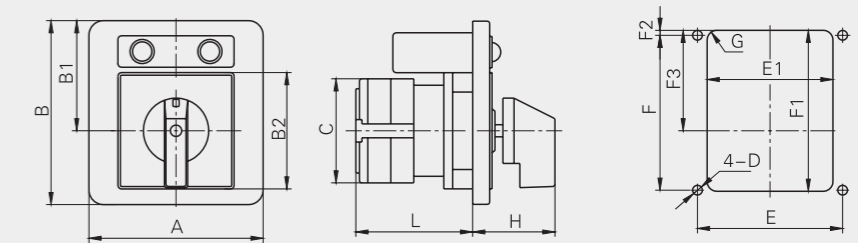

Description	Dimensions (mm)							Installation (mm)							
	A	B	B1	B2	C	L	H	E	E1	F	F1	F2	F3	D	G
LW26-20	72	76	45.5	48	43	26+9.6n	34max	60	52	64	66.5	2	41.5	∅4	R4
LW26-20X	72	76	45.5	48	42	34+14n	34max	60	52	64	66.5	2	41.5	∅4	R4
LW26-25	72	76	45.5	48	45.2	26+12.8n	34max	60	52	64	66.5	2	41.5	∅4	R4
LW26-32F	72	76	45.5	48	48	26+14n	34max	60	52	64	66.5	2	41.5	∅4	R4

Indicating light with keylock(A66S1)

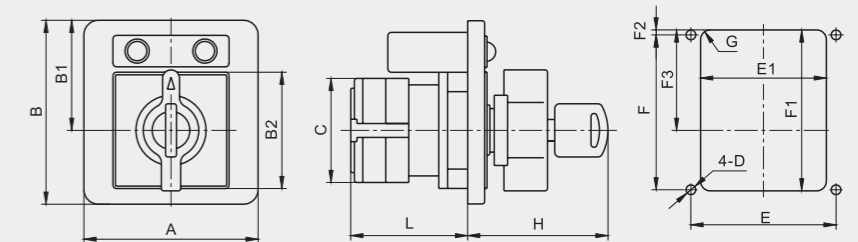

Description	Dimensions (mm)							Installation (mm)							
	A	B	B1	B2	C	L	H	E	E1	F	F1	F2	F3	D	G
LW26-20	72	76	45.5	48	43	26+9.6n	58max	60	52	64	66.5	2	41.5	∅4	R4
LW26-20X	72	76	45.5	48	42	34+14n	58max	60	52	64	66.5	2	41.5	∅4	R4
LW26-25	72	76	45.5	48	45.2	26+12.8n	58max	60	52	64	66.5	2	41.5	∅4	R4
LW26-32F	72	76	45.5	48	48	26+14n	58max	60	52	64	66.5	2	41.5	∅4	R4

LW26 Series Rotary Switch

Special type and optional extras

Quick Switch(A1113)

Quick Switch will store up energy by quick conversion mechanism, it will realize the quick conversion when energise flashily. The process is unacted on the operation of the personal, fast, stable and reliable, good for load circuit and direct-current circuit. The convert angle can be 60° or 90° .



Installation 1(A1113)

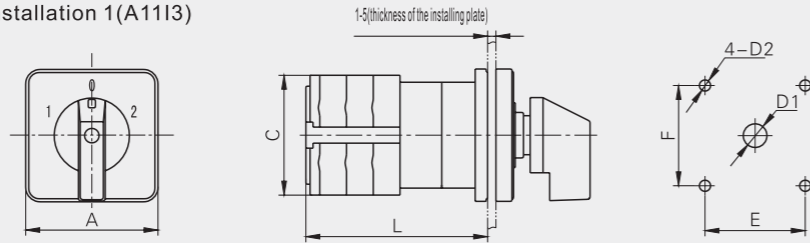

Description	Escutcheon plate	Dimensions (mm)			Installation (mm)			
		A	C	L	E	F	D1	D2
LW26-20	M1 square	48	43	37+9.6n	36	36	∅ 8.5	∅ 4.5
LW26-20	M2 square	64	43	38+9.6n	48	48	∅ 10	∅ 4.5
LW26-20X	M1 square	48	42	45+14n	36	36	∅ 8.5	∅ 4.5
LW26-20X	M2 square	64	42	46+14n	48	48	∅ 10	∅ 4.5
LW26-25	M1 square	48	45.2	38+12.8n	36	36	∅ 8.5	∅ 4.5
LW26-25	M2 square	64	45.2	39+12.8n	48	48	∅ 10	∅ 4.5
LW26-32F	M1 square	48	48	38+14n	36	36	∅ 8.5	∅ 4.5
LW26-32F	M2 square	64	48	39+14n	48	48	∅ 10	∅ 4.5

Installation 2(G8513)

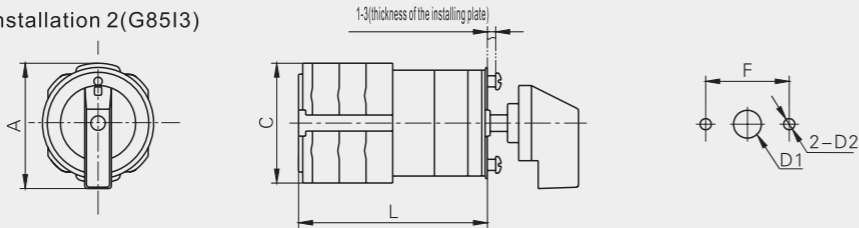

Description	Dimensions (mm)			Installation (mm)		
	A	C	L	F	D1	D2
LW26-20	45	43	39+9.6n	30	∅ 10	∅ 4.5
LW26-20X	45	42	47+14n	30	∅ 10	∅ 4.5
LW26-25	46	45.2	31+12.8n	30	∅ 10	∅ 4.5
LW26-32F	48	48	31+14n	30	∅ 10	∅ 4.5

LS Type(A12LS)

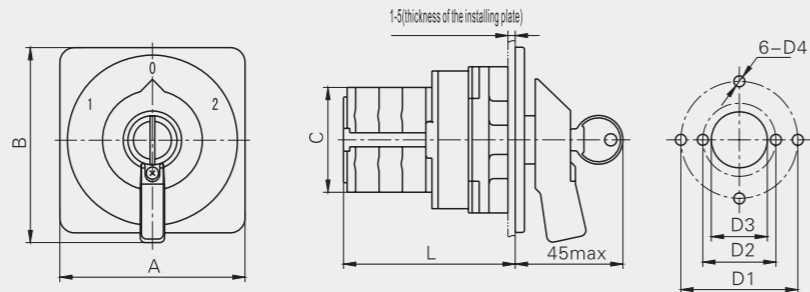

Description	Dimensions (mm)				Installation (mm)			
	A	B	C	L	D1	D2	D3	D4
LW26-20	76	80	43	31+9.6n	∅ 48	∅ 30	∅ 23	∅ 4.5
LW26-20X	76	80	42	39+14n	∅ 48	∅ 30	∅ 23	∅ 4.5
LW26-25	76	80	45.2	32+12.8n	∅ 48	∅ 30	∅ 23	∅ 4.5
LW26-32	76	80	58	30+12.8n	∅ 48	∅ 30	∅ 23	∅ 4.5
LW26-32F	76	80	48	32+14n	∅ 48	∅ 30	∅ 23	∅ 4.5
LW26-63	76	80	66	30+21.5n	∅ 48	∅ 30	∅ 23	∅ 4.5

LW26 Series Rotary Switch

Special type and optional extras

Single lock(A11DS)

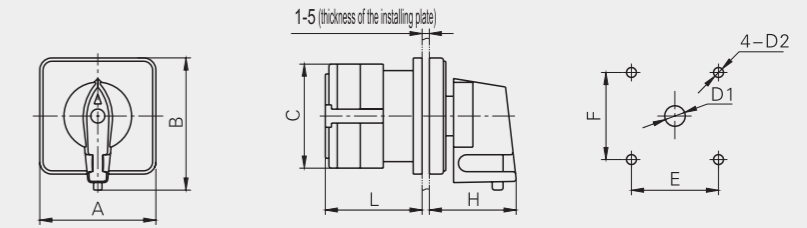
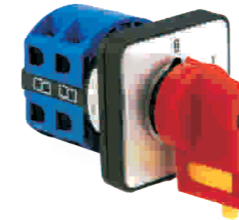

Description	Dimensions (mm)					Installation (mm)			
	A	B	C	L	H	E	F	D1	D2
LW26-20	∅48	55	43	22+9.6n	36max	36	36	∅ 8.5	∅ 4.5
LW26-20X	∅48	55	42	30+14n	36max	36	36	∅ 8.5	∅ 4.5
LW26-25	∅48	55	45.2	25+12.8n	36max	36	36	∅ 8.5	∅ 4.5
LW26-32F	∅48	55	48	23+14n	36max	36	36	∅ 8.5	∅ 4.5

Limit strengthened(A1217)

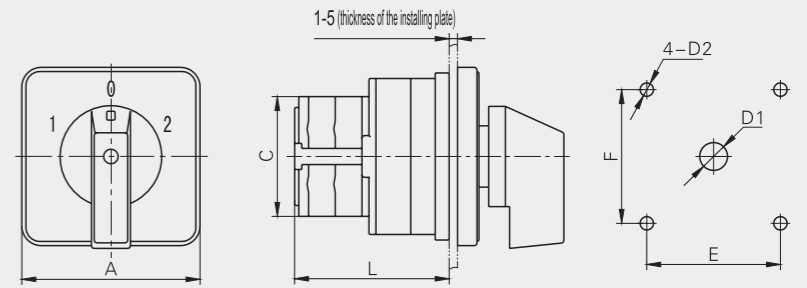

Description	Dimensions (mm)			Installation (mm)			
	A	C	L	E	F	D1	D2
LW26-20	∅64	43	36+9.6n	48	48	∅ 10	∅ 4.5
LW26-20c	∅64	60	36+12.6n	48	48	∅ 10	∅ 4.5
LW26-20X	∅64	66	44+14n	48	48	∅ 10	∅ 4.5
LW26-25	∅64	45.2	37.5+12.8n	48	48	∅ 10	∅ 4.5
LW26-32	∅64	58	36+12.8n	48	48	∅ 10	∅ 4.5
LW26-32F	∅64	48	37.5+14n	48	48	∅ 10	∅ 4.5
LW26-63	∅64	66	36+21.5n	48	48	∅ 10	∅ 4.5

Put out type(A32P1)

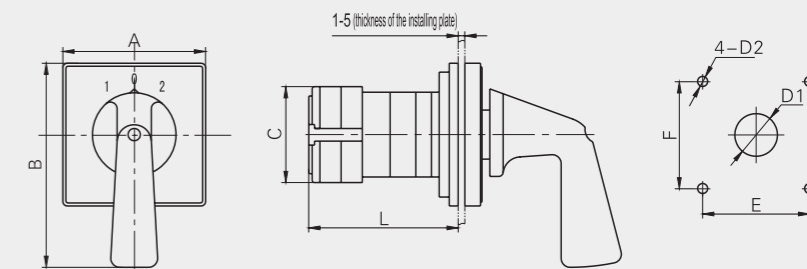

Description	Dimensions (mm)				Installation (mm)			
	A	B	C	L	E	F	D1	D2
LW26-20	64	91.5	43	48+9.6n	48	48	∅ 20	∅ 4.5
LW26-20X	64	91.5	42	51+14n	48	48	∅ 20	∅ 4.5
LW26-25	64	91.5	45.2	49+12.8n	48	48	∅ 20	∅ 4.5
LW26-32F	64	91.5	48	49+14n	48	48	∅ 20	∅ 4.5

LW26 Series Rotary Switch

Special type and optional extras

Wide-angle selfreset(A12L6)

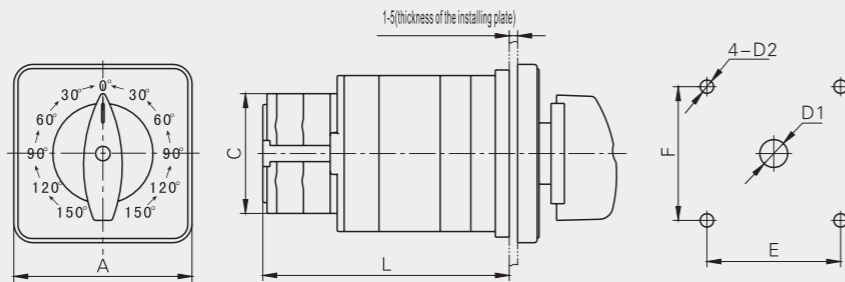
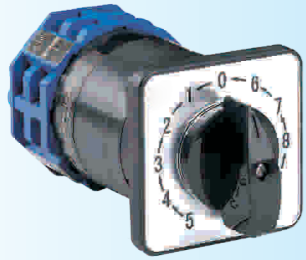

Description	Dimensions (mm)			Installation (mm)			
	A	C	L	E	F	D1	D2
LW26-20	□64	43	70+9.6n	48	48	∅ 10	∅ 4.5
LW26-20c	□64	60	69+12.6n	48	48	∅ 10	∅ 4.5
LW26-20X	□64	42	78+14n	48	48	∅ 10	∅ 4.5
LW26-25	□64	45.2	71+12.8n	48	48	∅ 10	∅ 4.5
LW26-32	□64	58	69+12.8n	48	48	∅ 10	∅ 4.5
LW26-32F	□64	48	71+14n	48	48	∅ 10	∅ 4.5
LW26-63	□64	66	69+21.5n	48	48	∅ 10	∅ 4.5

Selfreset with ratchet positioned(A11R8)

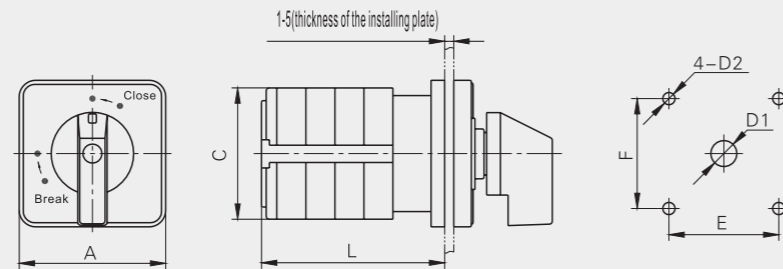

Description	Dimensions (mm)			Installation (mm)			
	A	C	L	E	F	D1	D2
LW26-20	□48	43	31.5+9.6n	36	36	∅ 8.5	∅ 4.5
LW26-20X	□48	42	40+14n	36	36	∅ 8.5	∅ 4.5
LW26-25	□48	45.2	36+12.8n	36	36	∅ 8.5	∅ 4.5

Selfreset with selfreset plate positioned(A11R5)

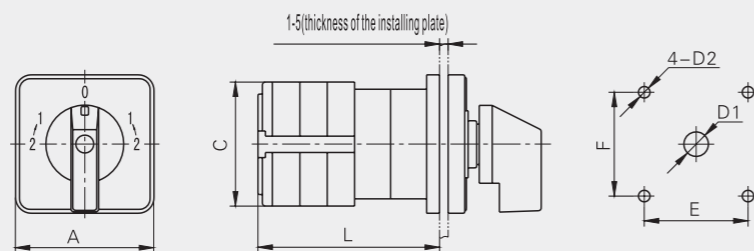

Description	Dimensions (mm)			Installation (mm)			
	A	C	L	E	F	D1	D2
LW26-20	□48	43	34.5+9.6n	36	36	∅ 8.5	∅ 4.5
LW26-20X	□48	42	42+14n	36	36	∅ 8.5	∅ 4.5
LW26-25	□48	45.2	35.5+12.8n	36	36	∅ 8.5	∅ 4.5

LW26 Series Rotary Switch

Special type and optional extras

Multi-position selfreset(A11R9)

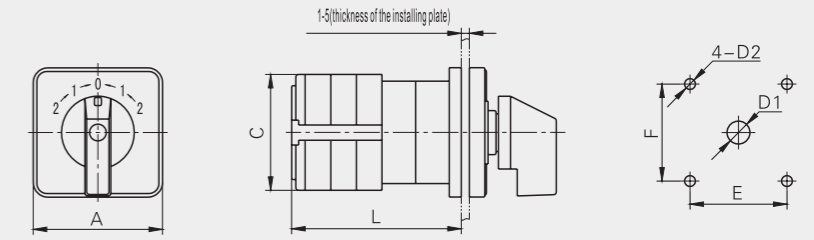

Description	Dimensions (mm)			Installation (mm)			
	A	C	L	E	F	D1	D2
LW26-20	□48	43	34.5+9.6n	36	36	∅ 8.5	∅ 4.5
LW26-20X	□48	42	42+14n	36	36	∅ 8.5	∅ 4.5
LW26-25	□48	45.2	35.5+12.8n	36	36	∅ 8.5	∅ 4.5

Multi-position selfreset II(A11R10)

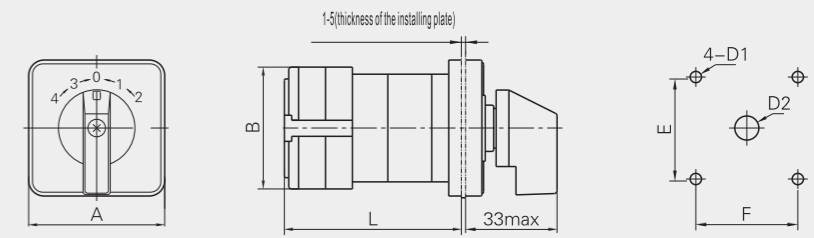
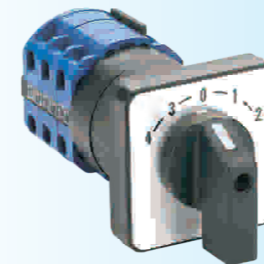

Description	Dimensions (mm)			Installation (mm)				Layers
	A	B	L	E	F	D1	D2	
LW26-20	□49	43	31+9.6n	36	36	∅ 4.5	∅ 8.5	1~3
LW26-25	□49	45.2	32+12.8n	36	36	∅ 4.5	∅ 8.5	1~2
LW26-32F	□49	48	32+14n	36	36	∅ 4.5	∅ 8.5	1~6
LW26-20X	□49	42	39+14n	36	36	∅ 4.5	∅ 8.5	1~4

Door inter-lock(K32GS)

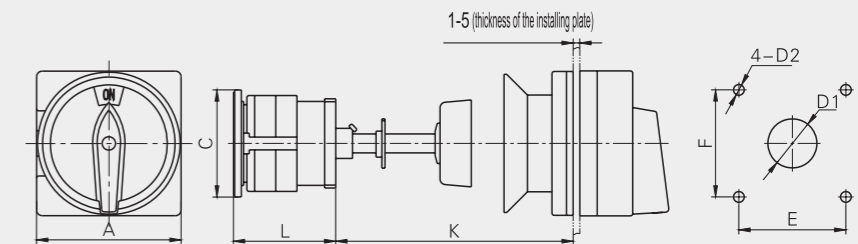

Description	Dimensions (mm)				Installation (mm)			
	A	C	L	K	E	F	D1	D2
LW26-20	□66	48	27+9.6n	150	36	36	∅ 22	∅ 4.5
LW26-20X	□66	64	35+14n	150	48	48	∅ 22	∅ 4.5
LW26-25	□66	48	28+12.8n	150	36	36	∅ 22	∅ 4.5
LW26-32	□66	64	37.5+12.8n	150	48	48	∅ 22	∅ 4.5
LW26-32F	□66	64	28+14n	150	48	48	∅ 22	∅ 4.5
LW26-63	□66	64	37.5+21.5n	150	48	48	∅ 22	∅ 4.5
LW26-125	□89	68	101+26.5n	150	68	68	∅ 30	∅ 6
LW26-160	□89	68	113+32.5n	150	68	68	∅ 30	∅ 6

LW26 Series Rotary Switch

Special type and optional extras

Protective cover(N111)

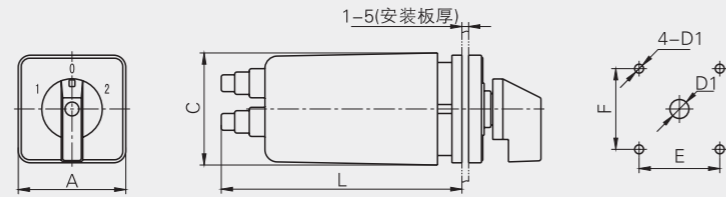

Description	Dimensions (mm)			Installation (mm)				Layers
	A	C	L	E	F	D1	D2	
LW26-20	□48	50	67.5	36	36	∅ 8.5	∅ 4.5	1-3
LW26-20	□48	50	96.5	36	36	∅ 8.5	∅ 4.5	1-6

Protective box(IP65)

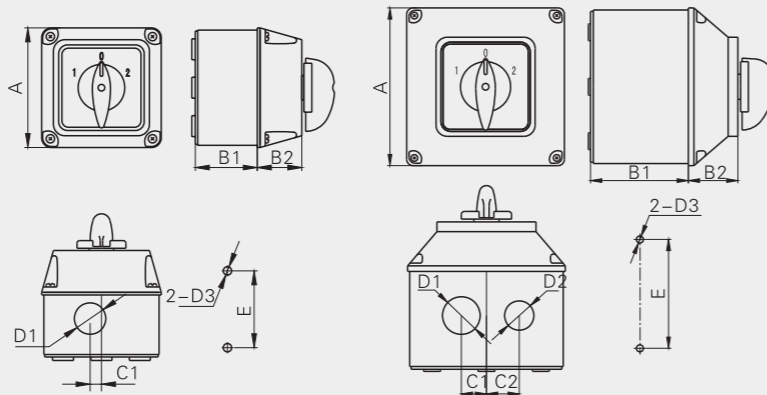

Description	Dimensions (mm)						Installation (mm)			Layers	Remark
	A	B1	B2	C1	C2	D1	D2	D3	E		
LW26-20	□68.5	35.5	25.5	6.5		∅ 18		∅ 5	44	1-2	
LW26-20	□68.5	45	25.5	6.5		∅ 18		∅ 5	44	1-3	
LW26-20	□68.5	35.5	32.5	6.5		∅ 18		∅ 5	44	1	Single hole
LW26-20	□68.5	45	32.5	6.5		∅ 18		∅ 5	44	1-2	Single hole
LW26-20	□68.5	55	25.5	6.5		∅ 18		∅ 5	44	1-4	
LW26-20	□68.5	55	32.5	6.5		∅ 18		∅ 5	44	1-3	Single hole
LW26-20	□113	70.5	35.5	18	23.5	∅ 27	∅ 21	∅ 5	78	1-7	
LW26-20X	□68.5	35.5	25.5	6.5		∅ 18		∅ 5	44	1-2	
LW26-20X	□68.5	45	25.5	6.5		∅ 18		∅ 5	44	1-2	
LW26-20X	□68.5	35.5	32.5	6.5		∅ 18		∅ 5	44		
LW26-20X	□68.5	45	32.5	6.5		∅ 18		∅ 5	44	1	Single hole
LW26-20X	□68.5	55	25.5	6.5		∅ 18		∅ 5	44	1-3	
LW26-20X	□68.5	55	32.5	6.5		∅ 18		∅ 5	44	1-2	Single hole
LW26-20X	□113	70.5	35.5	18	23.5	∅ 27	∅ 21	∅ 5	78	1-4	
LW26-25	□68.5	35.5	25.5	6.5		∅ 18		∅ 5	44	1	
LW26-25	□68.5	45	25.5	6.5		∅ 18		∅ 5	44	1-2	
LW26-25	□68.5	35.5	32.5	6.5		∅ 18		∅ 5	44	1	Single hole
LW26-25	□68.5	45	32.5	6.5		∅ 18		∅ 5	44	1	Single hole
LW26-25	□68.5	55	25.5	6.5		∅ 18		∅ 5	44	1-4	
LW26-25	□68.5	55	32.5	6.5		∅ 18		∅ 5	44	1-2	Single hole
LW26-25	□113	70.5	35.5	18	23.5	∅ 27	∅ 21	∅ 5	78	1-5	
LW26-32F	□68.5	35.5	25.5	6.5		∅ 18		∅ 5	44	1	
LW26-32F	□68.5	45	25.5	6.5		∅ 18		∅ 5	44	1-2	
LW26-32F	□68.5	35.5	32.5	6.5		∅ 18		∅ 5	44	1	Single hole
LW26-32F	□68.5	45	32.5	6.5		∅ 18		∅ 5	44	1	Single hole
LW26-32F	□68.5	55	25.5	6.5		∅ 18		∅ 5	44	1-3	
LW26-32F	□68.5	55	32.5	6.5		∅ 18		∅ 5	44	1-2	Single hole
LW26-32F	□113	70.5	35.5	18	23.5	∅ 27	∅ 21	∅ 5	78	1-4	
LW26-32	□113	70.5	35.5	18	23.5	∅ 27	∅ 21	∅ 5	78	1-4	
LW26-63	□113	70.5	35.5	18	23.5	∅ 27	∅ 21	∅ 5	78	1-2	

LW26 Series Rotary Switch

Special type and optional extras

Protective cover(F11R)

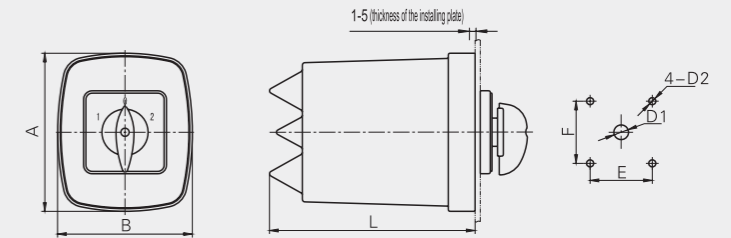

Description	Dimensions (mm)			Installation (mm)				Layers
	A	B	L	E	F	D1	D2	
LW26-20	91.5	78	195	36	36	∅ 8.5	∅ 4.5	1-6
LW26-20X	91.5	78	195	36	36	∅ 8.5	∅ 4.5	1-4
LW26-25	91.5	78	195	36	36	∅ 8.5	∅ 4.5	1-5
LW26-32F	91.5	78	195	36	36	∅ 8.5	∅ 4.5	1-4

Protective iron box(T121)

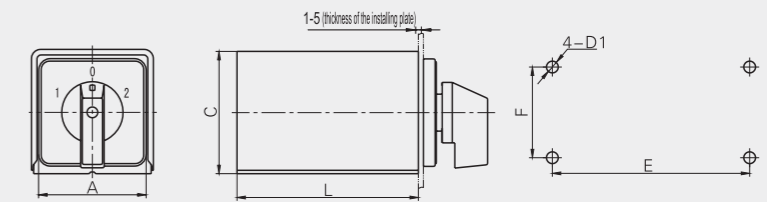

Description	Dimensions (mm)			Installation (mm)			Layers
	A	C	L	E	F	D1	
LW26-20	□64	74	108	69.5	54	∅ 7	1-6
LW26-20X	□64	74	108	69.5	54	∅ 7	1-4
LW26-25	□64	74	108	69.5	54	∅ 7	1-6
LW26-32	□64	74	108	69.5	54	∅ 7	1-4
LW26-32F	□64	74	108	69.5	54	∅ 7	1-4

Thermoplastic sealed box I(IP65)

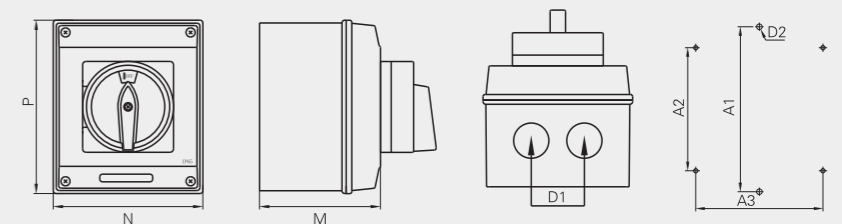

Description	Dimensions (mm)				Installation (mm)				Remark
	D1	M	N	P	A1	A2	A3	D2	
LW26-20	∅ 20	70	85	125	118	-	-	∅ 4.5	1-4 Small
LW26-25	∅ 20	70	85	125	118	-	-	∅ 4.5	1-2 Small
LW26-20X	∅ 20	70	85	125	118	-	-	∅ 4.5	1-2 Small
LW26-32F	∅ 20	70	85	125	118	-	-	∅ 4.5	1-2 Small
LW26-20	∅ 20	87	107	124	-	88	91	∅ 4.5	1-5 Medium
LW26-20X	∅ 20	87	107	124	-	88	91	∅ 4.5	1-4 Medium
LW26-25	∅ 20	87	107	124	-	88	91	∅ 4.5	1-3 Medium
LW26-32F	∅ 20	87	107	124	-	88	91	∅ 4.5	1-3 Medium
LW26-32	∅ 20	87	107	124	-	88	91	∅ 3.5	1-3 Medium
LW26-63	∅ 20	87	107	124	-	88	91	∅ 3.5	1-2 Big
LW26-32	∅ 25	108	143	203	-	180	124	∅ 3.5	1-5 Big
LW26-63	∅ 25	108	143	203	-	180	124	∅ 3.5	1-3 Big
LW26-125	∅ 25/∅ 32	108	143	203	-	180	124	∅ 5.5	1-2 Big
LW26-160	∅ 25/∅ 32	108	143	203	-	180	124	∅ 5.5	1-2 Big

Q type: Start and run of motor

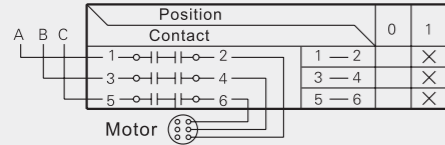

D 0723 type: Start and reversing of motor

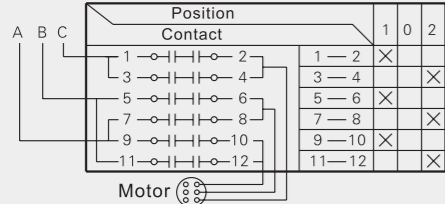

SN type: Start and reversing of 2 speed motor

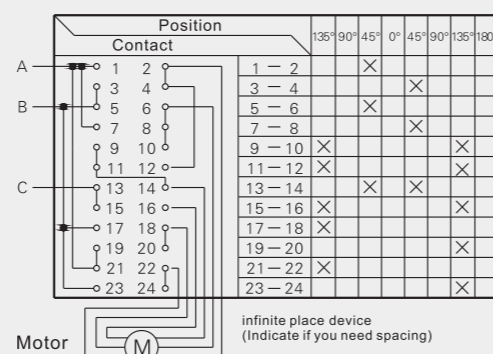

D 404/3-B type: Positive & negative switch of single phase motor

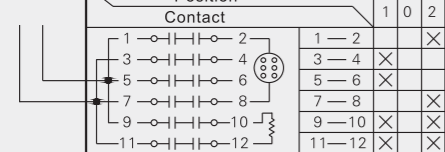

M08T type: Speed range switch of 2 speed motor

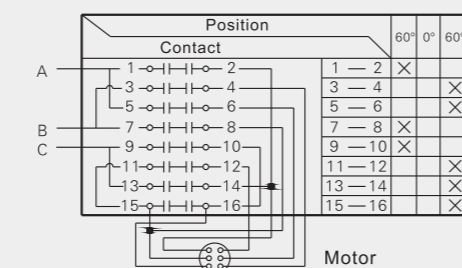

M07 type: 0-Y-Δ starting switch

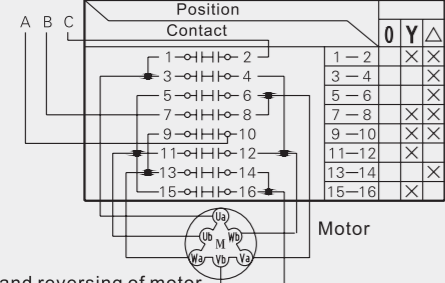

I 7206/6 type

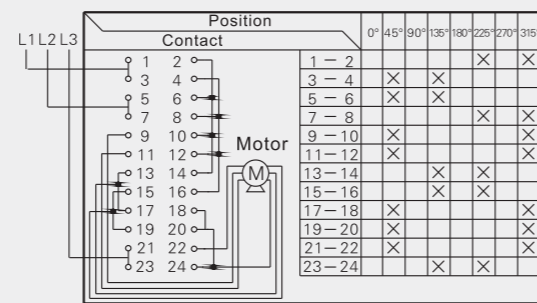

N type: Start and reversing of motor

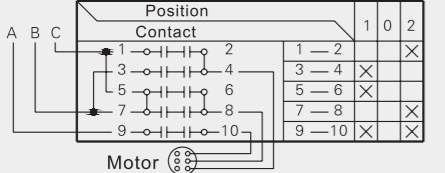

Switch for 3 speed motor

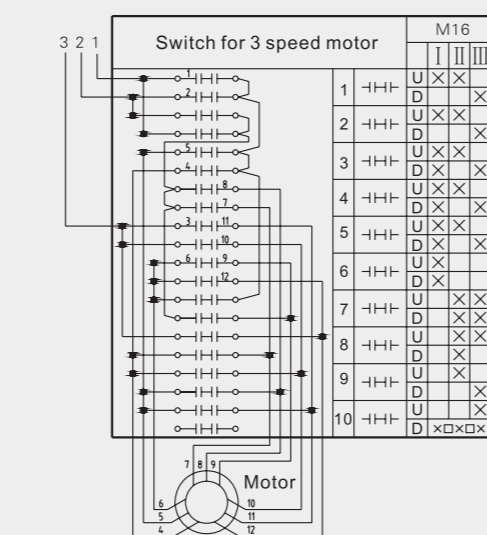

M08 type: Speed range switch of 2 speed motor

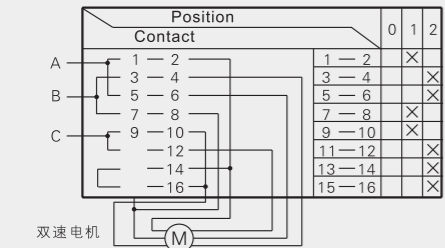

4 position 3 phase Voltmeter with 0 position

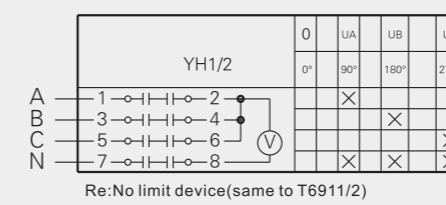

4 position 3 phase Voltmeter with 0 position

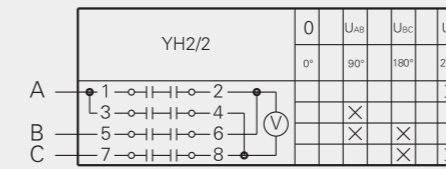

4 position 3 phase Voltmeter with 0 position

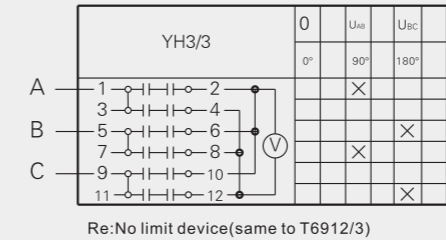

7 position 3 phase Voltmeter with 0 position and null line

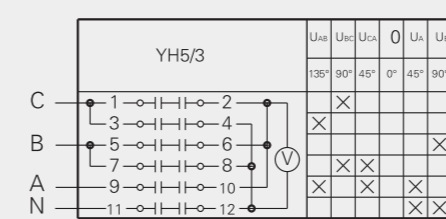

4 position 1 phase and 3 phase Voltmeter with 0 position and null line

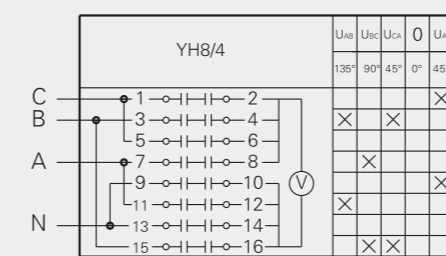

2 phase Ammeter without 0 position and 3 mutual inductor

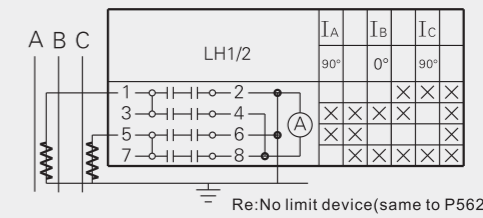

2 phase Ammeter with 0 position and 3 mutual inductor

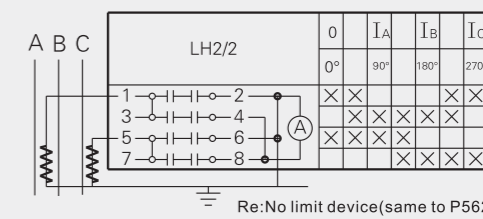

3 phase Ammeter with 0 position and 3 mutual inductor

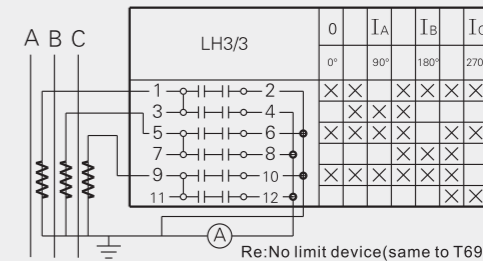

4 phase Ammeter with 0 position and 3 mutual inductor

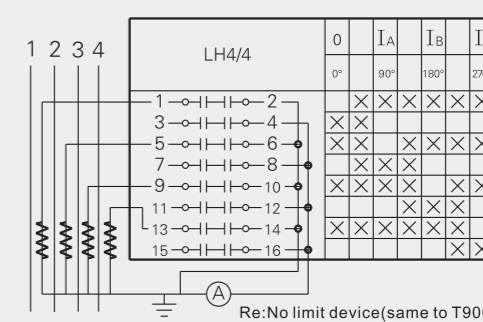

3 phase Ammeter with 0 position and 3 mutual inductor

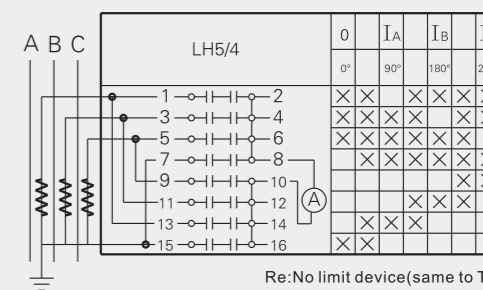



LW26 Series Rotary Switch

Special type and optional extras with pictures

Re: ● is the suitable type

LW26-10	Suitable type
	LW26-10 ●
LW26-10 □ • A10I	LW26-10X ●
	LW26-20
LW26-10X □ • A10I	LW26-20c
	LW26-25
LW26-10X □ • A10I	LW26-32
	LW26-32F
	LW26-63
	LW26-125
	LW26-160
	LW26-20X
Single hole	Suitable type
	LW26-10 ●
LW26-10X □ • C55F	LW26-10X ●
	LW26-20
	LW26-20c
	LW26-25
	LW26-32
	LW26-32F
	LW26-63
	LW26-125
	LW26-160
	LW26-20X
	
LW26-10X □ • C51S1	

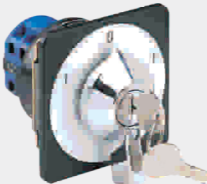
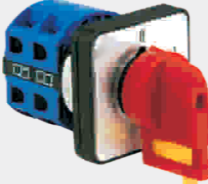
32A prevent contact	Suitable type
	LW26-10
LW26-32F □ • A11I	LW26-10X
	LW26-20
LW26-32F □ • C55I	LW26-20c
	LW26-25
LW26-32F □ • C51S1	LW26-32
	LW26-32F ●
	LW26-63
	LW26-125
	LW26-160
	LW26-20X ●
LS type	Suitable type
	LW26-10
LW26-20 □ • A12LS	LW26-10X
	LW26-20
	LW26-20c ●
	LW26-25 ●
	LW26-32 ●
	LW26-32F ●
	LW26-63 ●
	LW26-125
	LW26-160
	LW26-20X ●
Single lock	Suitable type
	LW26-10
LW26-25 □ • A11DS	LW26-10X
	LW26-20 ●
	LW26-20c
	LW26-25 ●
	LW26-32
	LW26-32F ●
	LW26-63
	LW26-125
	LW26-160
	LW26-20X ●

LW26 Series Rotary Switch

Special type and optional extras with pictures

Re: ● is the suitable type

With indicator light	Suitable type
	LW26-10
LW26-20 □ • A66I	LW26-10X
	LW26-20 ●
	LW26-20c
	LW26-25 ●
	LW26-32
	LW26-32F ●
	LW26-63
	LW26-125
	LW26-160
	LW26-20X ●
With indicator light and lock	Suitable type
	LW26-10
LW26-25 □ • A66S1	LW26-10X
	LW26-20 ●
	LW26-20c
	LW26-25 ●
	LW26-32
	LW26-32F ●
	LW26-63
	LW26-125
	LW26-160
	LW26-20X ●
B type handle	Suitable type
	LW26-10
LW26-25 □ • C55B	LW26-10X
	LW26-20 ●
	LW26-20c
	LW26-25 ●
	LW26-32
	LW26-32F ●
	LW26-63
	LW26-125
	LW26-160
	LW26-20X ●
	
LW26-20 □ • C55B	

Limit strengthened	Suitable type
	LW26-10
LW26-20 □ • A32I7	LW26-10X
	LW26-20 ●
	LW26-20c ●
	LW26-25 ●
	LW26-32 ●
	LW26-32F ●
	LW26-63 ●
	LW26-125
	LW26-160
	LW26-20X ●
Double hole installation	Suitable type
	LW26-10
LW26-25 □ • G88B	LW26-10X
	LW26-20 ●
	LW26-20c
	LW26-25 ●
	LW26-32
	LW26-32F ●
	LW26-63
	LW26-125
	LW26-160
	LW26-20X ●
Foot installation	Suitable type
	LW26-10
LW26-25 □ • B11R	LW26-10X
	LW26-20 ●
	LW26-20c ●
	LW26-25 ●
	LW26-32 ●
	LW26-32F ●
	LW26-63 ●
	LW26-125 ●
	LW26-160 ●
	LW26-20X ●
DIN-rail installation	Suitable type
	LW26-10
LW26-20 □ • D11R	LW26-10X
	LW26-20 ●
	LW26-20c
	LW26-25 ●
	LW26-32 ●
	LW26-32F ●
	LW26-63 ●
	LW26-125 ●
	LW26-160 ●
	LW26-20X ●

LW26 Series Rotary Switch

Special type and optional extras with pictures

Re: ● is the suitable type

Single hole installation	Suitable type
	LW26-10 ●
LW26-10 □ • A11I10	LW26-10X ●
	LW26-20 ●
LW26-10 □ • C10S1	LW26-20c ●
	LW26-25 ●
LW26-10X □ • C10I	LW26-32 ●
	LW26-32F ●
LW26-20 □ • C55S1	LW26-63
	LW26-125
LW26-25 □ • C55I	LW26-160
	LW26-20X ●
LW26-20 □ • C11B	
	
LW26-32F □ • C11I	

Positioned selfreset	Suitable type
	LW26-10
LW26-20 □ • A11R	LW26-10X
	LW26-20 ●
	LW26-20c
	LW26-25 ●
	LW26-32
	LW26-32F ●
	LW26-63
	LW26-125
	LW26-160
	LW26-20X
Multi-positioned selfreset	Suitable type
	LW26-10
LW26-20 □ • A11R	LW26-10X
	LW26-20 ●
	LW26-20c
	LW26-25 ●
	LW26-32
	LW26-32F
	LW26-63
	LW26-125
	LW26-160
	LW26-20X
Put out type	Suitable type
	LW26-10
LW26-20 □ • A32P1	LW26-10X
	LW26-20 ●
	LW26-20c
	LW26-25 ●
	LW26-32
	LW26-32F ●
	LW26-63
	LW26-125
	LW26-160
	LW26-20X ●
Wide-angle selfreset	Suitable type
	LW26-10
LW26-20c □ • A12L6	LW26-10X
	LW26-20 ●
	LW26-20c ●
	LW26-25 ●
	LW26-32 ●
	LW26-32F ●
	LW26-63 ●
	LW26-125
	LW26-160
	LW26-20X ●

LW26 Series Rotary Switch

Special type and optional extras with pictures

Re: ● is the suitable type

Rectangle plate	Suitable type
	LW26-10
LW26-20 □ • A21R	LW26-10X
	LW26-20 ●
	LW26-20c ●
	LW26-25 ●
	LW26-32 ●
	LW26-32F ●
	LW26-63 ●
	LW26-125
	LW26-160
	LW26-20X ●
	
LW26-20 □ • A41I	
	
LW26-63 □ • A42I	
Q type	Suitable type
	LW26-10
LW26-20 □ • A11I4	LW26-10X
	LW26-20 ●
	LW26-20c
	LW26-25 ●
	LW26-32
	LW26-32F ●
	LW26-63
	LW26-125
	LW26-160
	LW26-20X ●
	
LW26-25 □ • A31I4	
	
LW26-32F □ • A11I4	

Door lock	Suitable type
	LW26-10
LW26-63 □ • K32GS	LW26-10X
	LW26-20 ●
	LW26-20c ●
	LW26-25 ●
	LW26-32 ●
	LW26-32F ●
	LW26-63 ●
	LW26-125 ●
	LW26-160 ●
	LW26-20X ●
	
LW26-125 □ • K33I	
Protective cover	Suitable type
	LW26-10
	LW26-10X
	LW26-20
	LW26-20c
	LW26-25
	LW26-32
	LW26-32F
	LW26-63 ●
	LW26-125 ●
	LW26-160 ●
	LW26-20X
Direct-current power	Suitable type
	LW26-10
LW26-25 □ • A11R2	LW26-10X
	LW26-20
	LW26-20c
	LW26-25 ●
	LW26-32
	LW26-32F
	LW26-63
	LW26-125
	LW26-160
	LW26-20X

LW26 Series Rotary Switch

Special type and optional extras with pictures

Re: ● is the suitable type

Protective cover	Suitable type
	LW26-10
	LW26-10X
	LW26-20 ●
	LW26-20c
	LW26-25 ●
	LW26-32
	LW26-32F ●
	LW26-63
	LW26-125
	LW26-160
	LW26-20X ●

LW26-20□ • F11R

Protective iron box	Suitable type
	LW26-10
	LW26-10X
	LW26-20 ●
	LW26-20c
	LW26-25 ●
	LW26-32 ●
	LW26-32F ●
	LW26-63
	LW26-125
	LW26-160
	LW26-20X ●

LW26-20□ • T32I

Embedded nut installation	Suitable type
	LW26-10
	LW26-10X
	LW26-20 ●
	LW26-20c ●
	LW26-25 ●
	LW26-32 ●
	LW26-32F ●
	LW26-63 ●
	LW26-125
	LW26-160
	LW26-20X ●

LW26-63□ • J88I

Distance adjusted double hole installation	Suitable type
	LW26-10
	LW26-10X
	LW26-20 ●
	LW26-20c ●
	LW26-25 ●
	LW26-32 ●
	LW26-32F ●
	LW26-63 ●
	LW26-125
	LW26-160
	LW26-20X ●

LW26-32F□ • L82I4

Protective box	Suitable type
	LW26-10
	LW26-10X
	LW26-20 ●
	LW26-20c
	LW26-25 ●
	LW26-32 ●
	LW26-32F ●
	LW26-63 ●
	LW26-125
	LW26-160
	LW26-20X ●

LW26-20□ • E31I

Quick Switch	Suitable type
	LW26-10
	LW26-10X
	LW26-20 ●
	LW26-20c
	LW26-25 ●
	LW26-32
	LW26-32F ●
	LW26-63
	LW26-125
	LW26-160
	LW26-20X ●

LW26-20□ • G85I3

Protective box	Suitable type
	LW26-10
	LW26-10X
	LW26-20 ●
	LW26-20c
	LW26-25 ●
	LW26-32 ●
	LW26-32F ●
	LW26-63 ●
	LW26-125
	LW26-160
	LW26-20X ●

LW26-20□ • E31GS

Protective box	Suitable type
	LW26-10
	LW26-10X
	LW26-20 ●
	LW26-20c
	LW26-25 ●
	LW26-32 ●
	LW26-32F ●
	LW26-63
	LW26-125
	LW26-160
	LW26-20X ●

LW26-20□ • E11S1

Protective box	Suitable type
	LW26-10
	LW26-10X
	LW26-20 ●
	LW26-20c
	LW26-25 ●
	LW26-32 ●
	LW26-32F ●
	LW26-63
	LW26-125
	LW26-160
	LW26-20X ●

LW26-20□ • E11DS

Protective box	Suitable type
	LW26-10
	LW26-10X
	LW26-20 ●
	LW26-20c
	LW26-25 ●
	LW26-32 ●
	LW26-32F ●
	LW26-63 ●
	LW26-125
	LW26-160
	LW26-20X ●

LW26-32□ • E12R

LW26GS Series Pad-lock Type Switch

Introduction

LW26GS series Pad-lock type switch are derivatives of LW26 series rotary switch. Installed in equipment where it requires a pad-lock to lock the switch in certain position. For instance, to fix the switch in ON position, to prevent the unauthorized personnel from operation the switch.

LW26GS series Pad-lock type switch complies with the GB 14048.3 and IEC 60947.3.

Classification

(1) The LW26GS switch has 6 current ratings: 20A, 25A, 32A, 63A, 125A and 160A. For 20A and 25A are able to install M1 or M2 plate, and for 32A and 63A are able to install M2 or M3 plate, for 125A and 160A are able to install M3 plate only. The M1 plate is able to put 2 lockers, M2 and M3 are able to put 3 lockers.

Re:-1, -2, -3 represent M1, M2, M3

(2) The LW26GS switch has 2 types:

Common type, black plate black handle

Quick stop type, with quick stop mark, yellow plate and red handle

Technical parameters

Description	LW26GS-20	LW26GS-25	LW26GS-32	LW26GS-63	LW26GS-125	LW26GS-160
Rated working voltage U _e V	440	440	440	440	440	440
Rated thermal current I _{th} A	20	25	32	63	125	160
Rated working current I _e A						
AC-21A A	20	25	32	63	100	150
AC-22A A	20	25	32	63	100	150
AC-23A A	15	22	30	57	90	135
Power P						
AC-23A kW	7.5	11	15	30	45	75

LW26GS-20/04-1

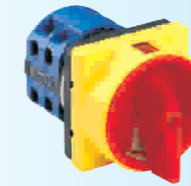

LW26GS-20X/04-1



LW26GS-25/04-1

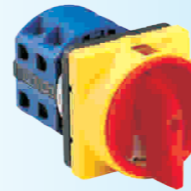

LW26GS-20/04-2



LW26GS-20X/04-2



LW26GS-25/04-2



LW26GS Series Pad-lock Type Switch

Dimensions and installation

LW26GS-□/□-□

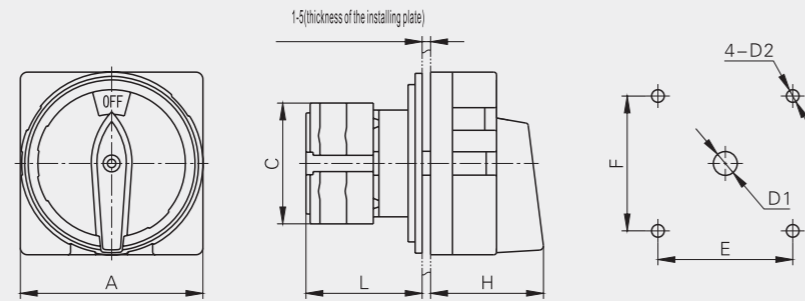

Description	Escutcheon plate	Dimensions (mm)				Installation (mm)			
		A	C	L	H	E	F	D1	D2
LW26GS-20/04-1	M1	□48	43	42	33	36	36	∅ 8.5	∅ 4.5
LW26GS-20/04-2	M2	□64	43	43	42	48	48	∅ 10	∅ 4.5
LW26GS-20X/04-1	M1	□48	42	54	33	36	36	∅ 8.5	∅ 4.5
LW26GS-20X/04-2	M2	□64	42	55	42	48	48	∅ 10	∅ 4.5
LW26GS-25/04-1	M1	□48	45.2	50	33	36	36	∅ 8.5	∅ 4.5
LW26GS-25/04-2	M2	□64	45.2	51	42	48	48	∅ 10	∅ 4.5
LW26GS-32/04-2	M2	□64	58	55	42	48	48	∅ 10	∅ 4.5
LW26GS-32/04-3	M3	□88	58	55	52	68	68	∅ 13	∅ 6
LW26GS-63/04-2	M2	□64	66	72.5	42	48	48	∅ 10	∅ 4.5
LW26GS-63/04-3	M3	□88	66	72.5	52	68	68	∅ 13	∅ 6
LW26GS-125/04-3	M3	□88	84	88	52	68	68	∅ 13	∅ 6
LW26GS-160/04-3	M3	□88	88	100	52	68	68	∅ 13	∅ 6

LW26GS-32/04-2



LW26GS-63/04-2



LW26GS-32/04-3



LW26GS-125/04-3

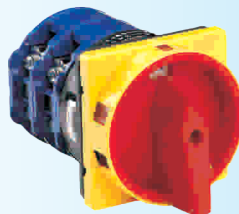

LW26GS-63/04-3



LW26GS-160/04-3

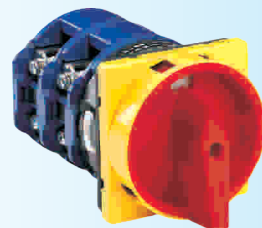

LW26S Key-lock Type Switch

Introduction

LW26S Key-lock type switch is derivatives of LW26 rotary switch. Installed in equipments, which requires a key to lock the switch. It prevents the unauthorized personnel from mis-operation.

LW26S Key-lock type switch comply with the GB 14048.3 and IEC 60947-3.

Technical parameters

Description	LW26S-10 LW26S-10X	LW26S-20 LW26S-20X	LW26S-25	LW26S-32	LW26S-63
Rated working voltage Ue V	440	440	440	440	440
Rated thermal current Ith A	10	20	25	32	63
Rated working current Ie A					
AC-21A A	10	20	25	32	63
AC-22A A	10	20	25	32	63
AC-23A A	7	15	22	30	57
Power P					
AC-23A kW	3	7.5	11	15	30

Dimensions and installation

LW26S S1

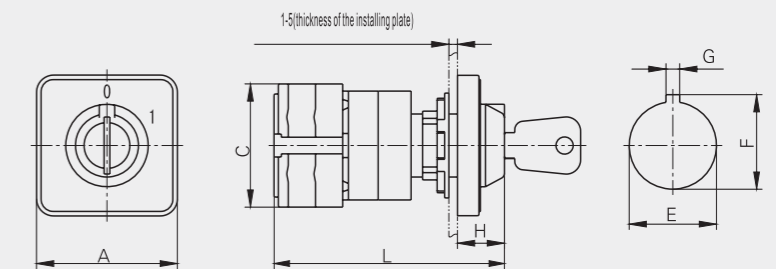

Description	Dimensions (mm)				Installation (mm)		
	A	C	H	L	E	F	G
LW26S-10	□30	30	8.5	60	∅ 16.2	18	1.9
LW26S-10X	□30	28	8.5	71.5	∅ 16.2	18	1.9
LW26S-20	□48	43	15.6	76.5	∅ 22.3	24.1	3.2
LW26S-20	□64	43	15.6	76.5	∅ 22.3	24.1	3.2
LW26S-20	□64	43	15.6	76.5	∅ 30.5	33	4.8
LW26S-20X	□48	42	15.6	93.5	∅ 22.3	24.1	3.2
LW26S-20X	□64	42	15.6	93.5	∅ 22.3	24.1	3.2
LW26S-20X	□64	42	15.6	93.5	∅ 30.5	33	4.8
LW26S-25	□48	45.2	15.6	83	∅ 22.3	24.1	3.2
LW26S-25	□64	45.2	15.6	83	∅ 22.3	24.1	3.2
LW26S-25	□64	45.2	15.6	83	∅ 30.5	33	4.8
LW26S-32F	□48	48	15.6	86.5	∅ 22.3	24.1	3.2
LW26S-32F	□64	48	15.6	86.5	∅ 22.3	24.1	3.2
LW26S-32F	□64	48	15.6	86.5	∅ 30.5	33	4.8

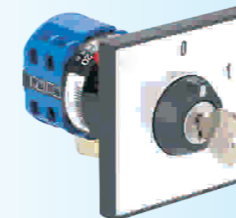

LW26S Key-lock Type Switch

Dimensions and installation

LW26S S1Y

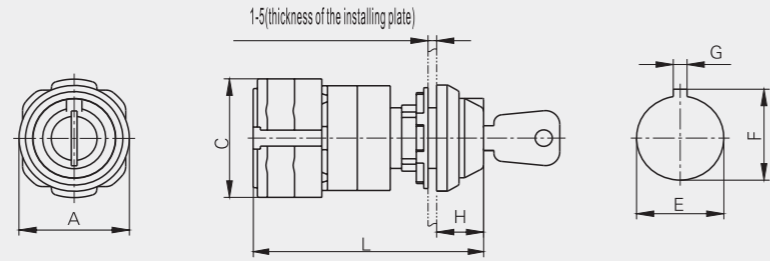
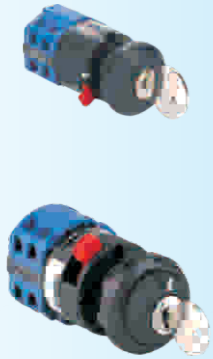

Description	Dimensions (mm)				Installation (mm)		
	A	C	H	L	E	F	G
LW26S-10	∅ 29	30	8.5	60	∅ 16.2	18	1.9
LW26S-10X	∅ 29	28	8.5	71.5	∅ 16.2	18	1.9
LW26S-20	∅ 39	43	15.6	76.5	∅ 22.3	24.1	3.2
LW26S-20	∅ 39	43	15.6	76.5	∅ 22.3	24.1	3.2
LW26S-20	∅ 39	43	15.6	76.5	∅ 30.5	33	4.8
LW26S-20X	∅ 39	42	15.6	93.5	∅ 22.3	24.1	3.2
LW26S-20X	∅ 39	42	15.6	93.5	∅ 22.3	24.1	3.2
LW26S-20X	∅ 39	42	15.6	93.5	∅ 30.5	33	4.8
LW26S-25	∅ 39	45.2	15.6	83	∅ 22.3	24.1	3.2
LW26S-25	∅ 39	45.2	15.6	83	∅ 22.3	24.1	3.2
LW26S-25	∅ 39	45.2	15.6	83	∅ 30.5	33	4.8
LW26S-32F	∅ 39	48	15.6	86.5	∅ 22.3	24.1	3.2
LW26S-32F	∅ 39	48	15.6	86.5	∅ 22.3	24.1	3.2
LW26S-32F	∅ 39	48	15.6	86.5	∅ 30.5	33	4.8

LW26S Key-lock Type Switch

Dimensions and installation

LW26S S2

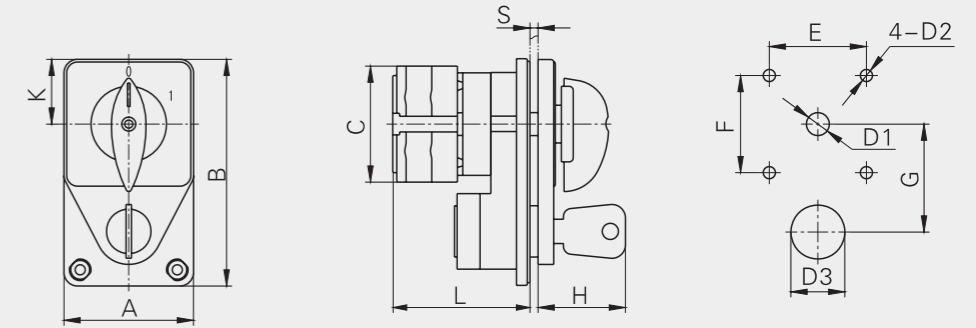

Description	Dimensions (mm)							Installation (mm)					
	A	B	K	C	L	H	S	E	F	G	D1	D2	D3
LW26S-20	48	84	24	43	51.5	32.5	1~4	36	36	40	∅ 8.5	∅ 4.5	∅ 20
LW26S-20X	64	112	32	42	68.5	32.5	1~4	36	36	40	∅ 8.5	∅ 4.5	∅ 20
LW26S-25	48	84	24	45.2	58	32.5	1~4	36	36	40	∅ 8.5	∅ 4.5	∅ 20
LW26S-32	64	112	32	58	72	34	1~6	48	48	48	∅ 10	∅ 4.5	∅ 34
LW26S-32F	48	84	24	48	61.5	32.5	1~4	36	36	40	∅ 8.5	∅ 4.5	∅ 20
LW26S-63	64	112	32	66	79	34	1~6	48	48	48	∅ 10	∅ 4.5	∅ 34

LW26S S3

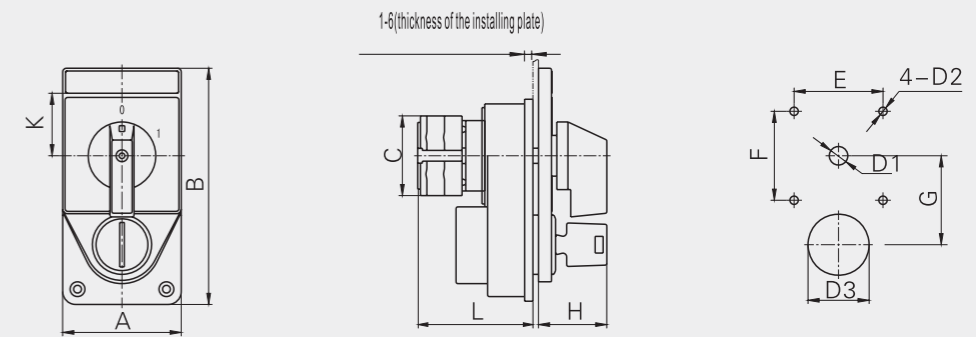
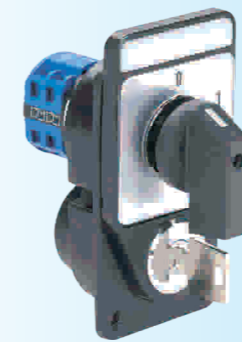

Description	Dimensions (mm)					Installation (mm)						
	A	B	K	C	L	H	E	F	G	D1	D2	D3
LW26S-20	64	126.5	32	43	51.5	34	48	48	48	∅ 10	∅ 4.5	∅ 34
LW26S-20X	64	126.5	32	42	68.5	34	48	48	48	∅ 10	∅ 4.5	∅ 34
LW26S-25	64	126.5	32	45.2	58	34	48	48	48	∅ 10	∅ 4.5	∅ 34
LW26S-32	64	126.5	32	58	72	34	48	48	48	∅ 10	∅ 4.5	∅ 34
LW26S-32F	64	126.5	32	48	61.5	34	48	48	48	∅ 10	∅ 4.5	∅ 34
LW26S-63	64	126.5	32	66	79	34	48	48	48	∅ 10	∅ 4.5	∅ 34

LW30 Series Rotary Switch

Introduction

LW30 series rotary switch applied to circuits of AC 50Hz with working voltage up to 440V and rated working current up to 100A.

LW30 is suitable to control: air-conditioner, water pump and ventilating equipments, and AC motors with small power.

LW30 series rotary switch have six current ratings: 20A, 32A, 40A, 63A, 80A, 100A.

LW30 series has the finger protection terminals, which offers an extra advantage.

LW30 series switch has larger insulation distance, quick disconnecting response. And is a good choice for DC circuits. LW30 has additional contact which enable us to install the contact separately.

LW30 series rotary switch comply with: GB/T 14048.3, and IEC 60947-3.

Working conditions

- (1) Ambient temperature DO NOT exceed 40°C, and the average temperature, measured over a period of 24 hours, DO NOT exceed 35°C.
- (2) Ambient temperature should not be below -25°C
- (3) Should not be installed above 2000m above sea level.
- (4) The humidity should not exceed 50% when the ambient temperature is 40°C and higher humidity is allowed for lower temperature.

Installation conditions

- (1) A clean environment is required
- (2) Please follow our manual

Classification

1. Classified by utilization
 - (1) AC-23A
 - (2) AC-3
2. Classified by protective level
 - (1) Without plastic box: IP2L0
 - (2) With plastic box: IP65

LW30-20、25、32

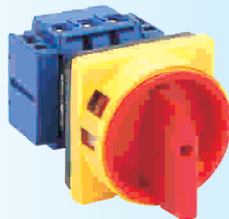
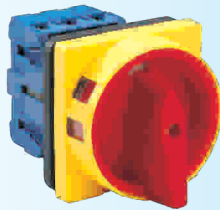

LW30-40、63

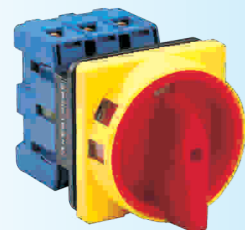
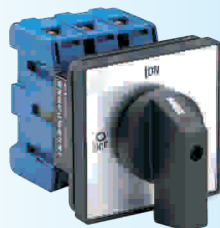

LW30 Series Rotary Switch

Introduction

Designation

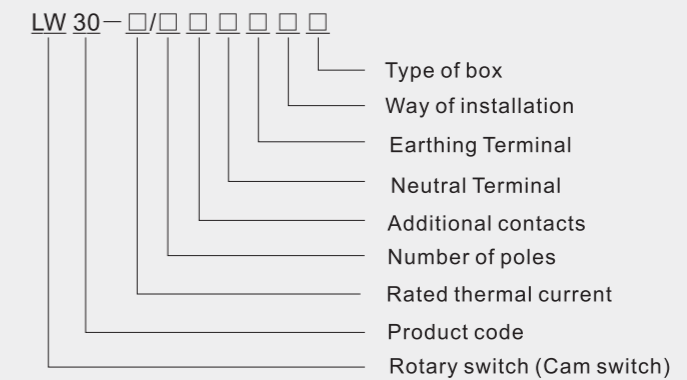

Accessorial code

Number of poles: 3P, 4P

Additional contacts: 0 for additional contacts not included, 1 for with additional contacts.

Neutral terminal: 0 for neutral terminal not included, 1 for with neutral terminal

Earthing terminal: 0 for earthing terminal not included, 1 for with earthing terminal

Way of Installation

1. Escutcheon plate installation with pad-lock
2. Escutcheon plate installation
3. Single pad-lock DIN-rail installation
4. Doorlock base installation with pad-lock system
5. Single hole installation

Type of box: 0 not included, 1 included

Escutcheon plate

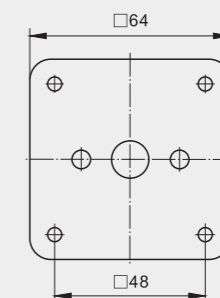

LW30-80、100

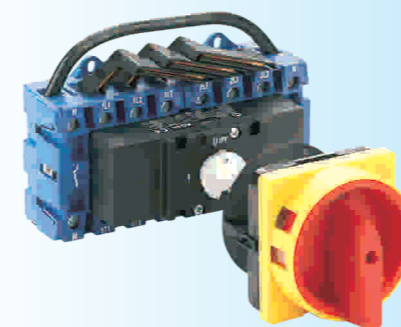
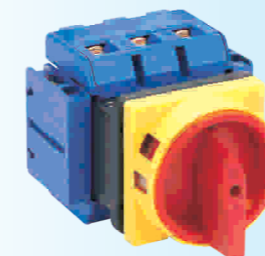
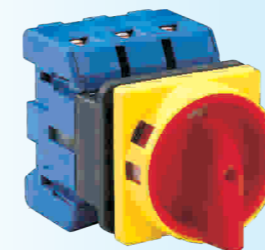

Type of handle

R Type



I Type



K Type



Designation

Accessories

Single pad-lock Multi-pad-lock Plastic box

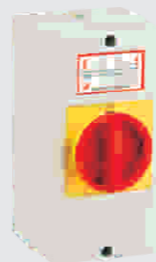

Cover



Auxiliary contact & Optional accessories

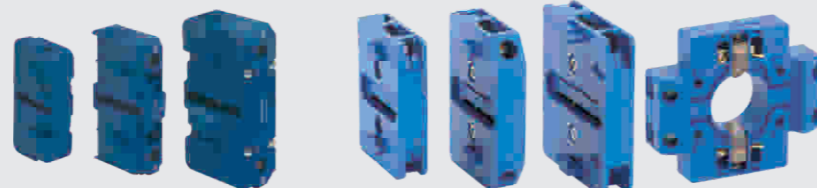

AC15 220~240V 6A/380~440V 4A

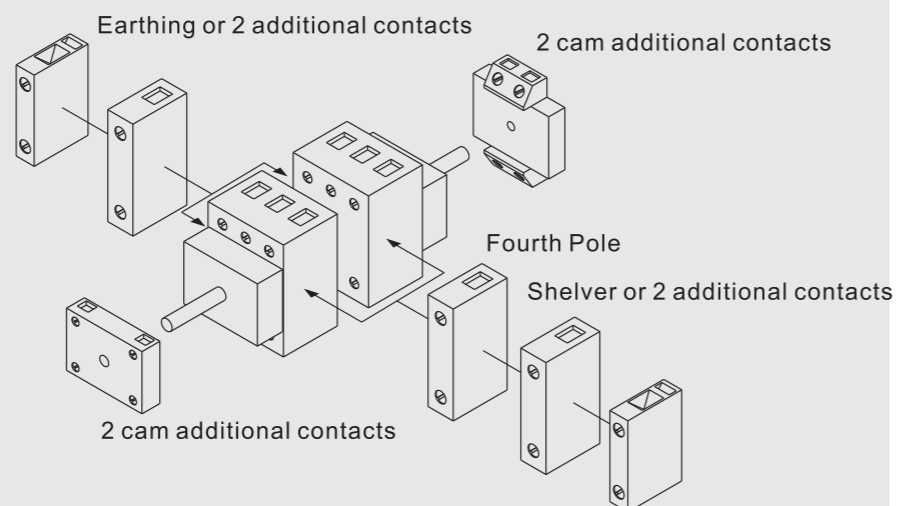

Technical parameters

Description	LW30-25(20)	LW30-32	LW30-40	LW30-63	LW30-80	LW30-100
Rated thermal current I _{th} A	25(20)	32	40	63	80	100
Rated working voltage U _e V	240 440	240 440	240 440	240 440	240 440	240 440
Rated working current I _e /P _e						
AC-21A A/kW	20/- 20/-	32/- 32/-	40/- 40/-	63/- 63/-	80/- 80/-	100/- 100/-
AC-22A A/kW	20/- 20/-	32/- 32/-	40/- 40/-	63/- 63/-	80/- 80/-	100/- 100/-
AC-23A A/kW	15/4 15/7.5	22/5.5 22/11	30/7.5 30/15	43/11 43/22	57/18.5 57/30	70/22 70/37
AC-3 A/kW	11.7/3 11.7/5.5	15/4 15/7.5	22/7.5 22/11	36/11 36/18.5	43/15 43/22	57/18.5 57/30

Type of current

Alternating current 50Hz

Positions of Main contact

ON OR OFF

Rated duty

8 hours everyday, operational efficiency 30times/ hour

Electrical endurance

AC-23: 10000times, AC-3:6000times, Auxiliary contact: 2000times.

Order Procedurer

When you order our LW30 series, we need your data as following:

- Rated working current, for example: LW30-20;
- Accessorial code, please write it orderly:
 - Number of poles, for example:3P;
 - Do you need additional contacts: 0 not inclosed, 1 inclosed;
 - Do you need neutral terminal: 0 not inclosed, 1 inclosed;
 - Do you need earthing terminal: 0 not inclosed, 1 inclosed;
 - Way of installation:

- Escutcheon plate with pad-lock
- Escutcheon plate
- Single lock DIN-rail installation
- Doorlock foot installation with pad-lock system
- Single hole installation

3. Other accessorial code, please write it orderly:

- Type of Escutcheon plate: 1 Escutcheon plate;
 - Denote 22.5 hole;
 - Denote 25 hole;
 - Denote 30.5 hole.

- Do you need Escutcheon plate with airproof:
 - 0 not inclosed, 1 inclosed.
- Color of bottom plate: 1 Denote silver color:
 - 2 Denote yellow; 3 Make it against your color
- Character letter: 1 denote letter; 2Chinese letter;
 - Special sign
- Code of handle: R or K or I

For example:

If you order 40A/3P with additional contacts and earthing terminal and Escutcheon plate without neutral terminal and plastic box.

You must write: LW30-40/310120

If you want to order 32A/3 with Doorlock base installation, you must write:LW30-32/30040.

If you want to order 40A/3 with adding contacts, earthing terminal, Escutcheon plate, plate with airproof, yellow, Chinese letter, K handle; without neutral terminal and plastic box. You must write: LW30-40/310120.1123K.

LW30 Series Rotary Switch

Dimensions and installation

Escutcheon plate installation

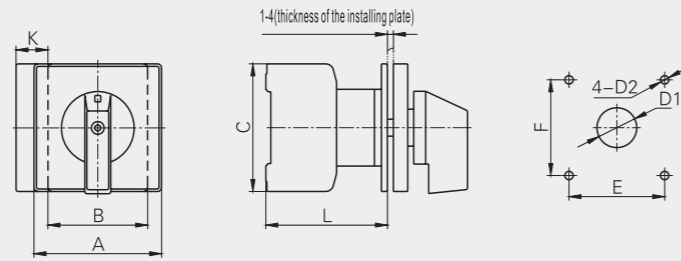

Description	Dimensions (mm)					Installation (mm)			
	A	B	C	K	L	E	F	D1	D2
LW30-20	□64	42	54	13.5	61	48	48	∅10	∅4.2
LW30-25	□64	42	54	13.5	61	48	48	∅10	∅4.2
LW30-32	□64	42	54	13.5	61	48	48	∅10	∅4.2
LW30-40	□64	50	64	16	67	48	48	∅10	∅4.2
LW30-63	□64	50	64	16	67	48	48	∅10	∅4.2
LW30-80	□64	70	80	22.5	82	48	48	∅10	∅4.2
LW30-100	□64	70	80	22.5	82	48	48	∅10	∅4.2

Base installation

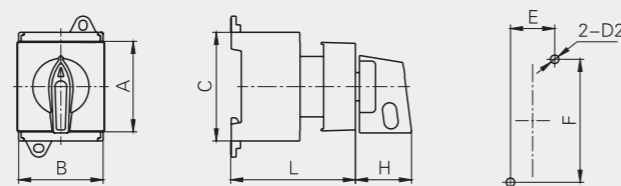

Description	Dimensions(mm)					Installation(mm)		
	A	B	C	L	H	E	F	D2
LW30-20	45	42	54	50	26	22	60	∅4.2
LW30-25	45	42	54	50	26	22	60	∅4.2
LW30-32	45	42	54	50	26	22	60	∅4.2

Re:Product can be installed in 35mm parallel.

Single hole installation

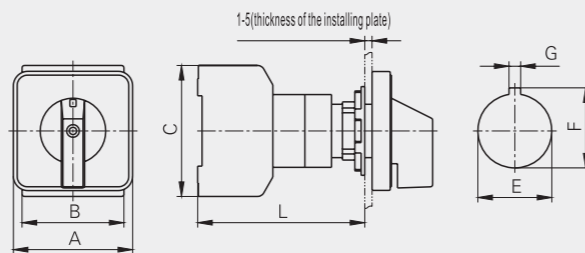

Description	Dimensions(mm)				Installation(mm)		
	A	B	C	L	E	F	G
LW30-20	□49	42	54	69	∅22.3	24.1	3.2
LW30-20	□64	42	54	69	∅22.3	24.1	3.2
LW30-25	□49	42	54	69	∅22.3	24.1	3.2
LW30-25	□64	42	54	69	∅22.3	24.1	3.2
LW30-32	□49	42	54	69	∅22.3	24.1	3.2
LW30-32	□64	42	54	69	∅22.3	24.1	3.2

LW30 Series Rotary Switch

Dimensions and installation

Doorlock base installation with pad-lock system

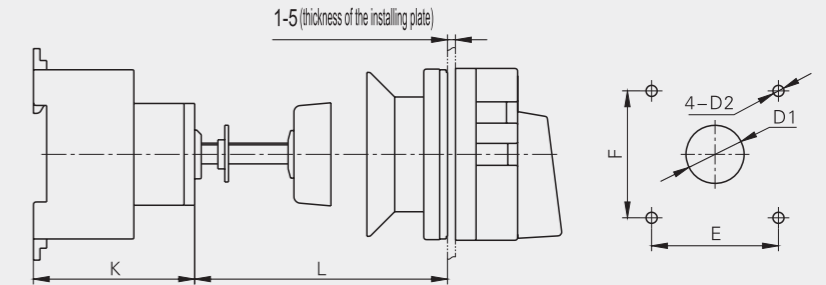

Description	Dimensions(mm)			Installation(mm)			
	K	Lmin	Lmax	E	F	D1	D2
LW30-20	50	32	150	48	48	∅22	∅4.2
LW30-25	50	32	150	48	48	∅22	∅4.2
LW30-32	50	32	150	48	48	∅22	∅4.2
LW30-40	61	32	150	48	48	∅22	∅4.2
LW30-63	61	32	150	48	48	∅22	∅4.2
LW30-80	68	32	150	48	48	∅22	∅4.2
LW30-100	68	32	150	48	48	∅22	∅4.2

Re:Product can be installed in 35mm parallel.

Protective cover

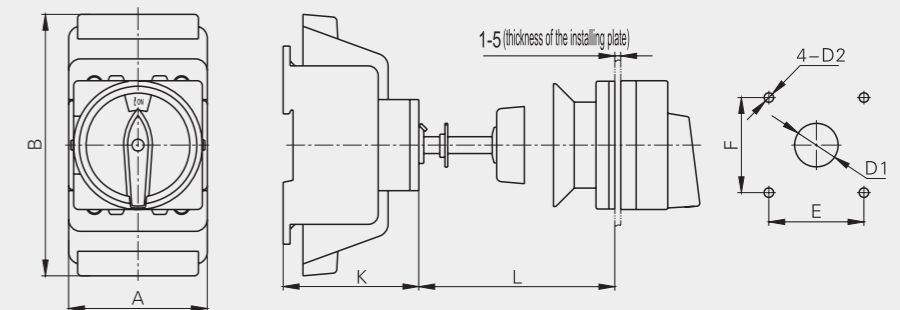

Description	Dimensions(mm)					Installation(mm)			
	A	B	K	Lmin	Lmax	E	F	D1	D2
LW30-20	94.5	42.5	50.5	32	150	48	48	∅22	∅4.2
LW30-25	94.5	42.5	50.5	32	150	48	48	∅22	∅4.2
LW30-32	94.5	42.5	50.5	32	150	48	48	∅22	∅4.2
LW30-40	95.5	50.5	61	32	150	48	48	∅22	∅4.2
LW30-63	95.5	50.5	61	32	150	48	48	∅22	∅4.2
LW30-80	70	133	68	32	150	48	48	∅22	∅4.2
LW30-100	70	133	68	32	150	48	48	∅22	∅4.2

LW30 Series Rotary Switch

Dimensions and installation

Plastic box (IP65)

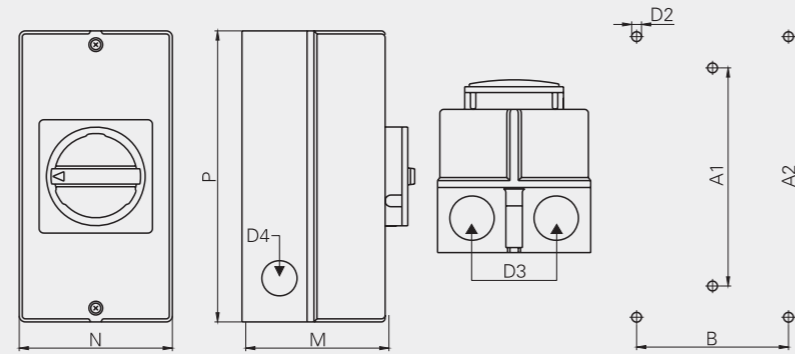
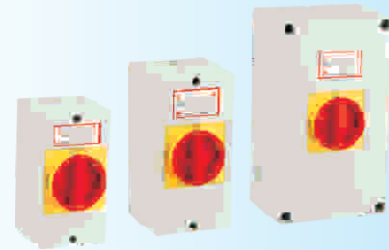

Description	Dimensions (mm)					Installation (mm)			
	D3	D4	M	N	P	A1	A2	B	D2
LW30-20	∅ 23	∅ 19	85	83	160	150	--	--	∅ 4.2
LW30-25	∅ 23	∅ 19	85	83	160	150	--	--	∅ 4.2
LW30-32	∅ 23	∅ 19	85	83	160	150	--	--	∅ 4.2
LW30-40	∅ 29	∅ 23	100	95	190	178	--	--	∅ 4.2
LW30-63	∅ 29	∅ 23	100	95	190	178	--	--	∅ 4.2
LW30-80	∅ 37.5	∅ 23	144	105	250	--	229	124	∅ 6.5
LW30-100	∅ 37.5	∅ 23	144	105	250	--	229	124	∅ 6.5

Photovoltaic (pv) DC

Designation

LW 30 - □/□□□□□□□□

- Additional function:
 - 0-not inclosed 1-with multithrow function
 - 2-with NONC auxiliary contact
- Plastic box: 0-not inclosed 1- inclosed
- Way of installation:
 1. Escutcheon plate installation with pad-lock
 2. Escutcheon plate installation
 3. Doorlock base installation
 4. Doorlock base installation with pad-lock system
 5. Single hole installation
- Earthing terminal: 0 not inclosed, 1 inclosed
- Neutral terminal: 0 not inclosed, 1 inclosed
- Additional contacts: 0 not inclosed, 1 inclosed
- Poles: 1- 3P, 2- 4P, 3-6P, 4-8P
- Rated thermal current(A)
- Product code
- Rotary switch (Cam switch)

Stripping Length

LW30-20/
LW30-32

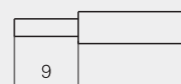

LW30-40

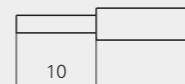

LW30 Series Rotary Switch

Photovoltaic (pv) DC

DC

1 x 2P

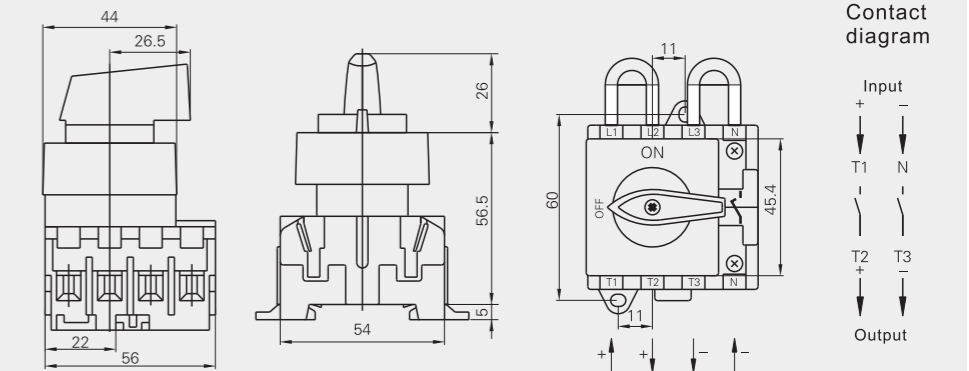

Description	Operating current	Operating Voltage(DC)	Biggest PV load voltage (DC)	Isolation Voltage	Dia of soft line(mm)
LW30-20	16 A	450 V	520 V	690 V	∅ 2.5
LW30-32	25 A	450 V	520 V	690 V	∅ 4
LW30-40	32 A	450 V	520 V	690 V	∅ 4.5
LW30-20	12 A	500 V	575 V	690 V	∅ 2.5
LW30-32	20 A	500 V	575 V	690 V	∅ 4

Usage: DC-22A

DC

1 x 2P

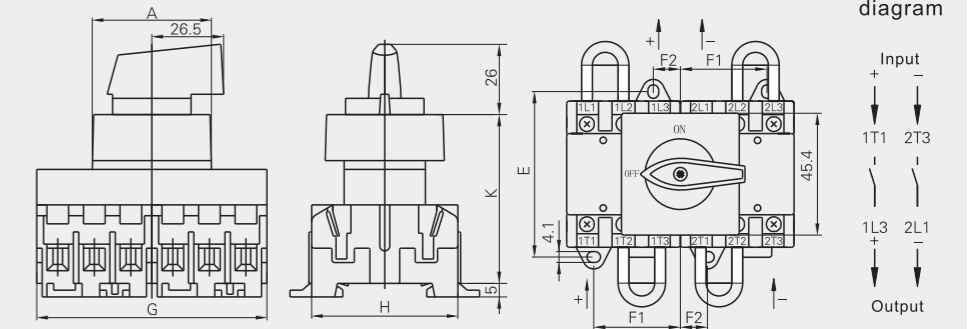
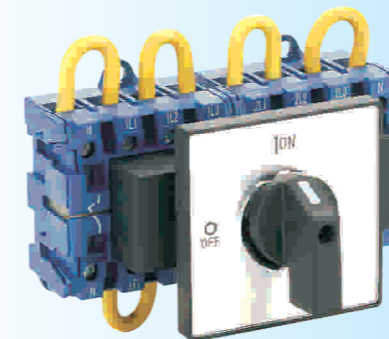

Description	A	E	F1	F2	G	H	K
LW30-20/LW30-32	44	60	32	10	84	54	64
LW30-40	105.4	70	37.5	12.5	100	64	62.5

Description	Operating current	Operating Voltage(DC)	Biggest PV load voltage (DC)	Isolation Voltage	Dia of soft line(mm)
LW30-20	16 A	650 V	750 V	1000 V	∅ 2.5
LW30-32	32 A	500 V	575 V	1000 V	∅ 4
LW30-40	32 A	650 V	750 V	1000 V	∅ 4.5
LW30-20	12 A	800 V	920 V	1000 V	∅ 2.5
LW30-32	25 A	650 V	750 V	1000 V	∅ 4

Usage: DC-22A

LW30 Series Rotary Switch

Photovoltaic (pv) DC

DC 1 × 2P

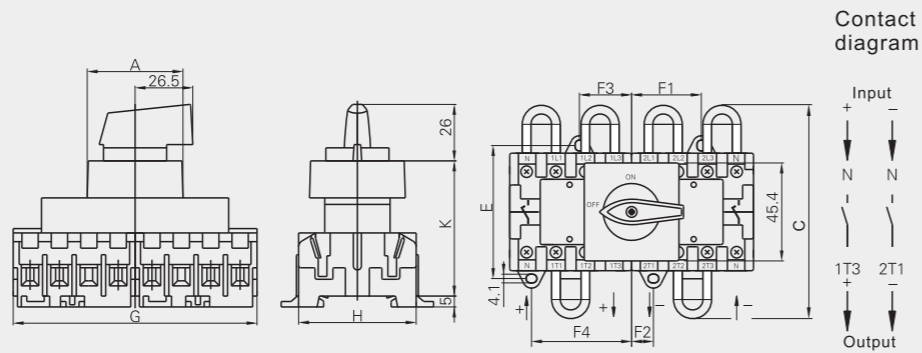

Description	A	C	E	F1	F2	F3	F4	G	H	K
LW30-20/LW30-32	44	100	60	32	10	24	46	111	54	64
LW30-40	105.4	100	70	37.5	12.5	28.5	53.5	132	64	62.5

Description	Operating current	Operating Voltage(DC)	Biggest PV load voltage (DC)	Isolation Voltage	Dia of soft line(mm)
LW30-20	16 A	800V	920 V	1000 V	∅ 2.5
LW30-32	25 A	800 V	920 V	1000 V	∅ 4
LW30-40	32 A	800 V	920 V	1000 V	∅ 4.5

Usage: DC-22A

DC 1 × 2P

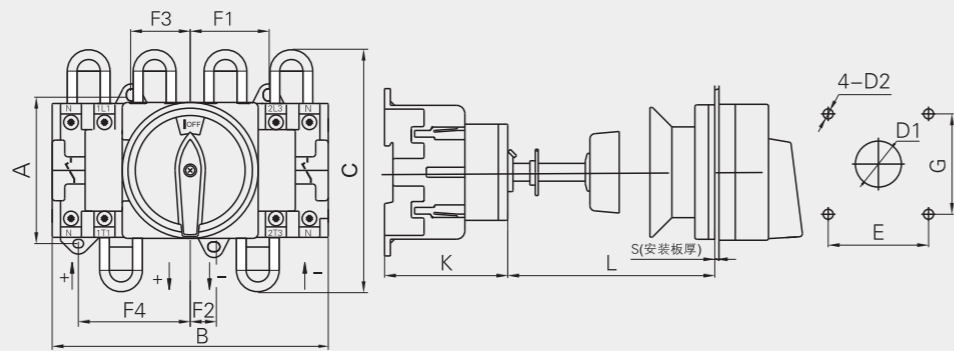
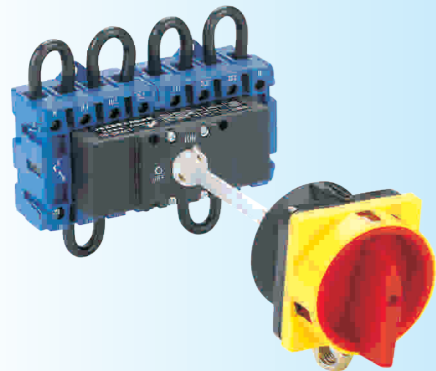

Description	Dimensions (mm)										Installation (mm)			
	A	B	C	K	F1	F2	F3	F4	L	S	E	G	D1	D2
LW30-20	60	111	100	50.5	32	10	24	46	32~150	1~5	48	48	∅ 22	∅ 4.5
LW30-25	60	111	100	50.5	32	10	24	46	32~150	1~5	48	48	∅ 22	∅ 4.5
LW30-32	60	111	100	50.5	32	10	24	46	32~150	1~5	48	48	∅ 22	∅ 4.5
LW30-40	70	132	120	61	37.5	12.5	28.5	53.5	32~150	1~5	48	48	∅ 22	∅ 4.5
LW30-63	70	132	120	61	37.5	12.5	28.5	53.5	32~150	1~5	48	48	∅ 22	∅ 4.5

Description	Operating current	Operating Voltage(DC)	Biggest PV load voltage (DC)	Isolation Voltage	Dia of soft line(mm)
LW30-20	16 A	800V	920 V	1000 V	∅ 2.5
LW30-32	25 A	800 V	920 V	1000 V	∅ 4
LW30-40	32 A	800 V	920 V	1000 V	∅ 4.5

Usage: DC-22A

LW31 Series Rotary Switch

Introduction

LW31 series rotary switch applied to switch gear and control of electric motors as well as to change over of electric circuits, it's a good substitution for other cam switches.

Designation

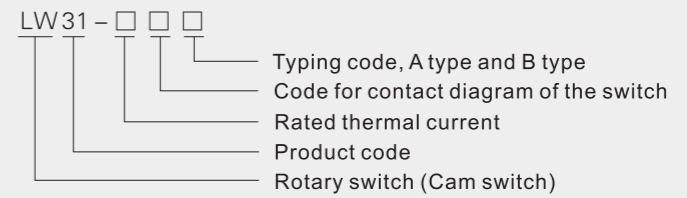

Technical parameters

Description	LW31-20	LW31-25	LW31-32	LW31-50	LW31-75
Rated thermal current I _{th} A	20	25	32	50	75
Rated working voltage U _e V	110 220 440	110 220 440 500 690	110 220 440 500 690	110 220 440 500 690	110 220 440 500 690
Rated working current I _e					
AC-21A	A 20	25	32	50	75
AC-22A	A 16	20	32	40	63
DC-20	A 20	25	32	50	75
Power P					
AC-23A	kW 5 7.5	7.5 11 15	11 18.5 22	15 22 30	18.5 30 37
AC-3	kW 4 5.5	5.5 7.5 11	7.5 15 18.5	11 18.5 22	15 22 30
AC-4	kW 2.2 3	2.2 4 4	3 5.5 5.5	5.5 7.5 9	7.5 11 15
DC-23	kW 0.77 1.2	2 2.2	2 2.2	3 6	4 8

Mechanical life

Mechanical life without load: 0.3x10⁶ times, operation frequency is 120 times/h
 Mechanical life with load: 0.6x10⁴ times operation frequency is 120 times/h

Dimensions and installation

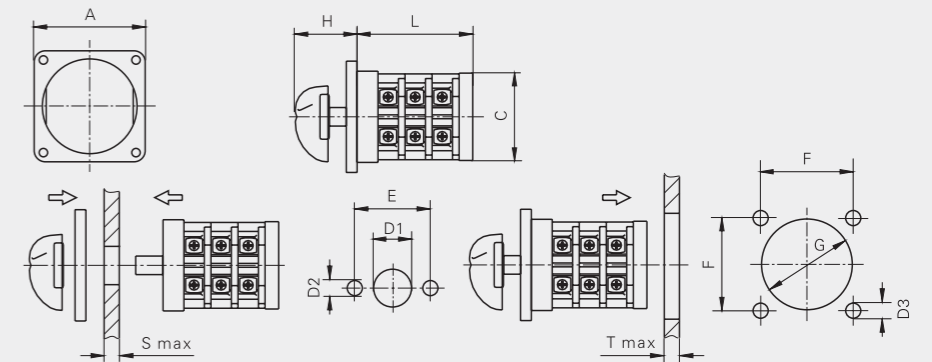

Description	Plate	Dimensions (mm)				Installation (mm)							
		A	C	H	L	E	D1	D2	S	F	G	D3	T
LW31-20	□54	∅44	38	25	12n	32	∅9.5	∅3.2	1.5	35	∅45	∅4.5	6
LW31-20	□72	∅44	38	25	12n	32	∅9.5	∅3.2	1.5	58	∅45	∅4.5	6
LW31-25	□72	∅59	36	23	13n	33	∅9.5	∅3.2	1.5	58	∅64	∅4.5	6
LW31-25	□105	∅59	53	23	13n	33	∅9.5	∅3.2	1.5	85	∅64	∅4.5	6
LW31-32	□72	∅59	36	23	18n	33	∅9.5	∅3.2	1.5	58	∅64	∅4.5	6
LW31-32	□105	∅59	53	23	18n	33	∅9.5	∅3.2	1.5	85	∅64	∅4.5	6
LW31-50	□105	∅80	53	34	18n	46	∅13	∅5.3	3	85	∅90	∅5.5	8
LW31-75	□105	∅80	53	34	27n	46	∅13	∅5.3	3	85	∅90	∅5.5	8

Re: n for number of layers.

LW31-20 □ A



LW31-20 □ B



LW31-25



LW31-32



LW31-50



LW31-75



LW31B Series Rotary Switch

Introduction

LW31B series rotary switch applied to switch gear and control of electric motors as well as to change over of electric circuits, it's a good substitution for othe cam switches.

LW31B-16 □ A



LW31B-16 □ A

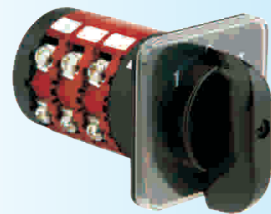

LW31B-16 □ B



Designation

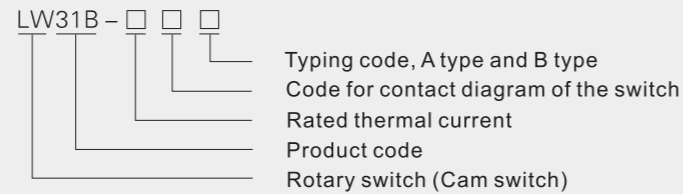

Technical parameters

Description		LW31B-16			
Rated thermal current	I _{th}	A	16		
Rated working voltage	U _e	V	380~440	220~240	
Rated working current	I _e				
AC-21A		A	16		
AC-22A		A	16		
AC-15		A	3	4	
DC-13		A		0.8	
Power	P				
AC-23A		kW	5.5	3	
AC-2		kW	5.5	3	
AC-3		kW	4	2.2	
AC-4		kW	1	0.5	

Mechanical life

Mechanical life without load: 0.3x10⁸ times, operation frequency is 120 times/h

Mechanical life with load: 0.6x10⁸ times operation frequency is 120 times/h

Dimensions and installation

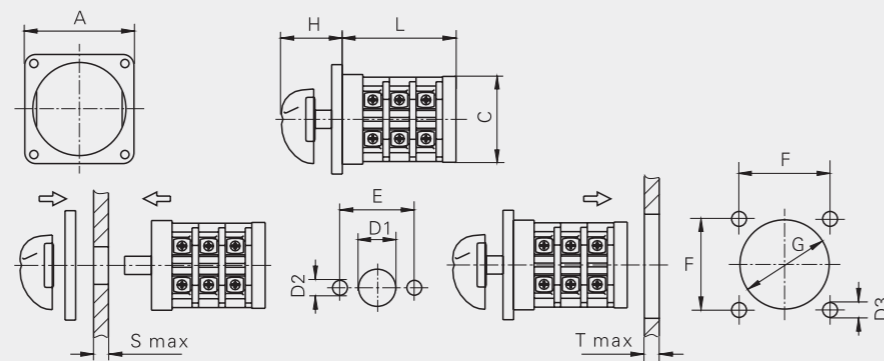

Description	Dimensions (mm)							Installation (mm)				
	A	C	H	L	E	D1	D2	S	F	G	D3	T
LW31B-16	□52	∅46.5	30max	27+12n	28	∅10	∅4	1.5	35	∅47	∅4.5	6

Re: n for number of layers.

LW40 Series Rotary Switch

Introduction

Introduction

LW40 series rotary switch use for alternating current 50Hz, voltage to 690V or direct voltage to 440V and the electrical equipment like numerical control machine. To control, to illuminate, to protect, to measure. And also can be used to control the small capacity squirrel cage electric motors.

Designation

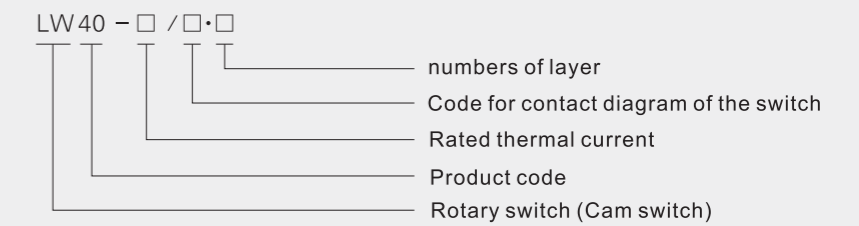

Combination operating mode and rotation angle of actuator.

Operating Mode	Code	Rotation angle of actuator			
Auto-reset type	A	0°~30°	0°~45°	0°~60°	0°~90°
	B	30°~0°~30°	45°~0°~45°	60°~0°~60°	90°~0°~90°
Location type	C	0° 30°	0° 45°	0° 60°	
	D	30° 0° 30°	45° 0° 45°	60° 0° 60°	
	E	30° 0° 30° 60°	45° 0° 45° 90°	60° 0° 60°120°	
	F	60° 30° 0° 30° 60°	90° 45° 0° 45° 90°	60° 0° 60°120°180°	
	G	60° 30° 0° 30° 60° 90°	90° 45° 0° 45° 90°135°	120°60° 0° 60°120°180°	
	H	90° 60° 30° 0° 30° 60° 90°	135°90° 45° 0° 45° 90°135°		
	I	90° 60° 30° 0° 30° 60° 90° 120°	135°90° 45° 0° 45° 90°135°180°		
	J	120° 90° 60° 30° 0° 30° 60° 90° 120°			
	K	120° 90° 60° 30° 0° 30° 60° 90° 120° 150°			
	L	150°120° 90° 60° 30° 0° 30° 60° 90° 120° 150°			
	M	150°120° 90° 60° 30° 0° 30° 60° 90° 120° 150° 180°			
	N		45° 45°	30°30°	
	P				90° 0° 90°
	T				0° 90°
V				90° 0°	
R				270° 0° 90° 180°	
Mixed type	Q	30° 0°~30°	45° 0°~45°		
	S	30°~0° 60°	90° 0°~45°		
	W		90°~45° 0° 45°~90°		
	Z	120°~90° 0°~30°	135°~90° 0°~45°		

LW40 Series Rotary Switch

Technical parameters

Description	LW40-20	LW40-25	LW40-32	Mechanical life
Rated thermal current I _{th} A	20	25	32	Mechanical life without load: 0.3 × 10 ⁶ times, operation frequency is 120 times/h. Mechanical life with load: 0.05 × 10 ⁶ times operation frequency is 120 times/h.
Rated working voltage U _e V	440	440	440	
Rated working current I _e				
AC-23A A	15	20	25	
AC-3 A	11	15	18	

Dimensions and installation

Escutcheon plate installation

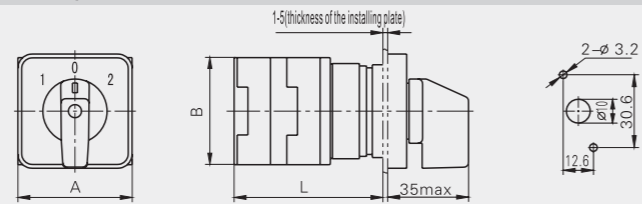

Description	Dimensions	A	B	L
LW40-20		52	52	37+9.5n
LW40-25		61	54.5	38+11.5n
LW40-32		61	54.5	38+11.5n

Single hole installation

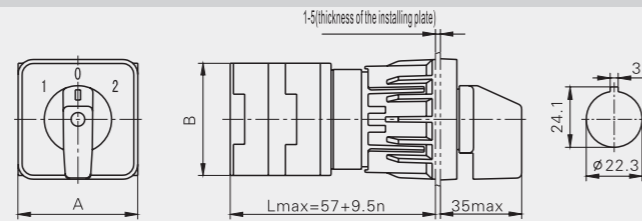

Description	Dimensions	A	B	L
LW40-20		52	52	57+9.5n
LW40-25		61	54.5	58+11.5n
LW40-32		61	54.5	58+11.5n

Key Installation

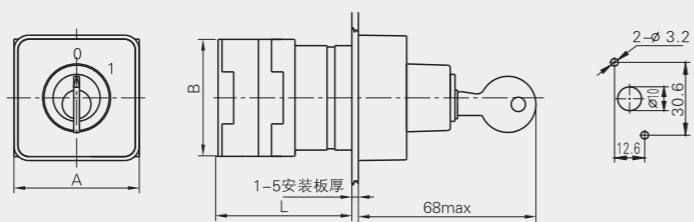

Description	Dimensions	A	B	L
LW40-20		52	52	37+9.5n
LW40-25		61	54.5	38+11.5n
LW40-32		61	54.5	38+11.5n

Pad-lock installation

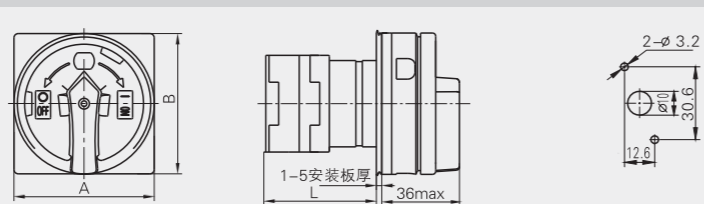

Description	Dimensions	A	B	L
LW40-20		65	65	37+9.5n
LW40-25		65	65	38+11.5n
LW40-32		65	65	38+11.5n

Re: n for number of layers.

KDHc Series Electric Welding Machinery Switch

Introduction

The KDHc electric welding machine switch applied to AC 50Hz or 60Hz, 440V and below, 200A and below, for control of welding machine and control of main circuits as well.

The product complies with GB 14048.3, JB/T 10498.

Working conditions

- (1) Ambient temperature DO NOT exceed 40°C, and DO NOT Less than -25°C, and the average temperature, measured over a period of 24 hours, DO NOT exceed 35°C.
- (2) Should not be installed over 2000m about sea level.
- (3) The switch should not change the circuit when the switch is working with load.
- (4) The humidity should not exceed 50% when the ambient temperature is 40°C, and higher humidity is allowed for lower temperature.
- (5) A clean environment was required.

Designation

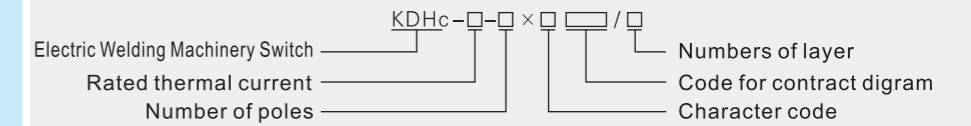

Classification

- (1) Classified by current ratings: 20A, 25A, 32A, 40A, 63A.
- (2) Classified by handle positions, there are 12 handle positions.
- (3) Classified by type of handle, R type, I type, B type.

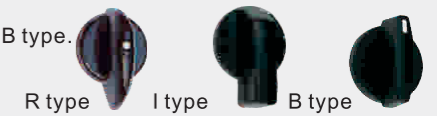

Technical parameters

Description	KDHc-20	KDHc-25	KDHc-32	KDHc-40	KDHc-63
Rated thermal current I _{th} A	20	25	32	40	63
Rated working voltage U _e V	240/440	240/440	240/440	240/440	240/440
Rated working current I _e					
AC-21A A	20	25	32	40	63
Operation					
Non-load	8500	8500	8500	8500	8500
Load	1500	1500	1500	1500	1500
Total	10 000	10 000	10 000	10 000	10 000
Operation frequency times/h	120	120	120	120	120

Dimensions and installation

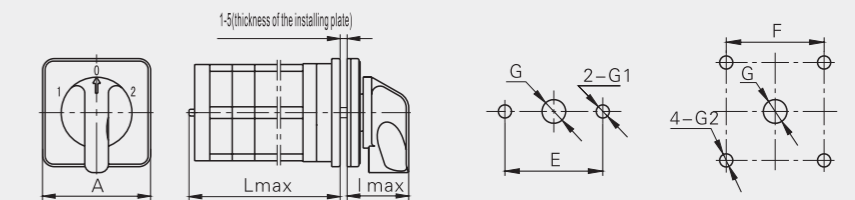

Description	Lmax	lmax	A	E	F	G	G1	G2
KDHc-20	25+12n	38	□48±0.31	32±0.16	□36±0.31	∅9.5	∅3.5	∅4.5
KDHc-25	34+13.3n	37	□64±0.37	36±0.31	□48±0.31	∅9.5	∅4.5	∅4.5
KDHc-32	34+13.3n	37	□64±0.37	36±0.31	□48±0.31	∅9.5	∅4.5	∅4.5
KDHc-40	34+17.5n	37	□64±0.37	36±0.31	□48±0.31	∅9.5	∅4.5	∅4.5
KDHc-63	34+17.5n	37	□64±0.37	36±0.31	□48±0.31	∅9.5	∅4.5	∅4.5

KDHc-20

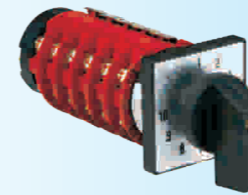

KDHc-25



KDHc-32

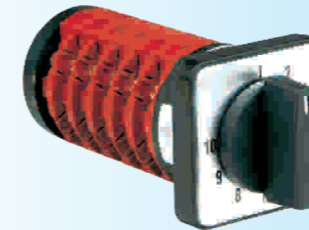

KDHc-40

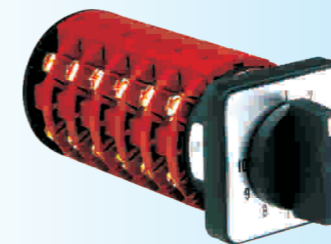

KDHc-63

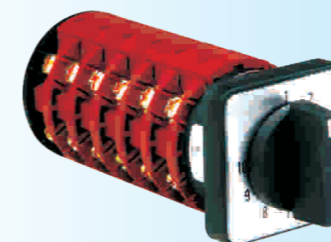

KDHs Series Electric Welding Machinery Switch

Introduction

The KDHs-160, 200 series change-over switch is applied to AC/DCI welder and argon arc welder for change-over of electric circuits.

The product complies with GB 14048.3

Working conditions

- (1) Ambient temperature DO NOT exceed 40°C, and DO NOT Less than -25°C, and the average temperature, measured over a period of 24 hours, DO NOT exceed 35°C.
- (2) Should not be installed over 2000m about sea level.
- (3) The switch should not change the circuit when the switch is working with load.
- (4) The humidity should not exceed 50% when the ambient temperature is 40°C, and higher humidity is allowed for lower temperature.

Description

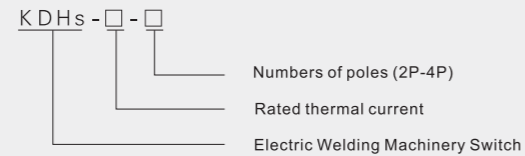

Technical parameters

Description	KDHs-160-□	KDHs-200-□
Rated volt	220V/380V	220V/380V
Rated current	160A	200A
Power-frequency with stand volt	4KV	4KV
Insulation resistance	100MΩ	100MΩ
Endurance (times)	1 × 10 ⁴	1 × 10 ⁴
Note	Appliance for 315 welding machine	Appliance for 500 welding machine

Dimensions and installation

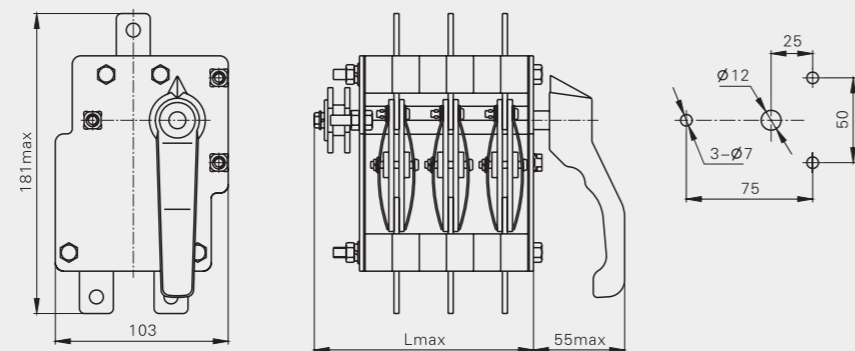

Description	Lmax (mm)
1 pole	70
2 pole	100
3 pole	130
4 pole	160

KDH Series Electric Welding Machinery Switch

Introduction

KDH series electric welding machinery switch used for the control of the main switch Bx3 series welding machine and for change over of coil turns, coil at the stalls, thus expanding the range of current regulation. Can also be used for other moving-coil transformers arc welding machine.

Technical parameters

Description	KDH-125	KDH-160	KDH-200
Rated thermal current I _{th} A	125	160	200
Operation	0.01 × 10 ⁶	0.01 × 10 ⁶	0.01 × 10 ⁶
Operation frequency times/h	120	120	120

Dimensions and installation

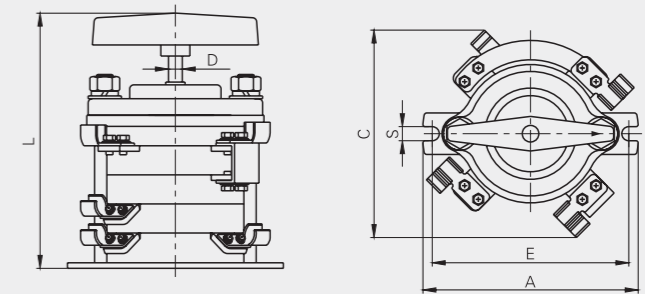

Description	Dimension(mm)					
	A	C	L	E	D	S
KDH-125	142	120	170	112	∅9	7
KDH-160	155	150	188	142	∅10	10
KDH-200	155	150	193	142	∅10	10

Contact diagrams

KDH-125 contact diagram

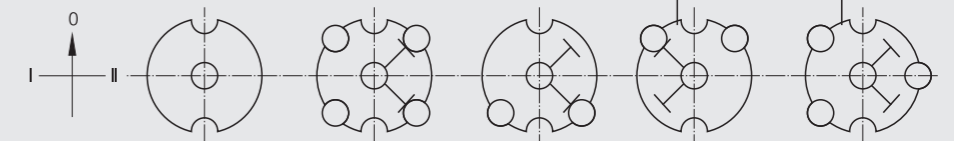

KDH-160, 200 contact diagram

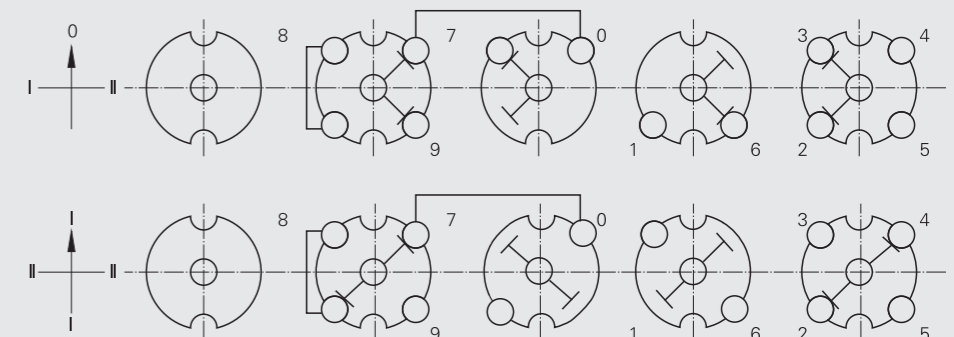

HZ10D-□ / E119 Series Electric Welding Machinery Switch

Introduction

HZ10D-□ / E119 Series Electric Welding Machinery Switch applied to welding machine for adjusting current of 100A and below, AC50Hz or 60Hz, rated voltage 380V and below, for the change of main circuit, auxiliary electrical appliances.



Technical parameters

Description	HZ10D-25/E119	HZ10D-63/E119	HZ10D-100/E119	HZ10D-100/E119A
Rated thermal current I _{th} A	25	63	100	100
Rated working voltage U _e V	240 440	240 440	240 440	240 440
Rated working current I _e A	25 25	63 63	100 100	100 100

Dimensions and installation

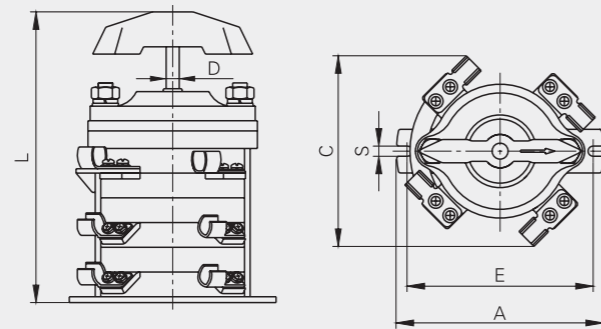

Description	Dimension(mm)					
	A	C	L	E	D	S
HZ10D-25/E119	100	90	140	90	∅8	6
HZ10D-63/E119	142	110	165	128	∅9	7
HZ10D-100/E119	142	128	210	128	∅9	7
HZ10D-100/E119A	142	128	188	128	∅9	7

Contact diagrams

HZ10D-□ / E119 Contact diagram

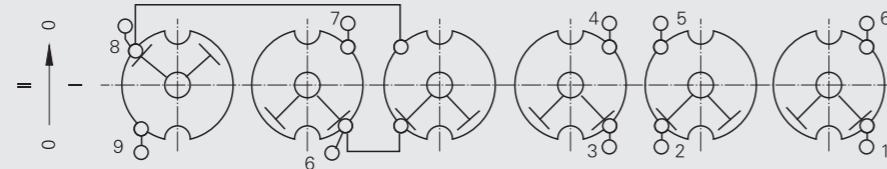

HZ10D-100/E119A Contact diagram

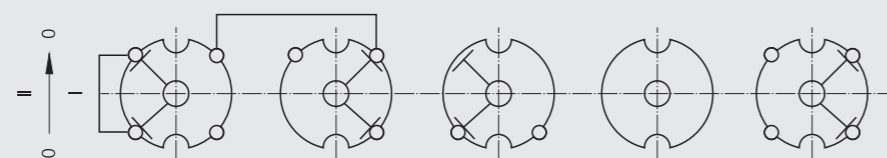

HJ-75/100 Series Adapter

Introduction

HJ-75/100 Series Adapter applied to the butt welder, spot welder, seam welding machine for the purposes of current adjusting. The product has three phase, and two current ratings, 75A and 100A. The product complies with GB14048.3



Technical parameters

Rated volt	~220V ~380V (50HZ)
Rated current	500A
Power-frequency with stand voltage	4KV
Insulation resistance	100MΩ
Endurance (times)	1 × 10 ⁴

Dimensions and installation

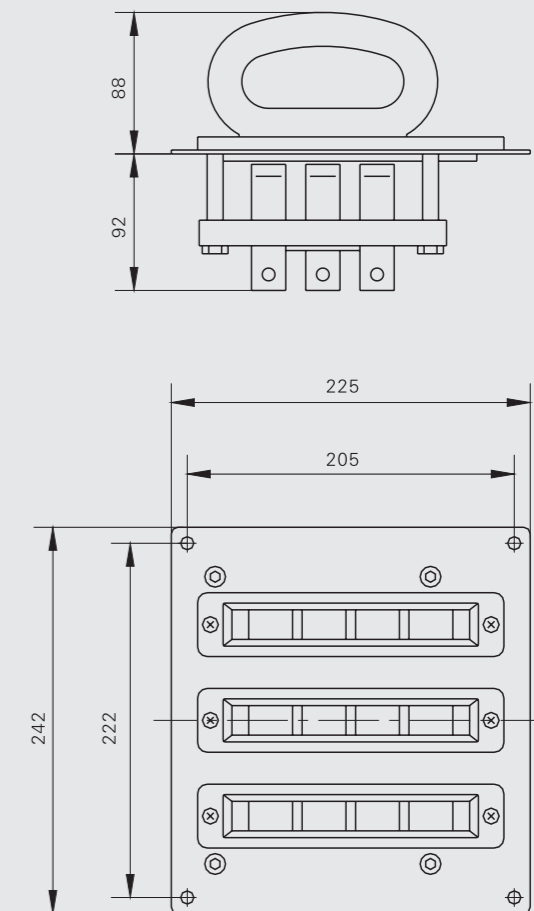

Input Joint Box Series

Introduction

The power input joint box is mainly used for fixing of power supply input connecting wire of various electric welder, with advantages of safety and reliability, the input joint box is classified into H model, D model by appearance, and 2-pole, 3-pole, 4-pole by pole number.

Dimensions and installation

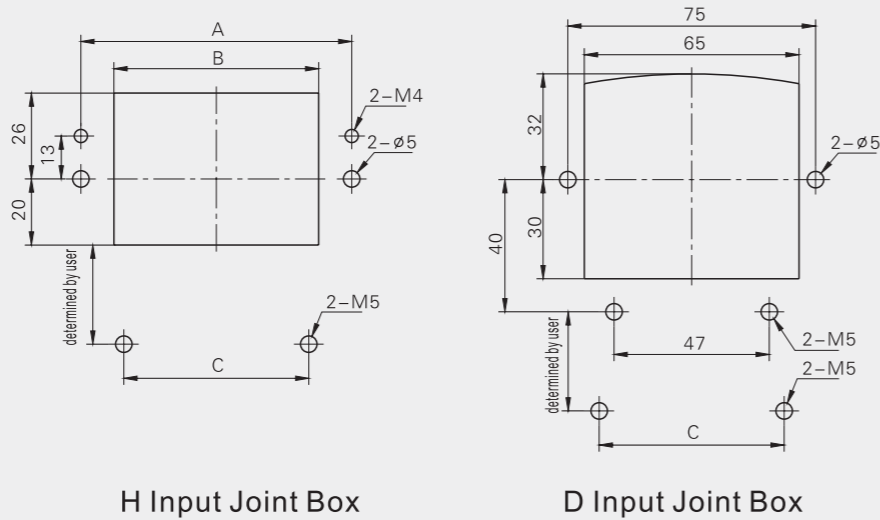

H model 2 pole

H model 3 pole

D model 2 pole

D model 3 pole

Description	A	B	C
H model two-pole	82	62	56
H model three-pole	92	70	72
H model four-pole	96	76	

Installation pitch of champ

Description	C (mm)
single-hole	40
two-hole	56
three-hole	72

Output Terminal Block Series

Introduction

The output terminal block is used for fixing of power-supply output connecting wire of various electric welder, the output terminal block is classified into A, B, C type according to mode, classified into 300A, 500A, 630A, 800A, 1000A according to current, classified into red and black according to color.

Description	Current A	
A model	300	500
B model	500	630
C model	630	800 1000

Dimensions and installation

A model dimensions and installation of output terminal blocks

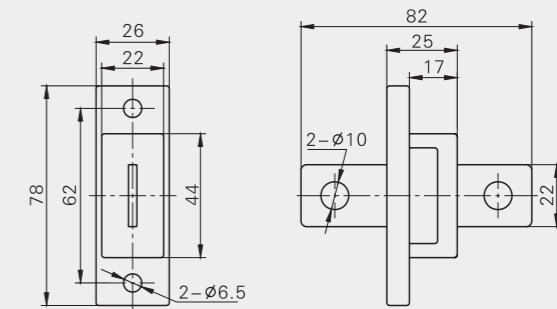

B model dimensions and installation of output terminal blocks

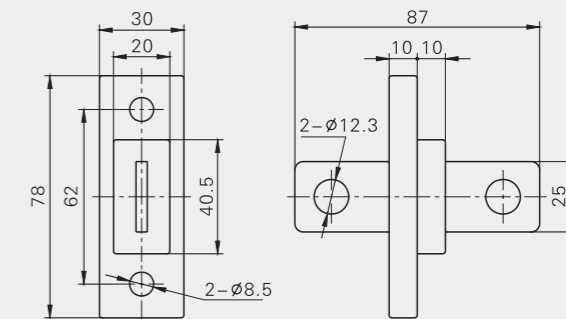

C model dimensions and installation of output terminal blocks

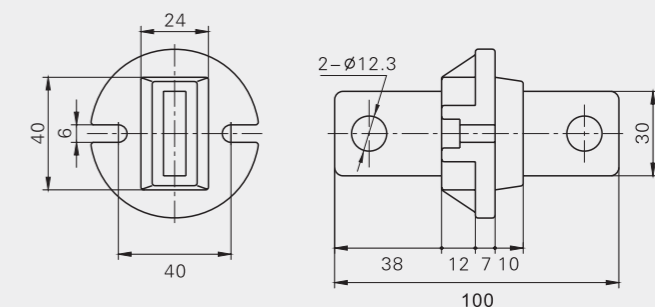

A model

B model

B model

LW2D Series Rotary Switch

Introduction

LW2D applied to change over of circuits, also for control of electrical measuring instruments and control of motors.

Technical parameters

Rated thermal current I _{th}	A	10	
Rated working voltage U _e	V	240	250
Rated working current I _e			
AC-15 Double breakpoint	A	2	
AC-15 Single breakpoint	A	1	
DC-13 Double breakpoint	A		1.1
DC-13 Single breakpoint	A		0.5

Mechanical life

Mechanical life without load: 0.03x10⁶ times, operation frequency is 120 times/h

Mechanical life with load: AC-15, 0.01x10⁶ times operation frequency is 300 times/h
DC-13, 0.01x10⁶ times operation frequency is 300 times/h

Dimensions and installation

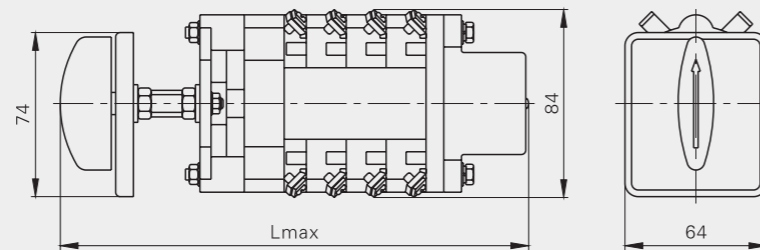

Spring return : L_{max}=130+18n (n for number of layers)

Others : L_{max}=141+18n (n for number of layers)

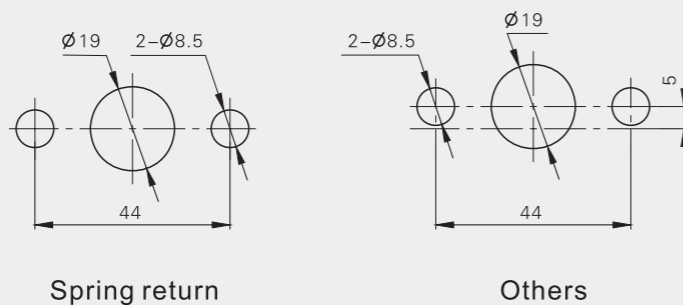

Spring return

Others

LW5D Series Rotary Switch

Introduction

LW5D applied to change over of circuits, also for control of starting and running, start and reserving and speed change of motors.

Technical parameters

Uses	Master Control	Direct control motor
Rated thermal current I _{th}	A	16
Rated working voltage U _e	V	125 220 250 380 400 500
Rated working current I _e		
AC-15	A	4.6 2.6 2.0
AC-3	A	
AC-4	A	
DC-13 Double breakpoint	A	0.55 0.27 0.14
DC-13 Four breakpoint	A	0.82 0.41 0.20

Mechanical life

Mechanical life without load: 0.3x10⁶ times, operation frequency is 300 times/h

Mechanical life with load: AC-15, DC-13: 0.1x10⁶ times operation frequency is 300 times/h
AC-3, 0.1x10⁶ times operation frequency is 120 times/h
AC-4, 0.1x10⁶ times operation frequency is 120 times/h

Operation	Character code	Position of handle
Auto-reset type	A	0° → 45°
	B	45° → 0° → 45°
	C	0° 45°
	D	45° 0° 45°
Position type	E	45° 0° 45° 90°
	F	90° 45° 0° 45° 90°
	G	90° 45° 0° 45° 90° 135°
	H	135° 90° 45° 0° 45° 90° 135°
	I	135° 90° 45° 0° 45° 90° 135° 180°
	J	120° 90° 60° 30° 0° 30° 60° 90° 120°
	K	120° 90° 60° 30° 0° 30° 60° 90° 120° 150°
	L	150° 120° 90° 60° 30° 0° 30° 60° 90° 120° 150°
	M	150° 120° 90° 60° 30° 0° 30° 60° 90° 120° 150° 180°
	N	45° 45°
	P	90° 0° 90°

Dimensions and installation

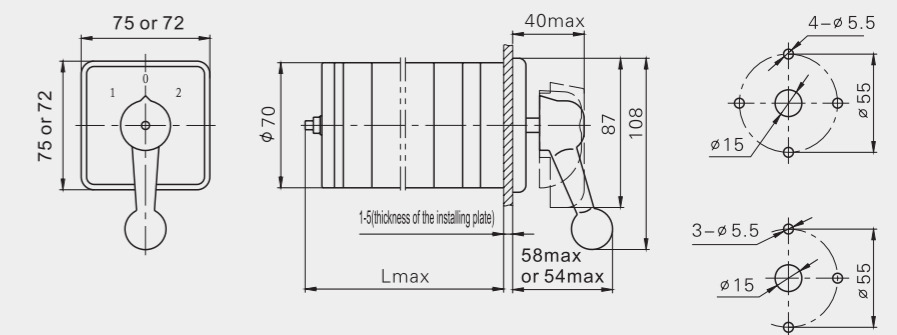

Location type: L_{max} + 40max(Knob), L_{max} + 58max(Handle)
L_{max}=44 + 16n(n for number of layers)
Auto-reset type: L_{max} + 40max(Knob), L_{max}+58max(Handle)
L_{max}=48 + 16n(n for number of layers)

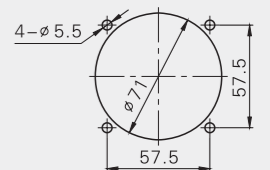

LW6D Series Rotary Switch

Introduction

LW6D applied to machine tool for control and change over of circuits, also for change over of circuits in other equipments.

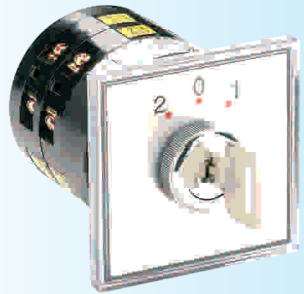

Technical parameters

Rated thermal current I _{th} A	5		
Rated working voltage U _e V	220	250	380
Rated working current I _e			
AC-15 A	1.5	0.95	
DC-13 A	0.55		

Mechanical life

Mechanical life without load: 0.3×10^6 times, operation frequency is 120 times/h

Mechanical life with load: AC-15, 0.1×10^6 times operation frequency is 300 times/h
DC-13, 0.1×10^6 times operation frequency is 300 times/h

Character code	Position of handle											
A	0° 30°											
B	30° 0° 30°											
C	30° 0° 30° 60°											
D	60° 30° 0° 30° 60°											
E	60° 30° 0° 30° 60° 90°											
F	90° 60° 30° 0° 30° 60° 90°											
G	90° 60° 30° 0° 30° 60° 90° 120°											
H	120° 90° 60° 30° 0° 30° 60° 90° 120°											
I	120° 90° 60° 30° 0° 30° 60° 90° 120° 150°											
J	150° 120° 90° 60° 30° 0° 30° 60° 90° 120° 150°											
K	210° 240° 270° 300° 330° 0° 30° 60° 90° 120° 150° 180°											

Dimensions and installation

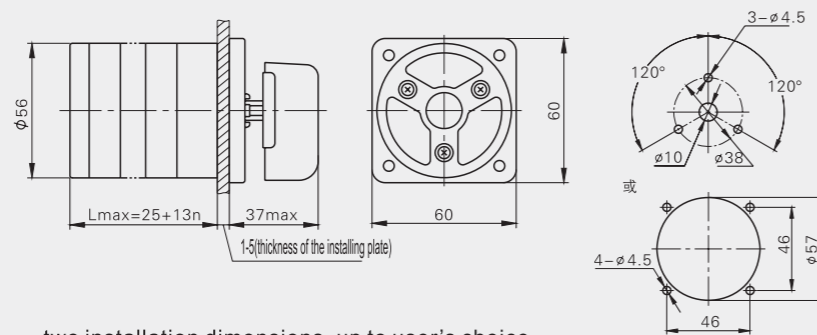

two installation dimensions, up to user's choice

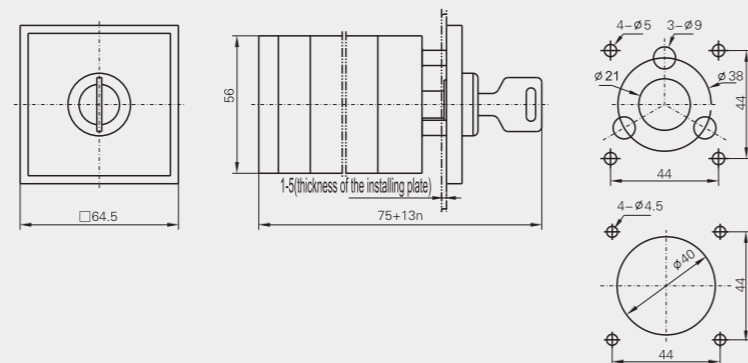

Re: n for number of layers.

LW8D Series Rotary Switch

Introduction

LW8D applied to change over of circuits, also for control of electrical measuring instruments and control of motors.

Technical parameters

Description	LW8D-10			LW8D-20		
Rated thermal current I _{th} A	10			20		
Rated working voltage U _e V	240	250	380	240	250	380
Rated working current I _e						
AC-3 A	1.6	0.95		4.6	2.6	
DC-13 A	0.14			0.27		

Mechanical life

Mechanical life without load: 0.3×10^6 times, operation frequency is 120 times/h

Mechanical life with load: AC-15, 0.1×10^6 times operation frequency is 300 times/h
DC-13, 0.1×10^6 times operation frequency is 300 times/h

Dimensions and installation

Square escutcheon plate

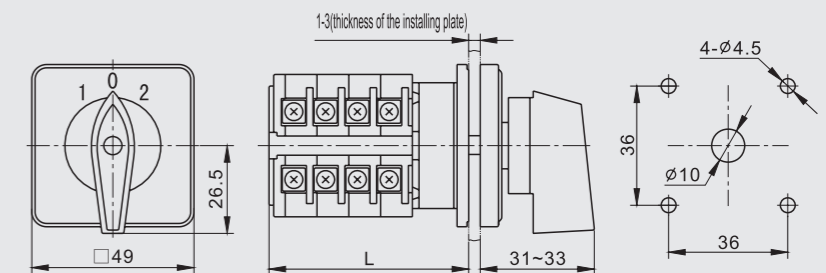

Round escutcheon plate

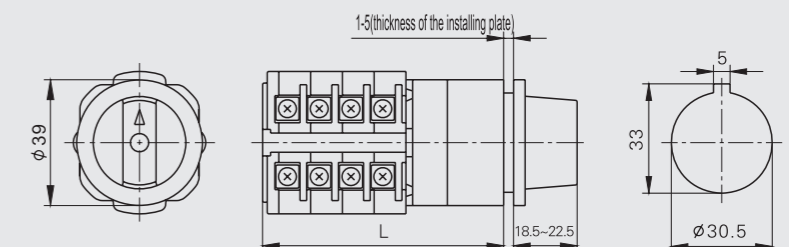

Description	L (mm)	
	Square escutcheon plate	Round escutcheon plate
LW8D-10	22+10n	35+10n
LW8D-20	22+13n	35+13n

Re: n for number of layers.

LW12 Series Rotary Switch

Introduction

LW12 applied to change over of circuits, also for control of electrical measuring instruments and control of motors.

Use as control switches

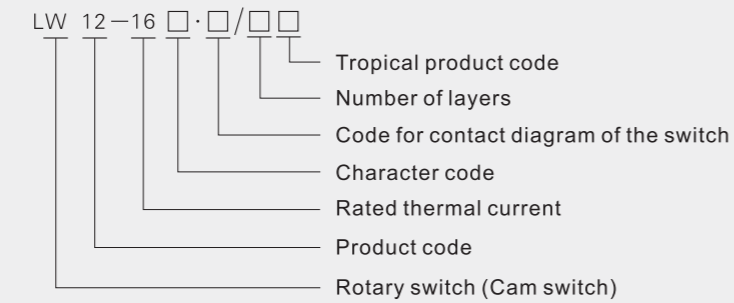

Re: Tropical product code: TH or TA.

Use as motor switch

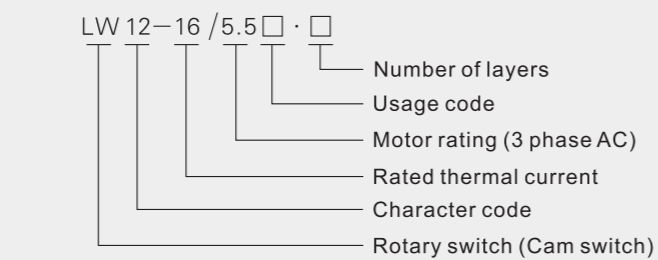

Re: Usage code: (1) Q1 for start and run 2 layers (2) Q2 for start and run 3 layers (3) N for start and reversing (4) S start and run for 2 speed (5) SN for start and reversing of 2 speed motor

Technical parameters

Rated insulation voltage	U _i V	500	
Rated thermal current	I _{th} A	16	
Rated working voltage	U _e V	220	380
Rated working current	I _e A		
AC-15	A	4.6	2.6
DC-13	A	0.27	
AC-3	A	12	
AC-4	A	12	

Mechanical life

Mechanical life without load: 0.3x10⁶ times, operation frequency is 300 times/h

Mechanical life with load: AC-15, DC-13: 0.1x10⁶ times operation frequency is 300 times/h
AC-3, 0.1x10⁶ times operation frequency is 120 times/h
AC-4, 0.1x10⁶ times operation frequency is 120 times/h

LW12 Series Rotary Switch

Dimensions and installation

Limited movement

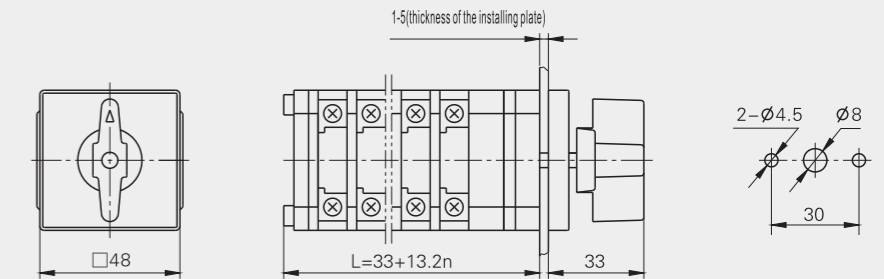

Spring return and limited movement with spring return

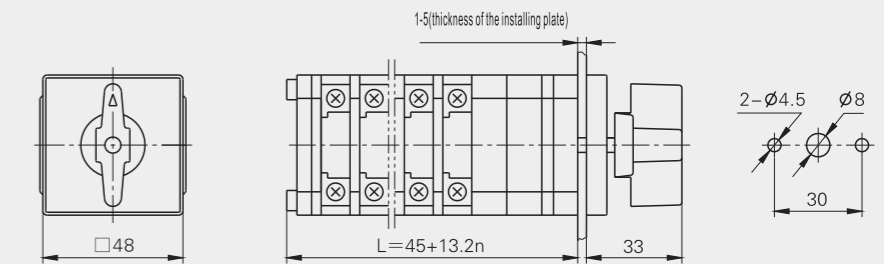

Limited movement with spring return and 45° free space

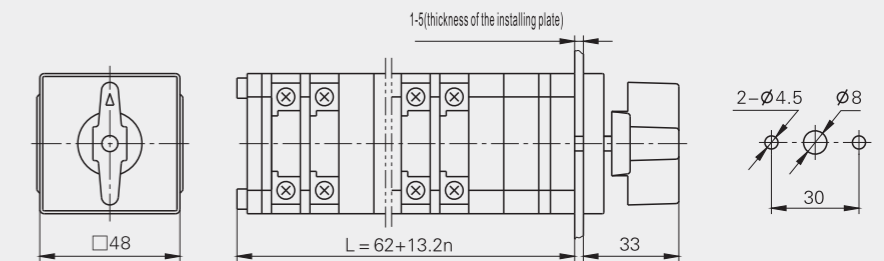

Limited movement with key lock

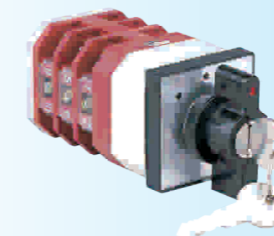
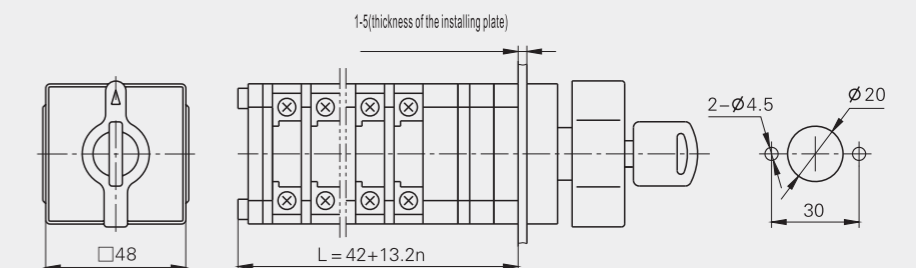

LW12 Series Rotary Switch

Dimensions and installation

Limited movement with spring return and key lock

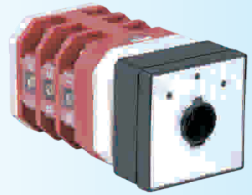
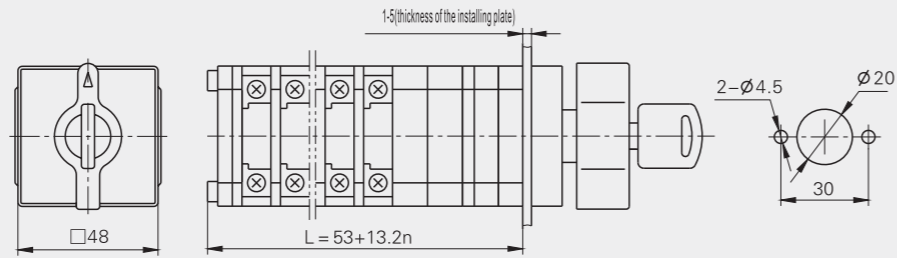

Y type

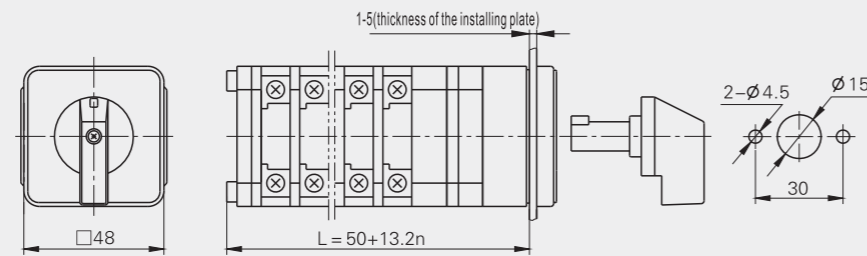

Limited movement with indicator

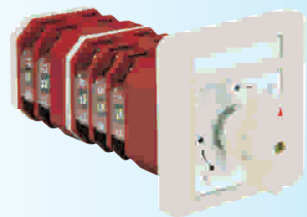
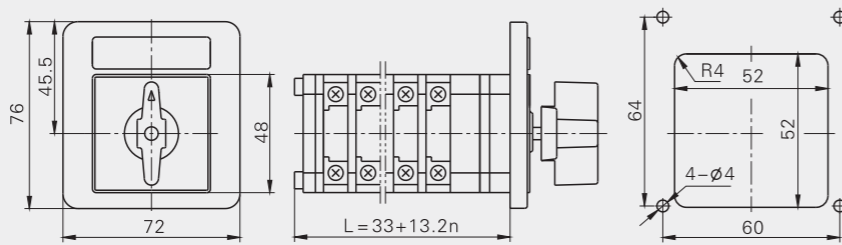

Spring return with indicator and limited movement with spring return

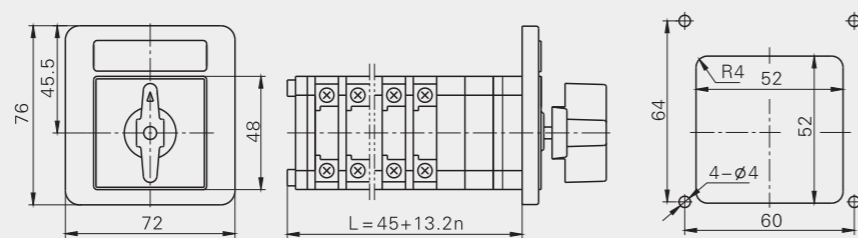

LW12 Series Rotary Switch

Dimensions and installation

45° free space limited movement with spring return, and indicating light

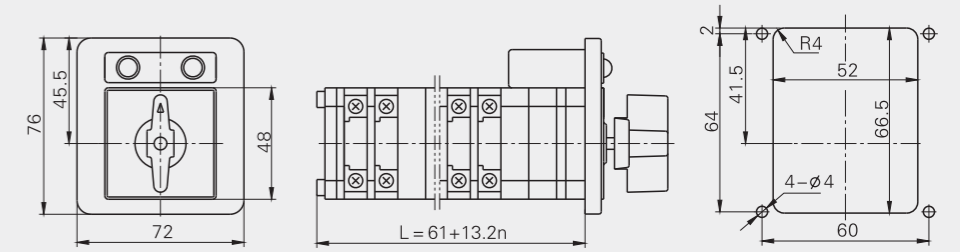

spring return with key-lock and indicating light, limited movement with spring return and key-lock and indicating light

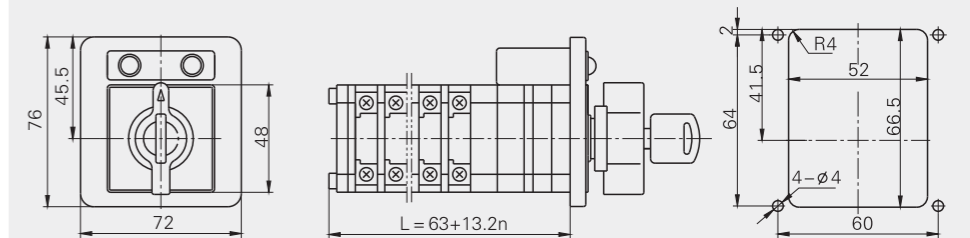

45° free space limited movement with spring return, key-lock and indicating light

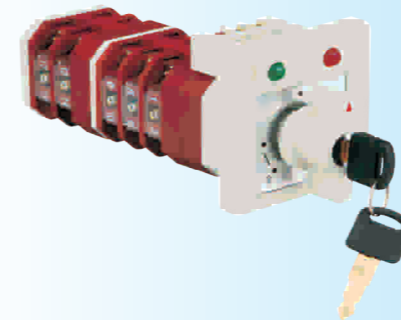
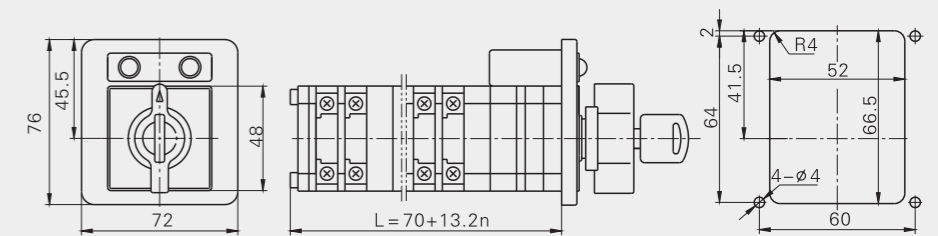

Re: n for number of layers.

LW15 Series Rotary Switch

Introduction

LW15 applied to change over of circuits, also for direct control of motors.



Technical parameters

Description		LW15-16		
Rated thermal current I _{th}		16		
Rated working voltage U _e	V	240	250	380
Rated working current I _e				
AC-15	A	6	6	
DC-13	A	0.27		
AC-3	A	12		
AC-4	A	10		
Power P				
AC-3	kW	5.5		
AC-4	kW	4.5		

Mechanical life

Mechanical life without load: 0.3x10⁶ times, operation frequency is 300 times/h

Mechanical life with load: AC-15, DC-13: 0.1x10⁶ times operation frequency is 300 times/h
AC-3, 0.1x10⁶ times operation frequency is 120 times/h
AC-4, 0.1x10⁶ times operation frequency is 120 times/h

Dimensions and installation

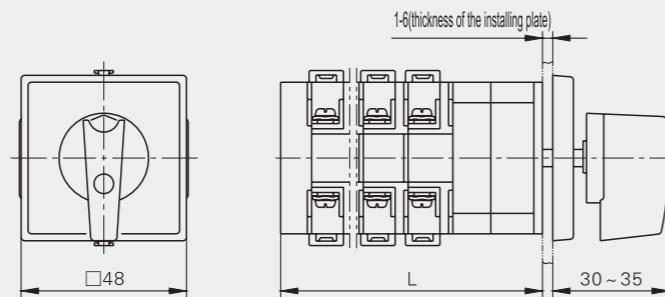

Limited movement: $L=35+13n$ (n for number of layers)

Spring return: $L=31.5+13n$ (n for number of layers)

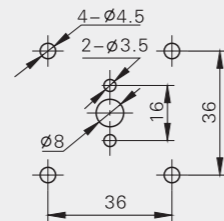

LW26D Series Rotary Switch

Introduction

LW26D applied to control of machine, for change over of circuits, as well as other circuits where a change over of circuits are required.

The LW26D has finger prove terminals, which provides extra protections.

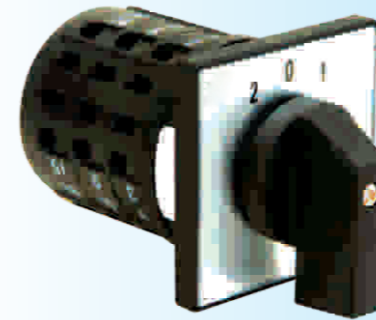

Technical parameters

Rated thermal current I _{th}	A	10	
Rated working voltage U _e	V	240	380
Rated working current I _e			
AC-15	A	2.5	1.5
DC-13	A	0.27	

Mechanical life

Mechanical life without load: 0.3x10⁶ times, operation frequency is 300 times/h

Mechanical life with load: AC-15, DC-13: 0.1x10⁶ times operation frequency is 300 times/h

特征代号	操 动 器 位 置
A	0° 30°
B	30° 0° 30°
C	30° 0° 30° 60°
D	60° 30° 0° 30° 60°
E	60° 30° 0° 30° 60° 90°
F	90° 60° 30° 0° 30° 60° 90°
G	90° 60° 30° 0° 30° 60° 90° 120°
H	120° 90° 60° 30° 0° 30° 60° 90° 120°
I	120° 90° 60° 30° 0° 30° 60° 90° 120° 150°
J	150° 120° 90° 60° 30° 0° 30° 60° 90° 120° 150°
K	210° 240° 270° 300° 330° 0° 30° 60° 90° 120° 150° 180°

Dimensions and installation

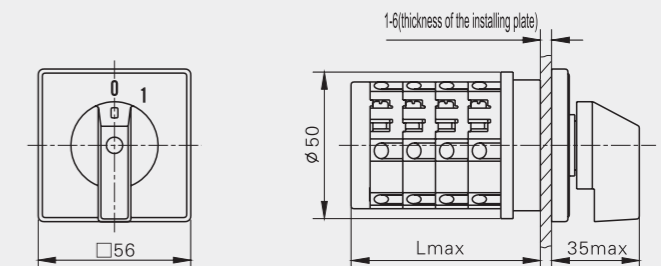

$L_{max}=25+12n$ (n for number of layers.)

two installation dimensions, up to user's choice

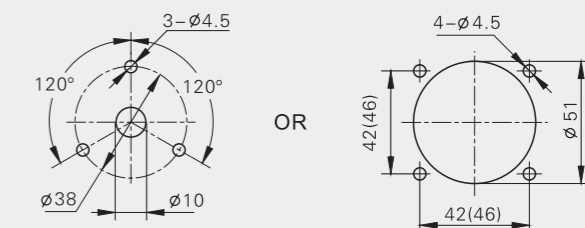

LWX1 LWX1B Series Rotary Switch

Introduction

LWX1, LWX1B applied to electrical equipment, and various power distribution equipment for remote control, as well as for control of instruments, and control of motors.

Technical parameters

Description		LWX1	LWX1B
Rated thermal current I _{th} A		5	5
Rated working voltage U _e V		220	220
Rated working current I _e			
AC-15 A		0.5	0.5
DC-13 A		0.24	0.24

Mechanical life

Mechanical life without load: 0.1×10^6 times, spring return is 0.05×10^6 times, operation frequency is 120 times/h

Mechanical life with load: AC-15: 0.03×10^6 times operation frequency is 120 times/h
DC-13: 0.01×10^6 times operation frequency is 120 times/h

Dimensions and installation

LWX1

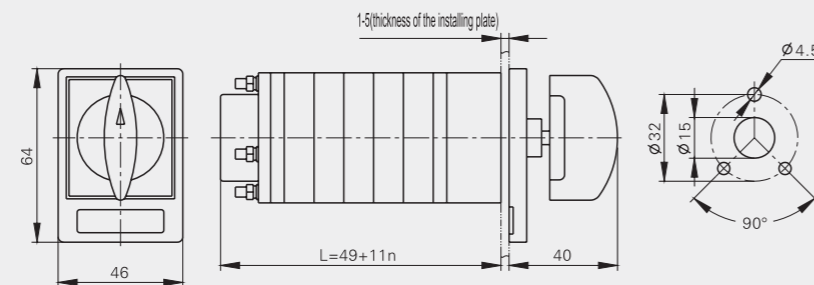

LWX1B

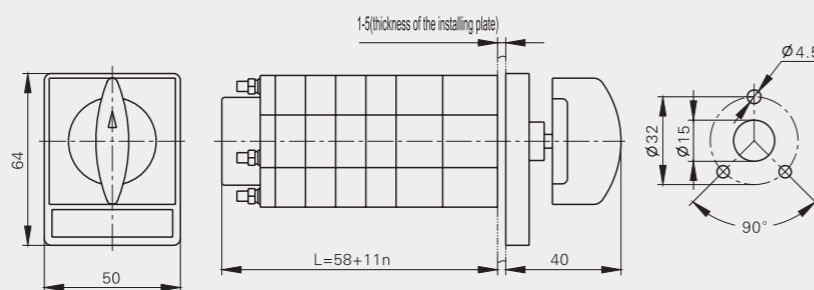

Re: n for number of layers.

HZ5D Series Combination Switch

Introduction

HZ5D mainly used to the electrical circuit as the power switch, and as a kind of switch for controlling of motor, also change over of electrical circuits.

Technical parameters

Description		HZ5D-10	HZ5D-20	HZ5D-40
Rated working voltage U _e V		440	440	440
Rated thermal current I _{th} A		10	20	40
Rated working current I _e A		4	8	16
Power P kW		1.7	4	7.5

Mechanical life

Mechanical life without load: 0.1×10^6 times, operation frequency is 120 times/h

Mechanical life with load: AC-23A: 0.03×10^6 times operation frequency is 120 times/h
AC-3: 0.03×10^6 times operation frequency is 120 times/h
AC-4: 0.03×10^6 times operation frequency is 120 times/h

Dimensions and installation

HZ5D-10

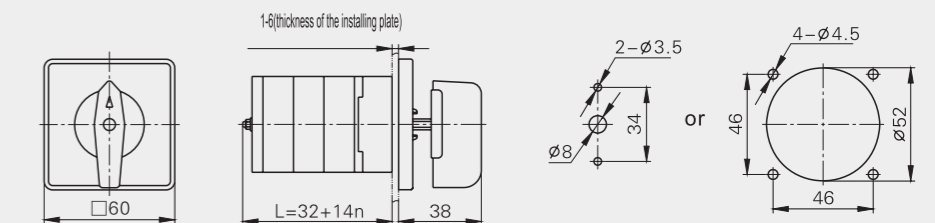

HZ5D-20

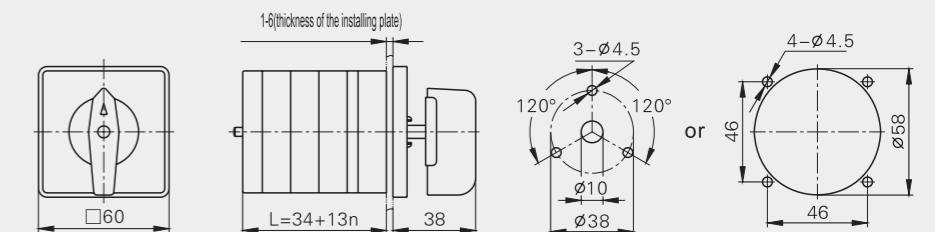

Re: n for number of layers.

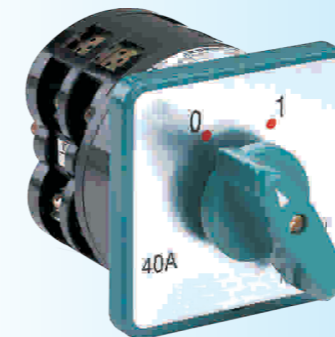
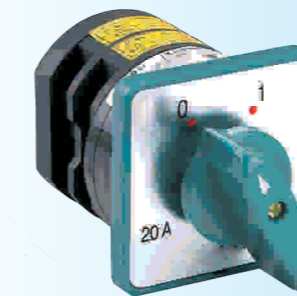
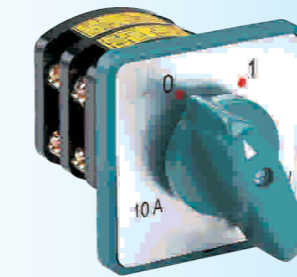

HZ5D Series Combination Switch

Dimensions and installation

HZ5D-40

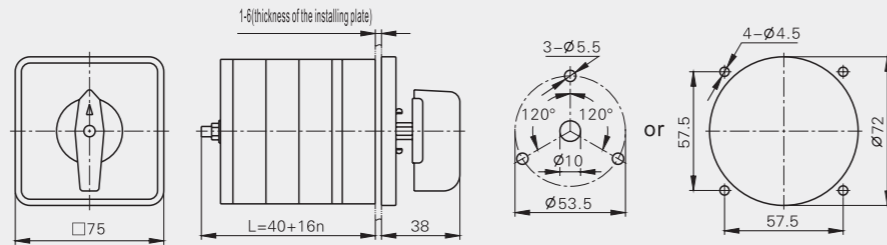

HZ5D-20GSA

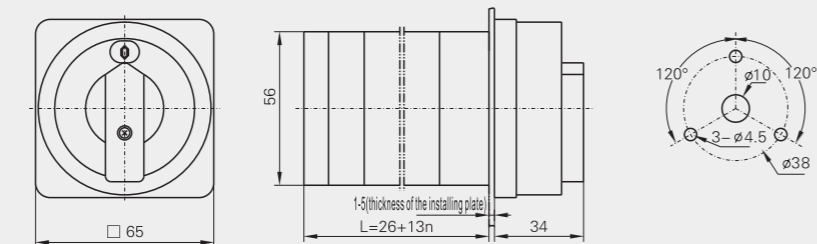

HZ5D-20GSB

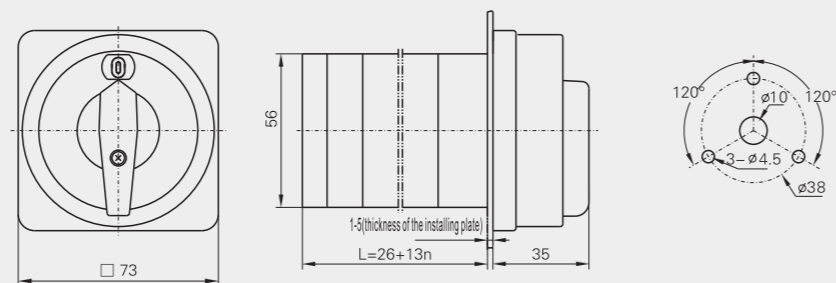

HZ5D-40GSB

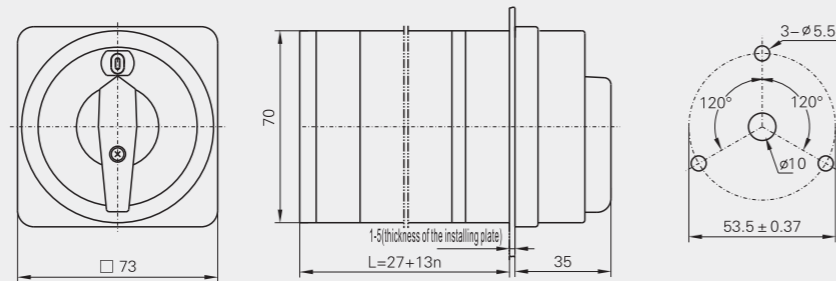

Re: n for number of layers.



HZ5B Series Combination Switch

Introduction

HZ5B is the improved HZ5D, applied to control of motors.

Technical parameters

Rated thermal current	I _{th} A	10
Rated working voltage	U _e V	440
Rated working current	I _e A	10
Power	P kW	1.7

Dimensions and installation

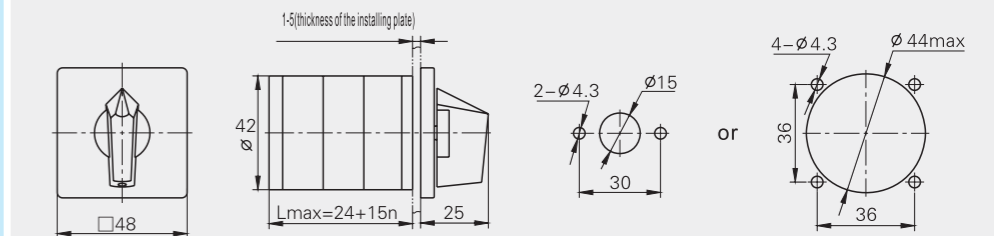

Re: n for number of layers.

HZ5BGS-10 Series Pad-lock Type Switch

Introduction

HZ5BGS is the improved HZ5D, applied to control of motors.

Technical parameters

Rated thermal current	I _{th} A	10
Rated working voltage	U _e V	440
Rated working current	I _e A	10
Power	P kW	1.7
Operation	AC-22A	
Non-load		8500
Load		1500
Total		10 000

Dimensions and installation

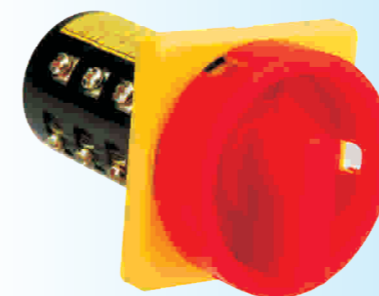
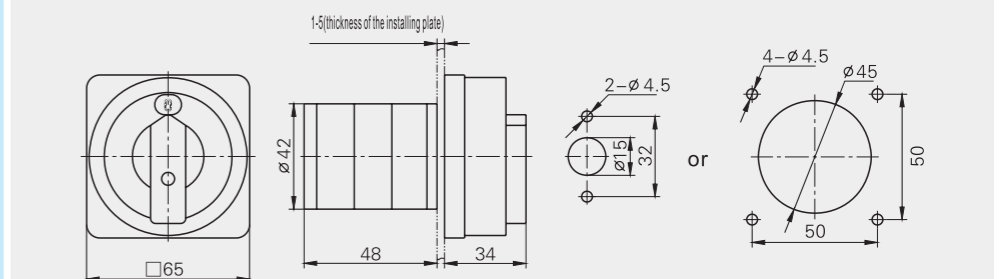

HZ10D Series Combination Switch

Introduction

HA10D mainly used in the circuit for unfrequent manual closing, breaking resistive and inductive mixed load, also for the control of AC motors.

Technical parameters

Description		HZ10D-10	HZ10D-16	HZ10D-25	HZ10D-63	HZ10D-100
Rated thermal current I _{th}	A	10	16	25	63	100
Rated working voltage U _e	V	240 440	240 440	240 440	240 440	240 440
Rated working current I _e						
AC-3	A	3	4.3	6.3		
AC-20A/21A/22A	A	10	16	25	63	100
DC-20A/21A	A	10	16	25	63	100
Power P	kW	1.1	1.5	2.2		
Operation AC-22A						
Non-load		8500	8500	8500	8500	8500
Load		1500	1500	1500	1500	1500
Total		10000	10000	10000	10000	10000

Dimensions and installation

Before board

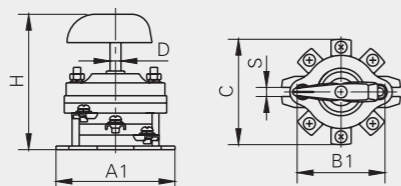

HZ10D-10~25 Behind board

HZ10D-63~100 Behind board

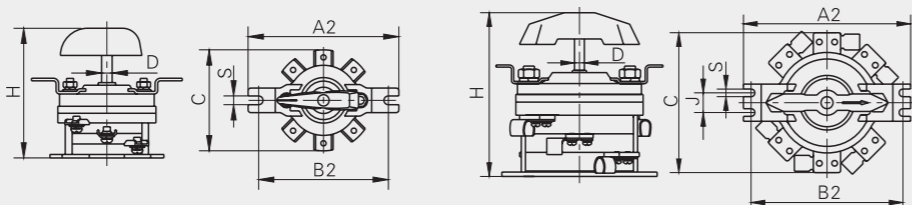

Description	Dimensions (mm)					Installation (mm)			
	A1	A2	H	D	C	B1	B2	S	J
HZ10D-10/1	65	86	62	∅6		55	74	5	--
HZ10D-10/2	65	86	68	∅6		55	74	5	--
HZ10D-10/3	65	86	74	∅6	~58	55	74	5	--
HZ10D-16/1	65	86	64	∅6		55	74	5	--
HZ10D-16/2	65	86	62	∅6		55	74	5	--
HZ10D-16/3	65	86	80	∅6	~63	55	74	5	--
HZ10D-25/2	100	114	98	∅8		90	100	6	--
HZ10D-25/3	100	114	108	∅8	~92	90	100	6	--
HZ10D-63/2	142	153	129	∅9		128	139	7	18
HZ10D-63/3	142	153	144	∅9	~154	128	139	7	18
HZ10D-100/3	142	153	152	∅9	~128	128	139	7	18

HZ10D-10



HZ10D-16



HZ10D-25



HZ10D-63

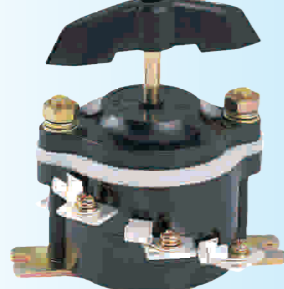

HZ10D-100



HZ12 Series Combination Switch

Introduction

HZ12 series combination switch have basic type, GS pad-lock type, Key lock type, Inter lock type. Every type has normal and quick stop type. Normal type use black plate and black knob. Quick stop use the yellow plate and red knob.

Classification, model and code

The basic type is for controlling the normal circuit.

Normal code for basic type:

HZ12-16/01, HZ12-25/01, HZ12-40/01

Normal code for quick stop type:

HZ12-16/02, HZ12-25/02, HZ12-40/02

The product dimension of 25A and 40A is the same

The installation dimension of 16A, 25A and 40A is the same

There is a terminal protection for all type

The GS type switch applies to machine which requires a pad lock control on the switch

It enables the user to put a pad lock in breaking (0) position and closing (1) position

Normal code for quick stop switch:

HZ12-16/04, HZ12-25/04, HZ12-40/04

The key lock type switch applies to machine which requires a key control on the switch

It locks the switch on breaking (0) position

Normal code for key lock type switch:

HZ12-16/05, HZ12-25/05, HZ12-40/05

HZ12-□/01



HZ12-□/02



HZ12-□/03



HZ12-□/04



HZ12-□/05



HZ12 Series Combination Switch

Classification, model and code

The GS inter lock type switch applies to machine which require pad lock control and together with a door inter lock.

Normal code of GS inter lock switch:

HZ12-16/08, HZ12-25/08, HZ12-40/08

The power must be turned off before opening the switch gear
And the inter lock release the switch once the door is opened,
and restore when the door is closed.

The key inter lock type switch applies to machine which requires key control and together with a door inter lock.

Normal code for key inter lock type switch:

HZ12-16/09, HZ12-25/09, HZ12-40/09

The power must be turned off before opening the switch gear
And the inter lock release the switch once the door is opened,
and restore when the door is closed.

Type of handle



Technical parameters

Description		HZ12-16		HZ12-25		HZ12-40	
Rated thermal current	I _{th} A	16		25		40	
Rated working voltage	U _e V	240	440	240	440	240	440
Rated working current	I _e						
	AC-3 A	11		15		30	
	AC-15 A	8	6	12	8	22	12
	AC-23 A	11		15		30	
	AC-21 A	16		25		40	

HZ12-□/06



HZ12-□/07

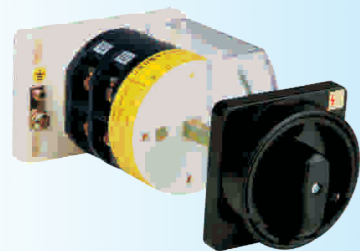

HZ12-□/08

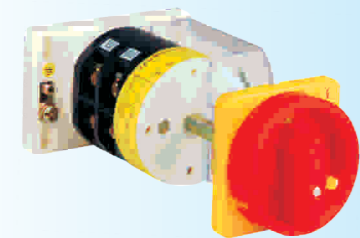

HZ12-□/09

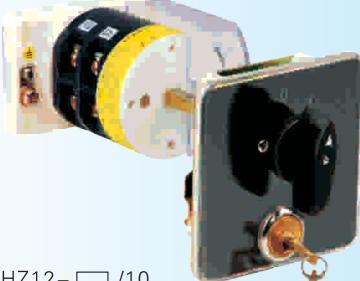

HZ12-□/10

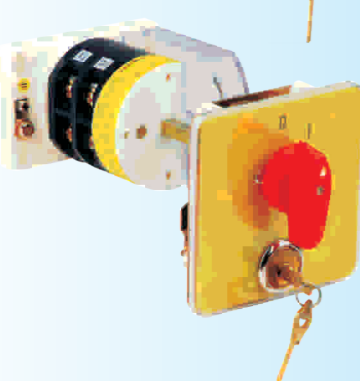

HZ12 Series Combination Switch

Dimensions and installation

HZ12-□/01、HZ12-□/02

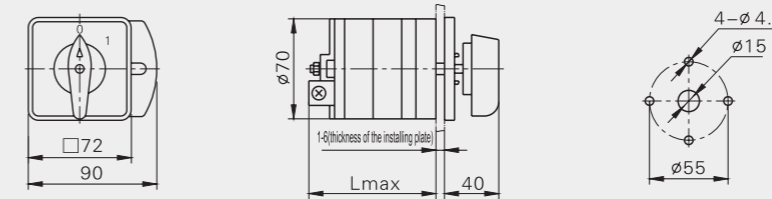

Description	Lmax (mm)
HZ12-16	86
HZ12-25	89
HZ12-40	89

HZ12-□/03、HZ12-□/04

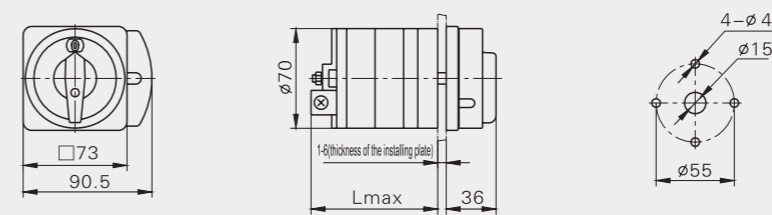

Description	Lmax (mm)
HZ12-16	86
HZ12-25	89
HZ12-40	89

HZ12-□/05、HZ12-□/06

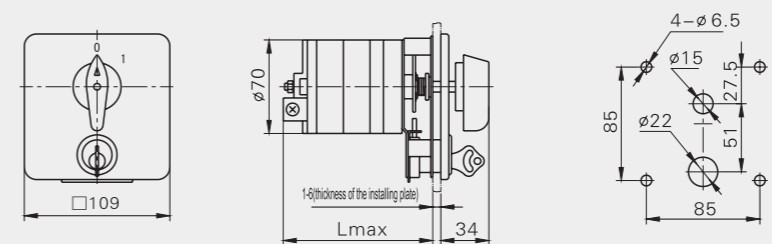

Description	Lmax (mm)
HZ12-16	107
HZ12-25	110
HZ12-40	110

HZ12-□/07.1~5、HZ12-□/08.1~5

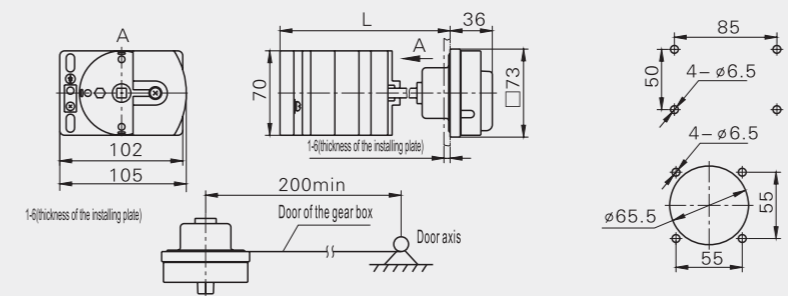

Description	Lmax (mm)
HZ12-□/07.1 HZ12-□/08.1	145~149
HZ12-□/07.2 HZ12-□/08.2	170~174
HZ12-□/07.3 HZ12-□/08.3	195~199
HZ12-□/07.4 HZ12-□/08.4	220~224
HZ12-□/07.5 HZ12-□/08.5	245~249

HZ12-□/09.1~5、HZ12-□/10.1~5

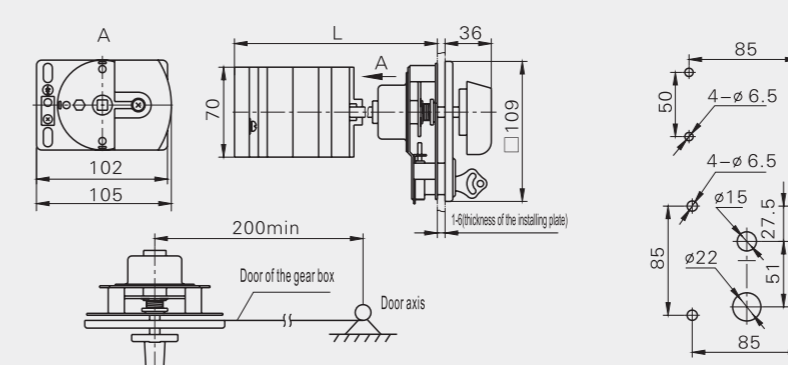

Description	Lmax (mm)
HZ12-□/09.1 HZ12-□/10.1	168~171
HZ12-□/09.2 HZ12-□/10.2	193~196
HZ12-□/09.3 HZ12-□/10.3	218~221
HZ12-□/09.4 HZ12-□/10.4	243~246
HZ12-□/09.5 HZ12-□/10.5	268~271

HZ25D Combination Switch

Introduction

HZ25D mainly used in the electrical circuit for the power switch and control of motor, also for change over of electrical circuits.

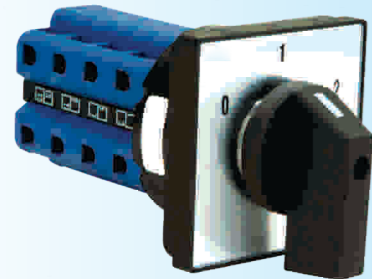
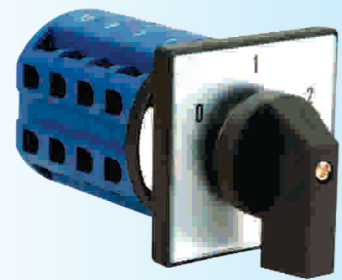
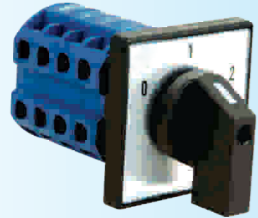

Technical parameters

Description		HZ25D-10	HZ25D-20	HZ25D-40
Rated working voltage U_e	V	440	440	440
Rated thermal current I_{th}	A	10	20	40
Rated working current I_e	A	4	8	16
Power P	kW	1.7	4	7.5

Mechanical life

Mechanical life without load: 0.1×10^6 times, operation frequency is 120 times/h

Mechanical life with load: AC-23A: 0.03×10^6 times operation frequency is 120 times/h
AC-3: 0.03×10^6 times operation frequency is 120 times/h
AC-4: 0.03×10^6 times operation frequency is 120 times/h

Dimensions and installation

HZ25D-10

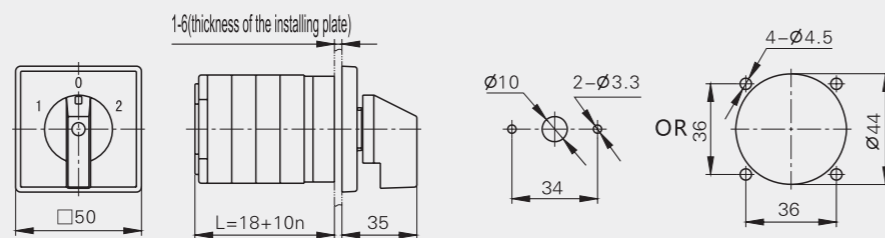

HZ25D-20

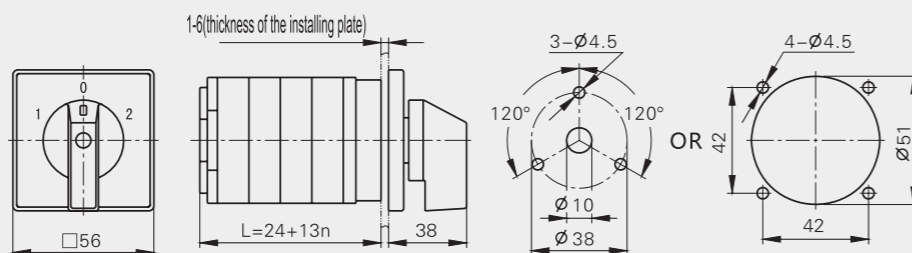

HZ25D Combination Switch

Dimensions and installation

HZ25D-40

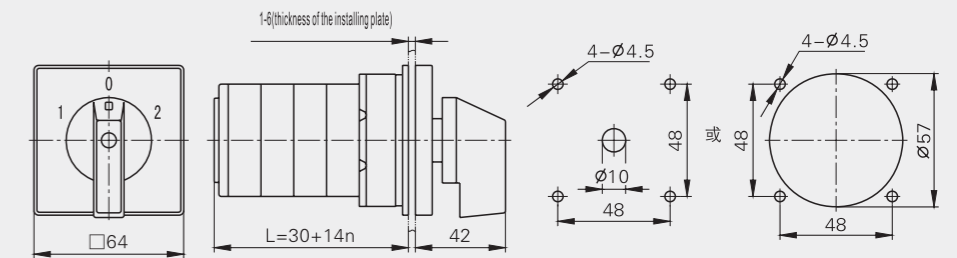

HZ25D-20GSA

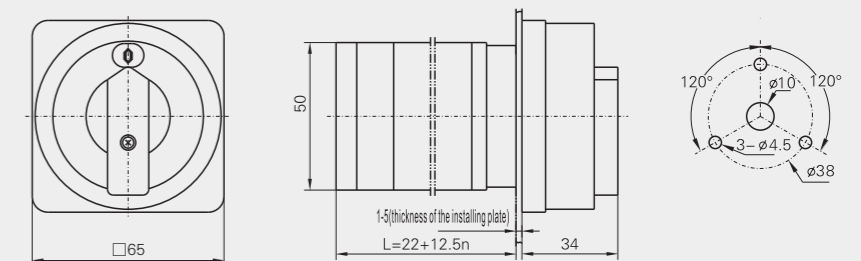

HZ25D-20GSB

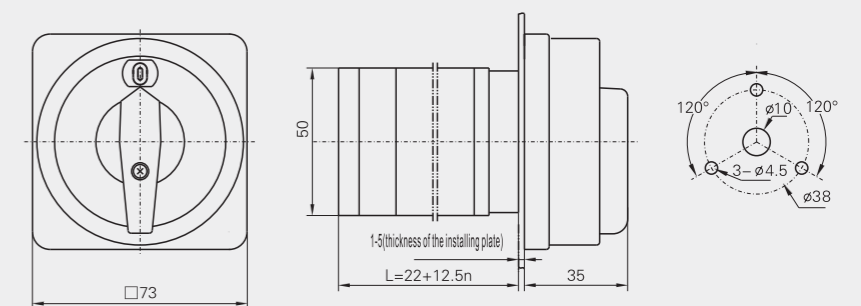

Re: n for number of layers.

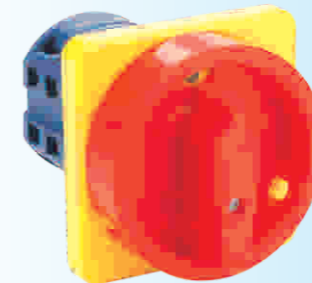

Flame-proof switch

Designation

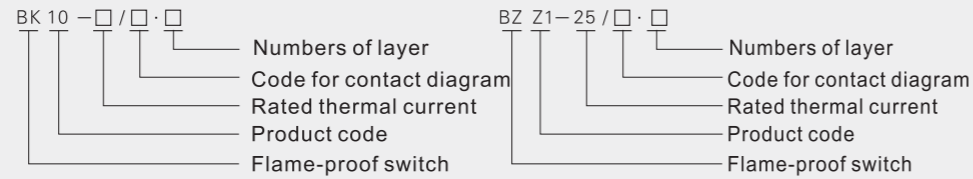

Technical parameters

Description	BK10-10/1	BK10-10/2	BZZ1-25
Rated thermal current I _{th} A	10	16	25
Rated working voltage U _e V	220 380	220 380	220 380
Rated working current I _e			
AC-15 A	6 10	16 10	25 15
DC-13 A	0.8	1.2	2

Dimensions and installation

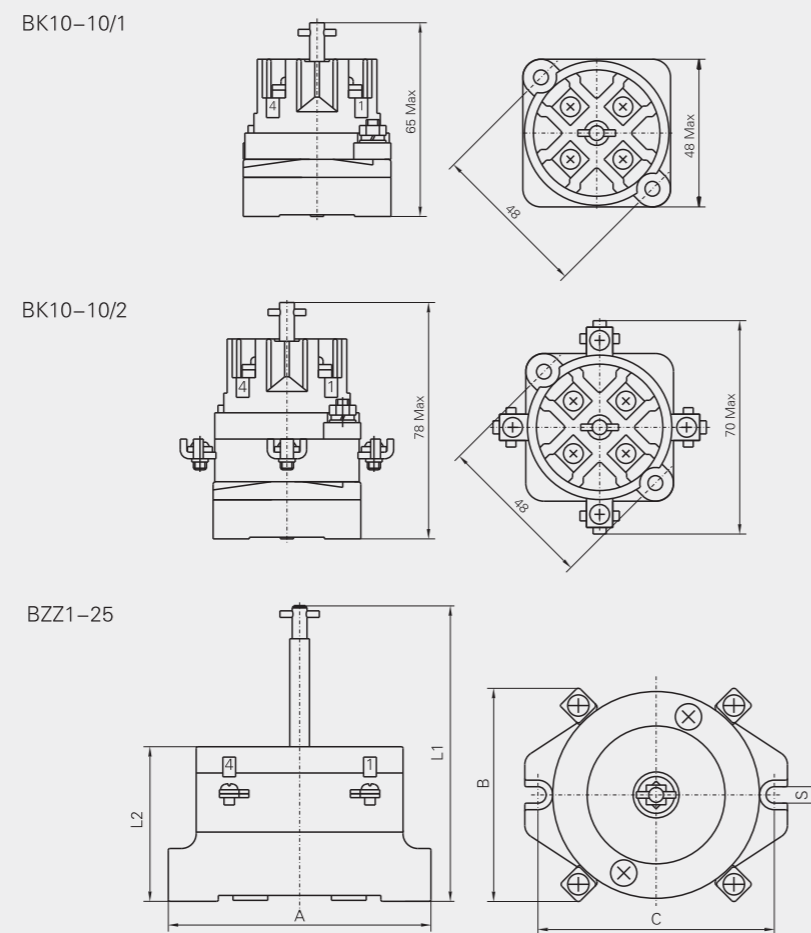

Description	A	B	C	L1	L2	S
BZZ1-25/1	80	65	72	91	48	5
BZZ1-25/2	80	79	72	109	66	5
BZZ1-25/3	80	79	72	127	84	5

Flame-proof switch

Description of product code

